

**Final**

**NORTH PLANT AREA REMOVAL  
AND CLOSURE REPORT  
BUILDING 67 AND METAL CHIP BIN AREAS  
FORMER YORK NAVAL ORDNANCE PLANT**

**SAIC Project 4501020014**

**Prepared for:**

**Harley-Davidson  
Motor Company Operations, Inc.  
York Vehicle Operations  
1425 Eden Road  
York, PA 17402**

**March 2010**



Final

North Plant Area Removal and Closure Report  
Building 67 and Metal Chip Bin Areas  
Former York Naval Ordnance Plant

SAIC Project 4501020014

Prepared for:

Harley-Davidson Motor Company Operations, Inc.  
York Vehicle Operations  
1425 Eden Road  
York, PA 17402

By:

SAIC Energy, Environment & Infrastructure, LLC  
6310 Allentown Boulevard  
Harrisburg, PA 17112  
(717) 901-8100

March 2010

Reviewed by:



---

Rodney G. Myers  
Project Manager

Respectfully submitted,



---

Emily M. Wade  
Environmental Staff Scientist

# TABLE OF CONTENTS

	<i>Page</i>
<b>LIST OF ACRONYMS .....</b>	<b>Preceding Text</b>
<b>1.0 INTRODUCTION AND BACKGROUND .....</b>	<b>1</b>
Building 67 Container Storage Area (SWMUs 23 – 25).....	1
Metal Chip Bin Area .....	2
<b>2.0 FACILITY REMOVALS AND SOIL EXCAVATION.....</b>	<b>4</b>
Building 67 Container Storage Area .....	4
Metal Chip Bin Area .....	5
<b>3.0 CONFIRMATION SOIL SAMPLING AND ANALYSIS .....</b>	<b>7</b>
Building 67 Container Storage Area .....	7
Metal Chip Bin Area .....	7
<b>4.0 SUMMARY AND CONCLUSIONS.....</b>	<b>8</b>
Building 67 Container Storage Area .....	8
Metal Chip Bin Area .....	8
<b>5.0 REFERENCES.....</b>	<b>9</b>

## LIST OF FIGURES

Figure 1, Site Location Map .....	Following Text
Figure 2, North Plant Area Soil Samples.....	Following Text
Figure 3, MCB Area Removal - Confirmation Soil Samples .....	Following Text

## LIST OF TABLES

Table 1, Soils Data Summary – Building 67 Area Soil Borings .....	Following Text
Table 2, Soils Data Summary – Metal Chip Bin Area Soil Borings .....	Following Text
Table 3, Waste Shipment and Disposal Summary – Metal Chip Bin Area ... ..	Following Text
Table 4, Soils Data Summary – Metal Chip Bin Area Confirmation Sampling ....	Following Text

## LIST OF APPENDICES

Appendix A, Monitoring Well MW-52 and MW-53 Abandonment Records .....	Following Text
Appendix B, Demolition and Soil Removal Photographs .....	Following Text
Appendix C, Waste Disposal Manifests .....	Following Text

## LIST OF ACRONYMS

AOCs	- areas of concern
bgs	- below ground surface
cis-1,2-DCE	- cis-1,2-dichloroethene
DCNR	- Pennsylvania Department of Conservation and Natural Resources
EPA	- United States Environmental Protection Agency
Harley-Davidson	- Harley-Davidson Motor Company Operations, Inc.
mg/kg	- milligrams per kilogram
MCB	- Metal Chip Bin
MEK	- methyl ethyl ketone
MSCs	- medium-specific concentrations
NPA	- North Plant Area
OVA	- organic vapor analyzer
PADEP	- Pennsylvania Department of Environmental Protection
PADER	- Pennsylvania Department of Environmental Resources
PAHs	- polycyclic aromatic hydrocarbons
PCBs	- polychlorinated biphenyls
PCE	- tetrachloroethene
PID	- photoionization detector
ppm	- parts per million
QAPP	- Quality Assurance Project Plan
RCRA	- Resource Conservation and Recovery Act
REWAI	- R.E. Wright Associates, Inc.
REWEI	- R. E. Wright Environmental, Inc.
RFA	- RCRA Facility Assessment
RI	- Remedial Investigation
RSL	- regional screening level
SAIC	- SAIC Energy, Environment & Infrastructure, LLC
SVOC	- semi-volatile organic compound
SWMU	- Solid waste management unit
TCA	- 1,1,1-trichloroethane
TCE	- trichloroethene
TPH	- total petroleum hydrocarbons
TSCA	- Toxic Substances Control Act
µg/kg	- micrograms per kilogram
VOC	- volatile organic compound
yd <sup>3</sup>	- cubic yard

## **1.0 INTRODUCTION AND BACKGROUND**

This report describes the building demolition, soil removal, and closure of a portion of the North Plant Area (NPA) as part of the Harley-Davidson Motor Company Operations, Inc. (Harley-Davidson) plant restructuring activities. The York Campus Restructuring Project includes demolition at selected sites, expansion of the Softail plant (Building 3), and various improvements, including a new stormwater basin in the NPA and reworked roadways and parking areas. SAIC Energy, Environment & Infrastructure, LLC (SAIC) was contracted by Harley-Davidson to conduct environmental monitoring, inspection, and sampling when suspect conditions arise or are identified during excavation or as a result of demolition or construction work associated with the York restructuring project.

A general site location map is shown on Figure 1. Figure 2 illustrates a portion of the NPA, including Building 12, 43, 44, and 67 (along with an active waste storage area shed) that were removed to prepare this area for a large stormwater detention basin. Sampling and limited soil removal were conducted as a part of the environmental inspection activities that were approved during construction. The closure activities were conducted in accordance with Pennsylvania Department of Environmental Protection (PADEP) Act 2 requirements.

In 1989, the United States Environmental Protection Agency (EPA) performed a Resource Conservation and Recovery Act (RCRA) Facility Assessment (RFA) of the Harley-Davidson facility (A. T. Kearney, 1989). As a result of this assessment, 73 Solid Waste Management Units (SWMUs) were identified as areas of concern (AOCs) needing further investigation. Several of these SWMUs were identified in the NPA and within Building 67.

### **Building 67 Container Storage Area (SWMUs 23 – 25)**

Building 67 was located 200 to 300 feet east of Building 51, in the northern portion of the plant (see Figure 2). This facility was built in 1981. The Building 67 Container Storage Area (SWMU 23) was an interim storage facility, measuring 800 square feet, with a dedicated container storage area (368 square feet) under roof (no sides), and surrounded by a 3-foot-high block wall dike. The concrete floor of the Container Storage Area was sloped toward a sump (SWMU 24) in the southeast corner for spill/leak control. The sump measured approximately 4 feet wide by 4 feet long by 4 feet deep, had no outlet or pump, and was covered by a metal grate. Transfer operations occurred at an adjacent asphalt pad (150 feet by 75 feet) with containment curbing along one side, called the Container Storage Off-Loading Area (SWMU 25). The Container Storage Area was closed under RCRA requirements in 1992 (R. E. Wright Associates, Inc. [REWAI], 1992). This closure was based on several borings conducted around Building 67 in 1991 (see Figure 2). The hazardous waste storage facility (Building 67) is not currently a RCRA facility and is not subject to RCRA closure requirements.

According to the Kearney report (1989), the Container Storage Area was used to store drums containing various wastes, including cyanide sludge, nickel sludge, paint sludge, 1,1,1-trichloroethane (TCA), and other waste solvents. Pennsylvania Department of Environmental Resources (PADER) inspection reports noted historical releases from leaking drums resulting in residue on the floor. In the western portion of the storage area, a

20-foot-by-6-foot area was partitioned off by a 3-foot-high concrete block wall for temporary storage of defective polychlorinated biphenyl (PCB) transformers and capacitors. Waste oil and grease had also been reportedly stored within two metal containers in this temporary storage area.

In 1990, as part of the RCRA closure investigation, REWAI performed a soil gas investigation within the area on 50-foot centers. The results of the soil gas study were used to lead the selection and completion of five soil borings during 1991 (SB-1 through SB-5). The locations of these borings are also shown on Figure 2. Soil samples were collected from each of the borings. Trichloroethene (TCE) was detected at SB-2 (0- to 2-foot interval). Subsequently, REWAI excavated soil from the area of impact at location SB-2 (east end of Building 67 storage area) to a depth of 2.5 feet and disposed of the soil off-site. Two confirmatory soil samples (S-1 and S-2) were collected from the bottom of this excavation. Neither of those samples contained detectable concentrations of volatile organic compounds (VOCs). Subsequently, a closure document for the Drum Storage Area was signed, and the closure letter and certification were mailed to Thomas Hanlon of PADER on July 24, 1992.

Site-wide Remedial Investigation (RI) sampling in 1998 and 1999 [Langan, July 2002] from throughout the North Plant Area included passive soil gas sampling, followed by soil sampling from three locations in the Building 67 area. These sample locations are shown on Figure 2. Except for arsenic (up to 19 milligrams per kilogram [mg/kg]), the RI soil samples did not contain any substances above EPA or PADEP soil screening criteria. Tetrachloroethene (PCE), TCE, and TCA were not detected in any of the North Plant RI soil samples.

SAIC inspected the Container Storage Area and sump on January 11, 2006. There was no evidence of a release from the Container Storage Area. The containment walls were intact, and the floor was painted with gray epoxy and sloped to the sump. The sump was constructed of concrete and was holding approximately 32 inches of water at the time of the inspection. The fact that the sump was holding water suggests that no releases had occurred from this unit. Harley-Davidson routinely removes and disposes of the water in this pit as part of its hazardous waste maintenance operations.

### **Metal Chip Bin Area**

The Metal Chip Bin (MCB) area was located in the NPA of the Harley-Davidson plant, just east of Buildings 43 and 44, as shown in Figure 2. According to the RFA (Kearney, January 1989), the MCBs were concrete structures used historically to dump metal chips and shavings from various machining operations at the plant. Metal chips would remain in the bin, while cutting fluids and oils drained to one end of the structure and flowed through a pipe to an underground tank on the east end of the bins. Periodically, chips were removed from the bins and placed in railcars for transport off-site. The MCBs were used until approximately 1971. The underground tank was reportedly removed by Harley-Davidson. The tracks were no longer used and were paved over.

A subsurface soil investigation was performed at the MCB area in 1991 (R. E. Wright Environmental, Inc. [REWEI], 1993). The investigation included eight soil borings with

continuous split-spoon samples, a test trench, and a test pit. The borings and excavations were located to the north of the chip bins in the area of the railroad loading tracks. The soils were field-screened using a combination of a field total petroleum hydrocarbon (TPH) analyzer and an organic vapor analyzer (OVA). Laboratory analytical sample intervals were selected based on the field screening results. Samples for laboratory analysis were collected from soil borings. The soil sample results indicated elevated concentrations of TPH in several samples, and one sample (test pit bottom) contained PCE at 42 micrograms per kilogram ( $\mu\text{g}/\text{kg}$ ). None of the respective PADEP soil-to-groundwater or direct contact medium-specific concentrations (MSCs) were exceeded in any of these samples. The 1993 REWEI report concluded that the source of the TPH was the underground cutting oil tank.

Soil samples from five soil borings (MCB-B1 through MCB-B5) and five concrete chip samples (MCB-C1 through MCB-C5) were collected around the MCBs during the site-wide RI (Langan, July 2002). These soil boring locations are also shown on Figure 2. Two soil samples per boring and five concrete chip samples were analyzed for PCBs. PCBs (Arochlors 1254 and 1260) were detected in concrete chip samples MCB-C4, MCB-C4 Dup, and MCB-C5.

## **2.0 FACILITY REMOVALS AND SOIL EXCAVATION**

In anticipation of the planned demolition activities and installation of the new stormwater detention basin in the north plant area, two on-site wells, MW-52 and MW-53 (see Figure 2) were abandoned by SAIC and Eichelberger's (drilling contractor) on May 14, 2010. The well abandonment completion reports were issued to the Pennsylvania Department of Conservation and Natural Resources (DCNR) on June 16, 2010. A copy of the well abandonment forms is provided in Appendix A.

Site demolition activities by Harley-Davidson began during June 2010 in the vicinities of Buildings 12, 43, 44, 45, 50, and 67 and were completed in July. Photographs of the demolition and removal activities are provided in Appendix B. Due to suspect conditions observed and/or previous environmental impacts, sampling and analysis were conducted prior to and during the Building 67 and MCB area removals. Following demolition, a series of eight borings and soil samples was collected from beneath the former hazardous waste storage facility (Building 67) using direct-push macro-core sampling techniques utilizing a Geoprobe<sup>®</sup> (see Figure 2). Four borings and soil samples were collected from the MCB area, following removal of a former railroad bed in the vicinity of Building 12 (see Figure 2).

### **Building 67 Container Storage Area**

Prior to demolition, Harley-Davidson vacated the Building 67 container storage area, emptied the sump, and properly disposed of all wastes/drums off-site. The soils beneath the building were inspected and scanned using a photoionization detector (PID) following demolition and removal of the concrete floor and sump. Photographs of the former Building 67 area following demolition are provided in Appendix B.

Due to active use of this facility since closure sampling was conducted in 1991, it was decided that several borings would be appropriate to document the environmental conditions beneath this structure following its final use and removal. SAIC installed eight soil borings (identified as NPA-SB-007 through SB-014) within the footprint of former Building 67 using a Geoprobe<sup>®</sup> on July 16, 2010 (see Figure 2). Each of the soil borings was planned to be advanced to approximately four feet deep, unless unusual staining or suspect conditions were evident. In addition, two borings were advanced to a total depth of eight feet at the former sump of this facility to allow collection of a soil sample at or below the bottom of this former structure. One soil sample was collected from each Geoprobe<sup>®</sup> boring location. The exact sampling depth was selected based on field observations including evidence of soil stains, odors, or PID readings.

None of the soil borings exhibited any elevated PID readings above background, and no staining or unusual odors were observed in any of the borings from this former facility. Soil samples were collected at a depth of 3 to 4 feet below ground surface (bgs) in each of the building footprint locations and at a depth of 5 to 6 feet bgs at the former sump location. None of the borings were advanced beyond the targeted depth range.

Each of the soil samples from the Building 67 area was submitted to TestAmerica Laboratories, Inc. (TestAmerica) in Pittsburgh, Pennsylvania, for the following analyses:



- VOCs (Method 8260) using Encore samplers
- Total Metals (Quality Assurance Project Plan [QAPP] list) (Methods 6010 and 7410)

The results of the soil sampling are shown on Table 1. The analytical results from these soil samples are summarized and compared to PADEP nonresidential MSCs and the EPA regional screening level (RSL) for industrial soils. None of the soil samples collected from beneath the building footprint contained any detectable VOCs. Both borings from the former sump area (NPA-SB-013 and -014) contained detectable levels of TCE; boring SB-013 also contained detectable concentrations of cis-1,2-dichloroethene (cis-1,2-DCE), methylene chloride, and 2-butanone or methyl ethyl ketone (MEK). Several metals were also detected in these soil samples; however, none of these detected compounds were above any Act 2 MSCs. Although arsenic was found in concentrations above the industrial soil RSL, it is considered within typical background levels for this site. Therefore, no additional soil removal was conducted for this facility prior to construction of the (above-grade) sedimentation basin.

### **Metal Chip Bin Area**

Following demolition of the concrete bins and former MCB structure, the demolition contractor removed the asphalt, former railroad ties, and steel rails from the vicinity of the MCB and former Building 44 areas. During some of the site demolition and preparation work, an unusual odor was noted by the excavation contractor, which appeared to emanate from dark/discolored soil beneath the former railroad bed in the vicinity of the MCB. On July 16, 2010, SAIC installed four soil borings (identified as NPA-SB-015 through SB-018) using a Geoprobe<sup>®</sup> along the former railroad spur, in front of the MCB area (see Figure 2). Each of the soil borings was advanced to approximately four feet deep, unless unusual staining or suspect conditions were evident at the bottom of the boring. One soil sample was collected from each Geoprobe<sup>®</sup> boring location. The exact sampling depth was selected based on field observations including evidence of soil stains, odors, or PID readings.

Each of the soil borings encountered shallow zones of black, oily, and odorous material with elevated PID readings ranging from 24 to 223 parts per million (ppm) above background. The depths of the stained suspect material ranged from near surface at boring SB-018 to approximately 3.5 feet bgs at borings SB-015 and SB-016. Soil samples were collected from the depths of maximum PID reading or staining. None of the borings were advanced beyond the targeted maximum depth of four feet, since the staining and elevated PID readings were not evident.

Each of the soil samples from the MCB railroad bed was submitted to TestAmerica for the following analyses:

- VOCs (Method 8260) using Encore samplers
- Semi-Volatile Organic Compounds (SVOCs) (Method 8270)
- Total Metals (QAPP list) (Methods 6010 and 7410)
- Total PCBs (Method 8082)

The results of the soil sampling are shown on Table 2. Several petroleum-related VOCs (toluene, ethylbenzene, and xylenes) were detected in borings NPA-SB-016, -017 and -018 (but not above any MSCs). The soil sample collected at SB-015 did not contain any detectable VOCs. Numerous SVOCs were detected in the soil at each of these borings. The predominant detected compounds were polycyclic aromatic hydrocarbons (PAHs), consisting of acenaphthylene, acenaphthylene, anthracene, benzo(a)pyrene, benzo(a)anthracene, benzo(b)fluoranthene, chrysene, fluoranthene, fluorene naphthalene, phenanthrene, and pyrene. None of the detected VOCs or SVOCs exceeded any of the PADEP MSCs. Arochlor 1260 was also detected in each of the soil samples from the MCB area borings, but not above PADEP MSCs or the Toxic Substances Control Act (TSCA) threshold of 50 mg/kg. Several metals were also detected in each of the soil samples; however, none of these detected compounds were above any Act 2 MSCs. Although arsenic was found in concentrations above the industrial soil RSL in three of these samples, it is considered within typical background levels for this site. Due to the presence of waste-like oily product in the soils, elevated PID readings, and odor, it was decided that the soils with waste-like product would be characterized, processed for removal, and disposal of off-site. Disposal documentation for the contaminated soil is included in Appendix C.

Liberty Excavators, Inc., was subcontracted by Harley-Davidson to provide the equipment and labor to remove the impacted soil. Roll-off containers and lined dump trailers were delivered from Envirite of Pennsylvania, Inc. (Envirite) for containing the impacted soil. Waste processing was conducted to confirm disposal as nonhazardous residual waste into Modern Landfill, a Republic Services, Inc., facility located near York. Approximately 1,200 gallons of liquid (perched water, rainfall run-in, and oil) were removed from the excavation areas during the soil removal process. This liquid was also sampled and confirmed to be treatable via the on-site wastewater treatment facility. Waste characterization documentation (data summaries) for both the soil and liquid is provided in Appendix C.

The soil that did not display visual evidence of contamination was placed into triaxle dump trucks and placed in a stockpile at another location on-site until waste characterization was completed. Soil that displayed visual evidence of contamination was placed in an Envirite roll-off container and was also staged on-site until waste characterization was completed. Ten Envirite roll-off containers and semi-dump trailers were used to contain and remove contaminated material off-site. Disposal manifests for the excavated soils are provided in Appendix C. A list of the off-site waste shipments is provided in Table 3. A total of approximately 650 tons of soil were removed from the MCB area. Photographs of the removal area and excavation area are provided in Appendix B.

Sections of railroad bed toward the west (beneath former Building 44) were also inspected using several test pits (see photographs in Appendix B). None of these soils contained oily waste or exhibited elevated PID readings; therefore, this material was not removed.

### **3.0 CONFIRMATION SOIL SAMPLING AND ANALYSIS**

#### **Building 67 Container Storage Area**

No further soil sampling or removals were conducted in the Building 67 Container Storage area. The new stormwater basin was constructed above this area.

#### **Metal Chip Bin Area**

Following removal of all visually and elevated PID impacted soil, 12 confirmation soil samples (identified as NPA-CS-001 through -012) were collected from the bottom and sidewalls of the excavation limits and are shown on Table 4. Each sample location and the limit of excavation are shown on Figure 3.

All soil samples were screened in the field for the presence of VOCs using a PID. Samples intended for laboratory analysis were placed into laboratory-supplied glassware immediately following field screening procedures. The samples were kept on ice in preparation for shipment to the analytical laboratory.

The laboratory soil samples were submitted to TestAmerica for analysis of total VOCs, SVOCs, total metals, hexavalent chromium, total cyanide, PCBs, and TPH.

The analytical results from these soil samples are summarized and compared to PADEP nonresidential MSCs and the EPA RSL for industrial soils in Table 4. Various metals were detected at concentrations that are typical for soils. None of the compounds analyzed were detected at a concentration greater than the PADEP MSCs. Although arsenic was found in concentrations above the industrial soil RSL, it is considered within typical background levels for this site. Total cyanide was detected in only one sample (NPA-CS-001 at 1.2 mg/kg) but well below any MSCs. Only two VOCs (acetone and methylene chloride) were detected in any of the confirmation samples. These compounds were detected at very low concentrations and may have been an artifact of laboratory contamination. Five of the confirmation samples (NPA-CS-001, -003, -006, -008, and -012) contained detectable concentrations of petroleum hydrocarbons. These samples ranged in concentration from 422 to 5,150 mg/kg. Numerous SVOCs were detected in several of the confirmation samples (NPA-CS-001, -004, -006, -008, -009, and -012) and generally correlated with the presence of petroleum hydrocarbons. The predominant detected SVOC compounds were PAHs, consisting of acenaphthene, acenaphthylene, anthracene, benzo(a)pyrene, benzo(a)anthracene, benzo(b)fluoranthene, chrysene, fluoranthene, fluorene naphthalene, phenanthrene, and pyrene. Only two samples (NPA-CS-001 and -012) contained detectable SVOCs above the EPA RSL. These compounds consisted of benzo(a)anthracene and benzo(a)pyrene. However, none of the detected SVOCs in any of the samples exceeded any of the PADEP MSCs. Arochlors 1254 and/or 1260 were also detected in four of the confirmation soil samples from the MCB excavation area (NPA-CS-001, -006, -008, and -012); however, none of these detected compounds were above any Act 2 MSCs or the TSCA threshold of 50 mg/kg total PCBs.

## **4.0 SUMMARY AND CONCLUSIONS**

### **Building 67 Container Storage Area**

The results of the post-demolition soil sampling and inspections confirm that there were no releases from the former Building 67 Container Storage area since its closure in 1992. There were no stains or odors observed during or following demolition, and none of the soil samples collected from beneath this former facility contained potential constituents of concern at concentrations above PADEP Act 2 MSCs.

### **Metal Chip Bin Area**

Following demolition and prior to construction of a new basin, soil samples were collected from beneath the former MCB area. Approximately 650 tons of contaminated soil from the MCB area were loaded and shipped off-site for disposal at Modern Landfill, following characterization. Approximately 1,200 gallons of oily water were also removed during excavation activities in the MCB area and were treated through the on-site wastewater treatment facility. Confirmation soil samples collected at the bottom of the excavation area were found to be below PADEP Act 2 MSCs. A 300 cubic yard (yd<sup>3</sup>) suspect soil stockpile, generated during the excavation activities in the MCB area, was also characterized and confirmed safe for reuse on-site.

Based on the analytical results for the soil samples, no further soil excavation was deemed necessary, and the excavation was backfilled to complete for the construction of a new stormwater detention basin. Harley-Davidson personnel were tasked with the responsibility of reseeded the area as part of the restructuring activities.

## 5.0 REFERENCES

Harley-Davidson. Historical Spill and Incident Report.

Kearney, A. T., 1989. Phase II RCRA Facility Assessment of the Harley-Davidson York, Inc. Facility, York, Pennsylvania, EPA ID No. PAD 001 643 691, EPA Contract No. 68-01-7038, January.

Langan, 2002. Interim Site-wide Remedial Investigation Report, Harley-Davidson Motor Company, York, Pennsylvania, Facility, July (Draft).

R. E. Wright Associates, Inc. (REWAI), 1992. Drum Storage Area Closure, July 24 letter to PADER.

REWAI, 1993. Draft Report of Investigations in the Metal Chip Bin Storage Area, January.

SAIC, 2009a. Quality Assurance Project Plan for Environmental Investigations at the Former York Naval Ordnance Plant, December.

SAIC, 2009b. Supplemental Remedial Investigations Soils Report, Former York Naval Ordnance Plant, December.

# FIGURES



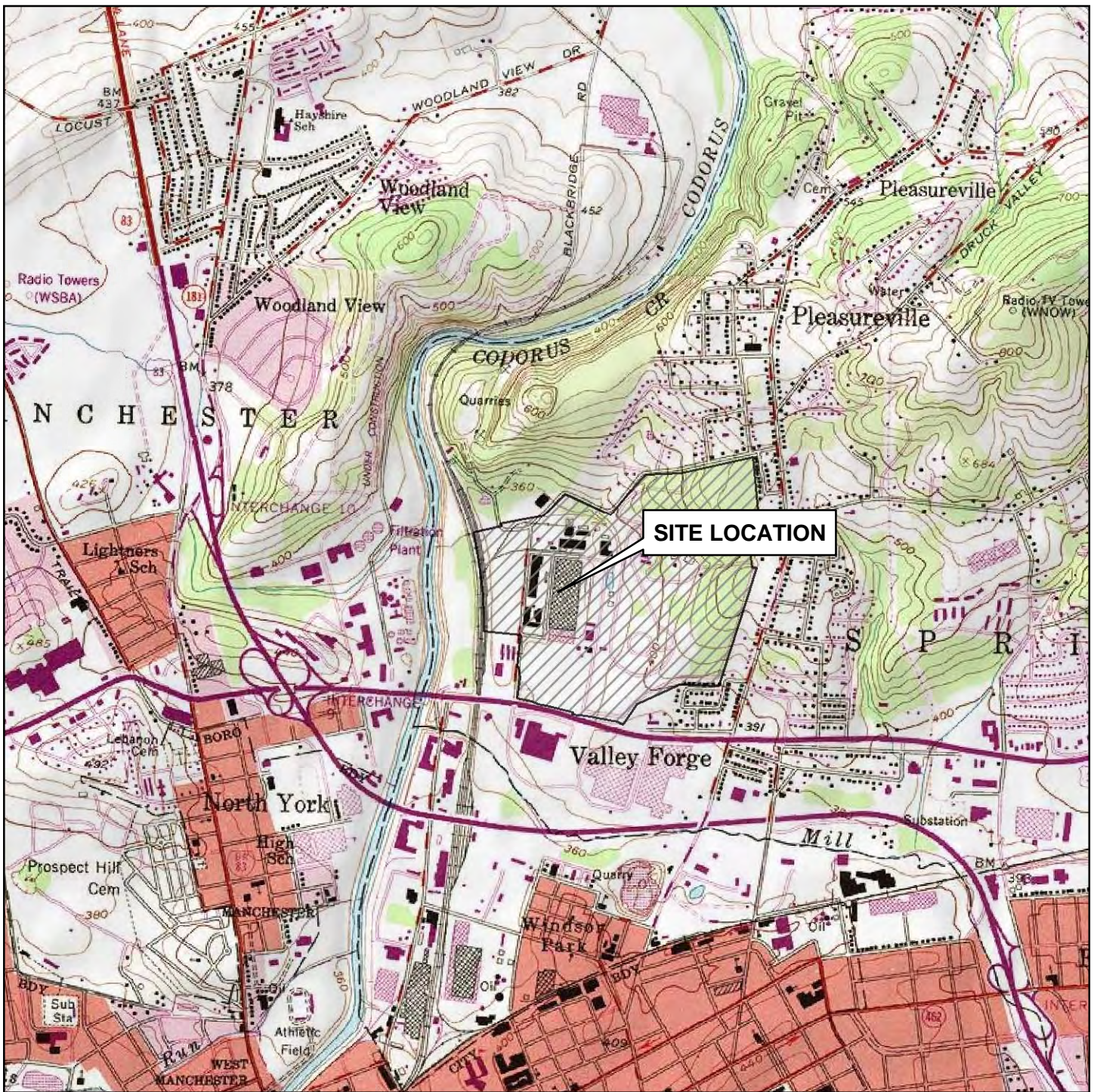

NOTE: Map based on USGS 7.5 minute series York quadrangle.

0 1,000 2,000 4,000



1 inch = 2,000 feet

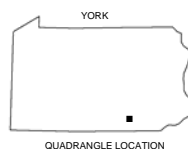

**FORMER YORK NAVAL ORDNANCE PLANT**  
1425 EDEN ROAD, YORK, PA 17402

**SITE LOCATION MAP**

drawn AGM	checked TDE	approved SMS	figure no. <b>1</b>
date 10/20/08	date 8/26/09	date 8/26/09	
job no. 01-1633-00-9806-309		file no. Fig1-1site-loc.mxd	
initials	date	revision	





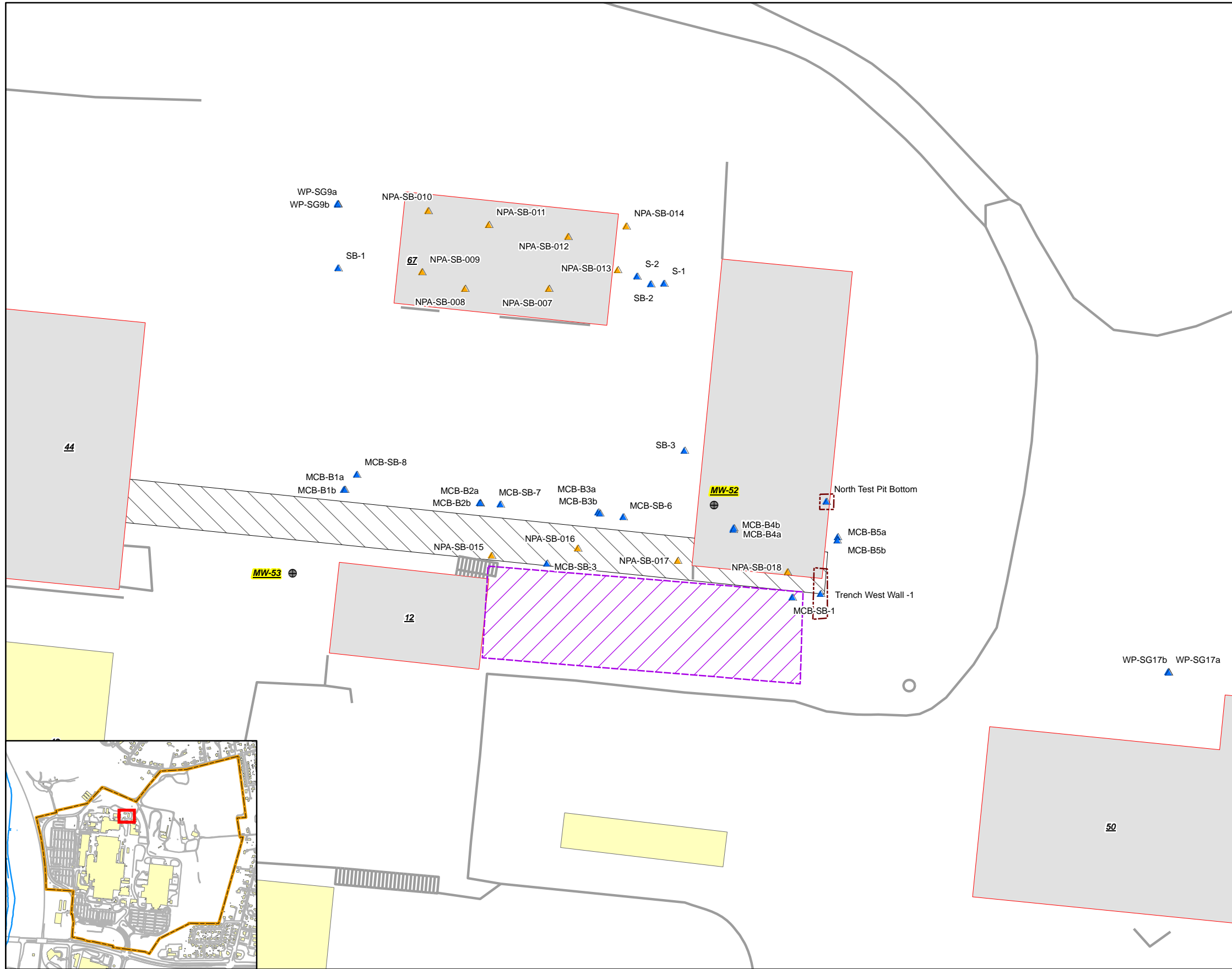

- Legend**
- ▲ Soil Samples Collected Current Investigation (July/August 2010)
  - ▲ Soil Samples Collected In Prior Investigation
  - Exceeds Direct Contact and Soil to Groundwater MSC
  - Results > or = Direct Contact MSC (0-2' and 2'-15')
  - Results > or = Soil to Groundwater MSC
  - ⊕ Abandoned Wells
  - ⊕ Active Wells
  - Roads and Curb Boundary (2006)
  - Parking (2006)
  - ▨ Former Metal Chip Bin Boundary
  - - - Metal Chip Bin Test Pit/Trench
  - Current Building
  - Former Building
  - ▨ Former Railroad Spur

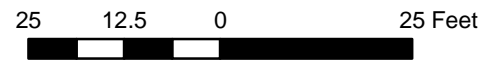
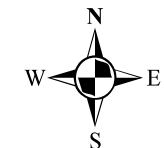

1 inch = 25 feet

**FORMER YORK NAVAL ORDNANCE PLANT**  
1425 EDEN ROAD, YORK, PA 17402

**North Plant Area Soil Samples**

drawn	AGM	checked		approved		figure no.
date	12/30/2010	date		date		<b>2</b>
job no.	4501020014/1000/100	file no.	Fig_2_Pre_exc.mxd			
initials		date		revision		





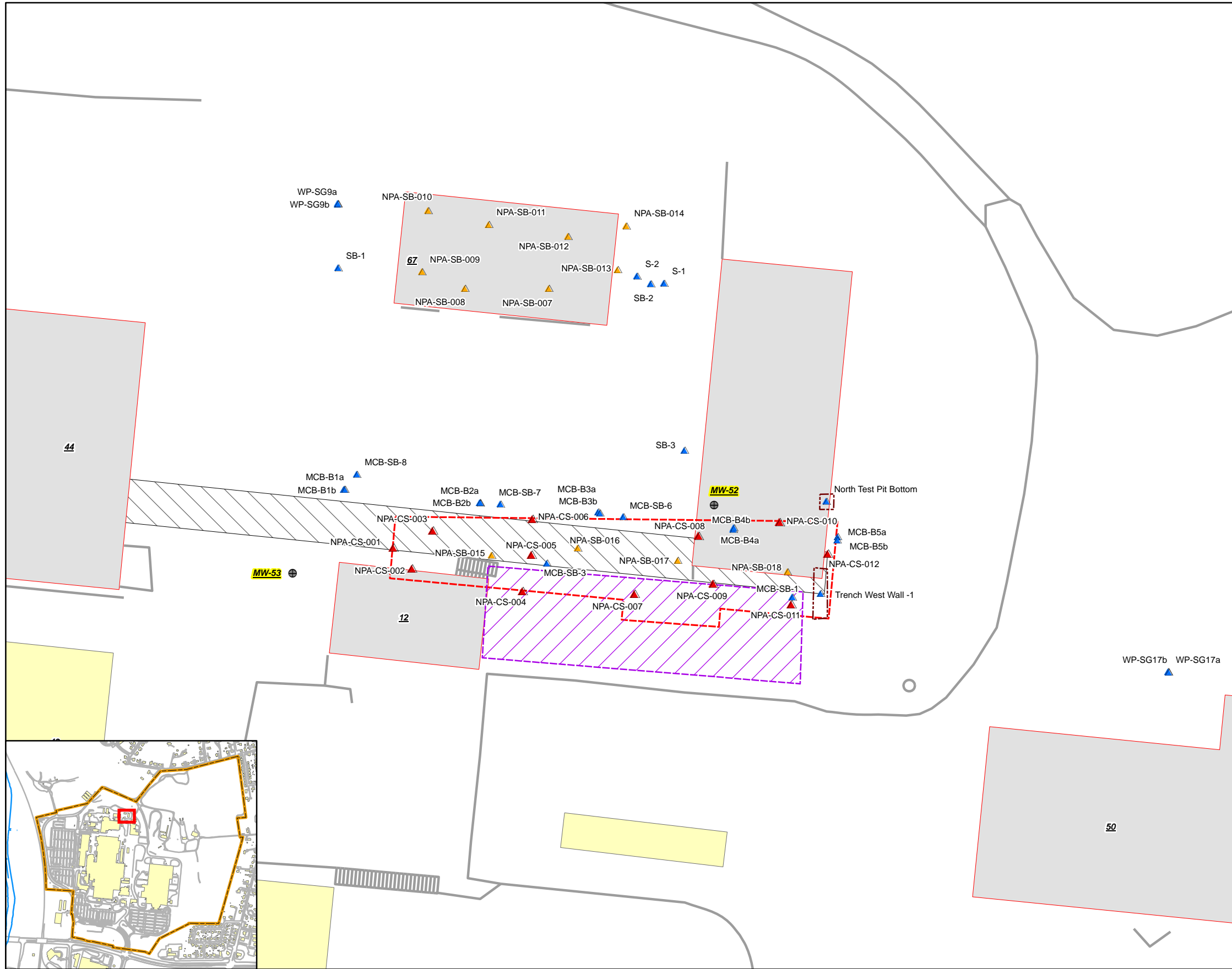

- Legend**
- ▲ Confirmation Soil Samples Collected Current Investigation (August 2010)
  - ▲ Soil Samples Collected Current Investigation (July/August 2010)
  - ▲ Soil Samples Collected In Prior Investigations
  - Exceeds Direct Contact and Soil to Groundwater MSC
  - Results > or = Direct Contact MSC (0-2' and 2'-15')
  - Results > or = Soil to Groundwater MSC
  - ⊕ Abandoned Wells
  - ⊕ Active Wells
  - ▭ Excavation Area
  - ▭ Roads and Curb Boundary (2006)
  - ▭ Parking (2006)
  - ▭ Former Metal Chip Bin Boundary
  - ▭ Metal Chip Bin Test Pit/Trench
  - ▭ Current Building
  - ▭ Former Building
  - ▭ Former Railroad Spur

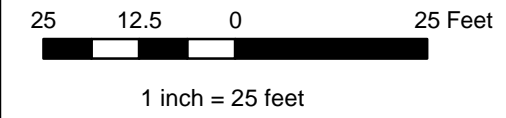
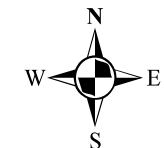

<b>FORMER YORK NAVAL ORDNANCE PLANT</b>			
1425 EDEN ROAD, YORK, PA 17402			
<b>MCB Area Removal</b>			
<b>Confirmation Soil Samples</b>			
drawn AGM	checked	approved	figure no.
date 12/30/2010	date	date	<b>3</b>
job no. 4501020014/1000/100	file no. Fig_3_Post_exc.mxd		
initials	date	revision	



# **TABLES**

**Table 1.**  
**Soils Data Summary - Building 67 Area Soil Borings**  
**Former York Naval Ordnance Plant - York, PA**

Location/ID Depth (ft.) Sample Date	MSC Soil to GW Used Aquifer (mg/kg)	MSC Direct Contact 0 - 2 ft (mg/kg)	MSC Direct Contact 2 - 15 ft (mg/kg)	EPA RSL Industrial Soil (mg/kg)	NPA-SB-007 3 - 4 7/16/2010	NPA-SB-008 3 - 4 7/16/2010	NPA-SB-009 3 - 4 7/16/2010	NPA-SB-010 3 - 4 7/16/2010	NPA-SB-011 3 - 4 7/16/2010	NPA-SB-012 3 - 4 7/16/2010	NPA-SB-013 5 - 6 7/16/2010	NPA-SB-014 5 - 6 7/16/2010
<b>Mercury</b>												
Mercury	10	840	190000	24	0.1	0.026 B	0.022 B	0.031 B	0.04	0.039 U	0.042 B	0.021 B
<b>Metal</b>												
Antimony	27	1100	190000	410	0.076 B	0.089 B	0.54	0.14 B	0.084 B	0.038 B	0.085 B	0.05 B
Arsenic	150	53	190000	1.6	11.3	6.4	4.7	5.9	1.2	0.4	3.5	5.6
Barium	8200	190000	190000	190000	31.2	37	10.2	62.9	25.8	39.6	58.3	37.6
Beryllium	320	5600	190000	2000	0.54	0.46	0.6	0.38	0.39	0.22	0.58	0.57
Cadmium	38	210	190000	800	0.076 B	0.07 B	0.28	0.066 B	0.048 B	0.038 B	0.15	0.13
Chromium				1400	12.2 J	9.1 J	18.6 J	23.9 J	12.4 J	5.9 J	12.3 J	10.4 J
Copper	36000	100000	190000	41000	3.1	3.4	14.7	8.5	5.4	2.3	4.3	4.4
Lead	450	1000	190000	800	11.2	10.2	11.7	12	68	10.1	15.4	12.8
Nickel	650	56000	190000	20000	2.6	4.8	15.1	11.8	1.8	1.3	19.7	4.4
Selenium	26	14000	190000	5100	0.45 B J	0.42 B J	0.34 B J	0.37 B J	0.29 B J	0.25 B J	0.58 B J	0.56 B J
Silver	84	14000	190000	5100	0.021 B	0.02 B	0.034 B	0.016 B	0.013 B	0.012 B	0.028 B	0.021 B
Thallium	14	200	190000	66	0.19	0.22	0.072 B	0.18	0.12	0.14	0.28	0.16
Vanadium	72000	20000	190000	7200	16.7 J	17.1 J	31 J	22.2 J	20.8 J	14.2 J	23.8 J	15.2 J
Zinc	12000	190000	190000	310000	5.4	4.1	15.6	9.6	3.5	3.5	11.1	7.2

Blank results = analyte not analyzed. U = Not detected. J = Organics; estimated. Inorganics; blank contamination. B = Organics; blank contamination. Inorganics; estimated. E = Inorganics: matrix interference. \* = excavated location.

**Table 1.**  
**Soils Data Summary - Building 67 Area Soil Borings**  
**Former York Naval Ordnance Plant - York, PA**

Location/ID Depth (ft.) Sample Date	MSC Soil to GW Used Aquifer (mg/kg)	MSC Direct Contact 0 - 2 ft (mg/kg)	MSC Direct Contact 2 - 15 ft (mg/kg)	EPA RSL Industrial Soil (mg/kg)	NPA-SB-007 3 - 4 7/16/2010	NPA-SB-008 3 - 4 7/16/2010	NPA-SB-009 3 - 4 7/16/2010	NPA-SB-010 3 - 4 7/16/2010	NPA-SB-011 3 - 4 7/16/2010	NPA-SB-012 3 - 4 7/16/2010	NPA-SB-013 5 - 6 7/16/2010	NPA-SB-014 5 - 6 7/16/2010
<b><i>Volatile Organic Compound</i></b>												
1,1,1,2-Tetrachloroethane	18	3100	190000	9.8	0.0053 U	0.0054 U	0.0058 U	0.005 U	0.0045 U	0.0052 U	0.006 U	0.0054 U
1,1,1-Trichloroethane	20	10000	10000	39000	0.0053 U	0.0054 U	0.0058 U	0.005 U	0.0045 U	0.0052 U	0.006 U	0.0054 U
1,1,2,2-Tetrachloroethane	0.03	28	33	2.9	0.0053 U	0.0054 U	0.0058 U	0.005 U	0.0045 U	0.0052 U	0.006 U	0.0054 U
1,1,2-Trichloroethane	0.5	100	120	5.5	0.0053 U	0.0054 U	0.0058 U	0.005 U	0.0045 U	0.0052 U	0.006 U	0.0054 U
1,1-Dichloroethane	11	1000	1200	17	0.0053 U	0.0054 U	0.0058 U	0.005 U	0.0045 U	0.0052 U	0.006 U	0.0054 U
1,1-Dichloroethene	0.7	33	38	1100	0.0053 U	0.0054 U	0.0058 U	0.005 U	0.0045 U	0.0052 U	0.006 U	0.0054 U
1,2-Dibromoethane	0.005	0.93	8.6	0.17	0.0053 U	0.0054 U	0.0058 U	0.005 U	0.0045 U	0.0052 U	0.006 U	0.0054 U
1,2-Dichloroethane	0.5	63	73	2.2	0.0053 U	0.0054 U	0.0058 U	0.005 U	0.0045 U	0.0052 U	0.006 U	0.0054 U
1,2-Dichloropropane	0.5	160	180	4.7	0.0053 U	0.0054 U	0.0058 U	0.005 U	0.0045 U	0.0052 U	0.006 U	0.0054 U
1,4-Dioxane	2.4	210	240	160	1.1 U	1.1 U	1.2 U	1 U	0.89 U	1 U	1.2 U	1.1 U
2-Butanone	580	10000	10000	190000	0.021 U	0.021 U	0.023 U	0.02 U	0.018 U	0.021 U	0.0035 J	0.021 U
2-Hexanone					0.021 U	0.021 U	0.023 U	0.02 U	0.018 U	0.021 U	0.024 U	0.021 U
4-Methyl-2-Pentanone	41	4300	4900	52000	0.021 U	0.021 U	0.023 U	0.02 U	0.018 U	0.021 U	0.024 U	0.021 U
Acetone	1000	10000	10000	610000	0.021 U	0.021 U	0.023 U	0.02 U	0.018 U	0.021 U	0.024 U	0.021 U
Acrylonitrile	0.27	24	28	1.2	0.11 U	0.11 U	0.12 U	0.1 U	0.089 U	0.1 U	0.12 U	0.11 U
Benzene	0.5	210	240	5.6	0.0053 U	0.0054 U	0.0058 U	0.005 U	0.0045 U	0.0052 U	0.006 U	0.0054 U
Bromochloromethane	9	10000	10000		0.0053 U	0.0054 U	0.0058 U	0.005 U	0.0045 U	0.0052 U	0.006 U	0.0054 U
Bromodichloromethane	10	45	51	1.4	0.0053 U	0.0054 U	0.0058 U	0.005 U	0.0045 U	0.0052 U	0.006 U	0.0054 U
Bromoform	10	1500	1700	220	0.0053 U	0.0054 U	0.0058 U	0.005 U	0.0045 U	0.0052 U	0.006 U	0.0054 U
Bromomethane	1	270	300	35	0.0053 U	0.0054 U	0.0058 U	0.005 U	0.0045 U	0.0052 U	0.006 U	0.0054 U
Carbon Disulfide	410	10000	10000	3000	0.0053 U	0.0054 U	0.0058 U	0.005 U	0.0045 U	0.0052 U	0.006 U	0.0054 U
Carbon Tetrachloride	0.5	110	120	1.3	0.0053 U	0.0054 U	0.0058 U	0.005 U	0.0045 U	0.0052 U	0.006 U	0.0054 U
Chlorobenzene	10	10000	10000	1500	0.0053 U	0.0054 U	0.0058 U	0.005 U	0.0045 U	0.0052 U	0.006 U	0.0054 U
Chlorodibromomethane	10	61	70	3.4	0.0053 U	0.0054 U	0.0058 U	0.005 U	0.0045 U	0.0052 U	0.006 U	0.0054 U
Chloroethane	90	10000	10000	62000	0.0053 U	0.0054 U	0.0058 U	0.005 U	0.0045 U	0.0052 U	0.006 U	0.0054 U
Chloroform	10	17	19	1.5	0.0053 U	0.0054 U	0.0058 U	0.005 U	0.0045 U	0.0052 U	0.006 U	0.0054 U
Chloromethane	0.3	920	1000	510	0.0053 U	0.0054 U	0.0058 U	0.005 U	0.0045 U	0.0052 U	0.006 U	0.0054 U
cis-1,2-Dichloroethene	7	1900	2100	10000	0.0053 U	0.0054 U	0.0058 U	0.005 U	0.0045 U	0.0052 U	0.0018 J	0.0054 U
cis-1,3-Dichloropropene	2.6	410	470	8.4	0.0053 U	0.0054 U	0.0058 U	0.005 U	0.0045 U	0.0052 U	0.006 U	0.0054 U
Ethylbenzene	70	10000	10000	29	0.0053 U	0.0054 U	0.0058 U	0.005 U	0.0045 U	0.0052 U	0.006 U	0.0054 U
Methyl tert-butyl ether	2	3200	3700	190	0.0053 U	0.0054 U	0.0058 U	0.005 U	0.0045 U	0.0052 U	0.006 U	0.0054 U
Methylene chloride	0.5	3500	4000	54	0.0053 U	0.0054 U	0.0058 U	0.005 U	0.0045 U	0.0052 U	0.033	0.0054 U
Styrene	24	10000	10000	38000	0.0053 U	0.0054 U	0.0058 U	0.005 U	0.0045 U	0.0052 U	0.006 U	0.0054 U
Tetrachloroethene	0.5	1500	3300	2.7	0.0053 U	0.0054 U	0.0058 U	0.005 U	0.0045 U	0.0052 U	0.006 U	0.0054 U
Toluene	100	10000	10000	46000	0.0053 U	0.0054 U	0.0058 U	0.005 U	0.0045 U	0.0052 U	0.006 U	0.0054 U
trans-1,2-Dichloroethene	10	3700	4300	500	0.0053 U	0.0054 U	0.0058 U	0.005 U	0.0045 U	0.0052 U	0.006 U	0.0054 U
trans-1,3-Dichloropropene	2.6	410	470	8.4	0.0053 U	0.0054 U	0.0058 U	0.005 U	0.0045 U	0.0052 U	0.006 U	0.0054 U
Trichloroethene	0.5	970	1100	14	0.0053 U	0.0054 U	0.0058 U	0.005 U	0.0045 U	0.0052 U	0.0029 J	0.0023 J
Vinyl Chloride	0.2	53	220	1.7	0.0053 U	0.0054 U	0.0058 U	0.005 U	0.0045 U	0.0052 U	0.006 U	0.0054 U
Xylenes (Total)	1000	10000	10000	2600	0.016 U	0.016 U	0.017 U	0.015 U	0.013 U	0.016 U	0.018 U	0.016 U

Blank results = analyte not analyzed. U = Not detected. J = Organics; estimated. Inorganics; blank contamination. B = Organics; blank contamination. Inorganics; estimated. E = Inorganics; matrix interference. \* = excavated location.

**Table 2.**  
**Soils Data Summary - Metal Chip Bin Area Soil Borings**  
**Former York Naval Ordnance Plant - York, PA**

Location/ID Depth (ft.) Sample Date	MSC Soil to GW Used Aquifer (mg/kg)	MSC Direct Contact 0 - 2 ft (mg/kg)	MSC Direct Contact 2 - 15 ft (mg/kg)	EPA RSL Industrial Soil (mg/kg)	NPA-SB-015 3 - 4 7/16/2010	NPA-SB-016 3 - 4 7/16/2010	NPA-SB-017 1.5 - 2.5 7/16/2010	NPA-SB-018 1.5 - 2.5 7/16/2010
<b>Mercury</b>								
Mercury	10	840	190000	24	0.039 U	0.083	0.077	0.015 B
<b>Metal</b>								
Antimony	27	1100	190000	410	0.037 B	0.41	0.23 B	0.16 B
Arsenic	150	53	190000	1.6	0.17	5.5	6.1	8.8
Barium	8200	190000	190000	190000	35.1	34.8	21.8	44.5
Beryllium	320	5600	190000	2000	0.2	0.33	0.23	0.49
Cadmium	38	210	190000	800	0.079 B	0.98	0.61	0.25
Chromium				1400	7.6 J	30.1 J	12.8 J	10.4 J
Copper	36000	100000	190000	41000	2.5	20.3	66.1	45.2
Lead	450	1000	190000	800	9.9	408	32.1	26.6
Nickel	650	56000	190000	20000	2.1	22.2	23.9	10.6
Selenium	26	14000	190000	5100	0.31 B J	0.53 B J	0.43 B J	0.42 B J
Silver	84	14000	190000	5100	0.017 B	0.59	0.036 B	0.053 B
Thallium	14	200	190000	66	0.1 B	0.13	0.29	0.41
Vanadium	72000	20000	190000	7200	9.7 J	18.7 J	14.2 J	21.3 J
Zinc	12000	190000	190000	310000	4.1	23.1	29.9	18.2
<b>Polychlorinated Biphenols</b>								
Arochlor-1016	200	200	10000	21	0.02 U	0.22 U	0.097 U	0.042 U
Arochlor-1221	2.5	160	10000	0.62	0.02 U	0.22 U	0.097 U	0.042 U
Arochlor-1232	2	160	10000	0.62	0.02 U	0.22 U	0.097 U	0.042 U
Arochlor-1242	62	160	10000	0.74	0.02 U	0.22 U	0.097 U	0.042 U
Arochlor-1248	67	44	10000	0.74	0.02 U	0.22 U	0.097 U	0.042 U
Arochlor-1254	280	44	10000	0.74	0.051	0.22 U	0.097 U	0.042 U
Arochlor-1260	1900	130	190000	0.74	0.047	13	4.9	2.1

Blank results = analyte not analyzed. U = Not detected. J = Organics; estimated. Inorganics; blank contamination. B = Organics; blank contamination. Inorganics; estimated. E = Inorganics: matrix interference. \* = excavated location.

**Table 2.**  
**Soils Data Summary - Metal Chip Bin Area Soil Borings**  
**Former York Naval Ordnance Plant - York, PA**

Location/ID Depth (ft.) Sample Date	MSC Soil to GW Used Aquifer (mg/kg)	MSC Direct Contact 0 - 2 ft (mg/kg)	MSC Direct Contact 2 - 15 ft (mg/kg)	EPA RSL Industrial Soil (mg/kg)	NPA-SB-015 3 - 4 7/16/2010	NPA-SB-016 3 - 4 7/16/2010	NPA-SB-017 1.5 - 2.5 7/16/2010	NPA-SB-018 1.5 - 2.5 7/16/2010
<b>Semi Volatile Organic Compound</b>								
1,2,4-Trichlorobenzene	27	10000	10000	400	0.39 U	43 U	19 U	0.81 U
1,2-Dichlorobenzene	60	10000	10000	10000	0.39 U	43 U	19 U	0.81 U
1,3-Dichlorobenzene	61	10000	10000		0.39 U	43 U	19 U	0.81 U
1,4-Dichlorobenzene	10	3300	190000	13	0.39 U	43 U	19 U	0.81 U
2,4,5-Trichlorophenol	6100	190000	190000	62000	0.39 U	43 U	19 U	0.81 U
2,4,6-Trichlorophenol	8.9	840	190000	160	0.39 U	43 U	19 U	0.81 U
2,4-Dichlorophenol	2	8400	190000	1800	0.39 U	43 U	19 U	0.81 U
2,4-Dimethylphenol	200	10000	10000	12000	0.39 U	43 U	19 U	0.81 U
2,4-Dinitrophenol	4.1	5600	190000	1200	2 U	220 U	100 U	4.2 U
2,4-Dinitrotoluene	0.84	260	190000	5.5	0.39 U	43 U	19 U	0.81 U
2,6-Dinitrotoluene	10	2800	190000	620	0.39 U	43 U	19 U	0.81 U
2-Chloronaphthalene	18000	190000	190000	82000	0.39 U	43 U	19 U	0.81 U
2-Chlorophenol	4.4	920	1100	5100	0.39 U	43 U	19 U	0.81 U
2-Methylnaphthalene	8000	10000	10000	4100	0.022 J	2.3 J	0.84 J	0.085 J
2-Methylphenol	510	10000	10000	31000	0.39 U	43 U	19 U	0.81 U
2-Nitroaniline	0.58	160	190000	1800	2 U	220 U	100 U	4.2 U
2-Nitrophenol	82	22000	190000		0.39 U	43 U	19 U	0.81 U
3,3'-Dichlorobenzidine	32	180	190000	3.8	1.9 U	210 U	94 U	3.9 U
3/4-Methylphenol				5100	0.39 U	43 U	19 U	0.81 U
3-Nitroaniline	0.58	160	190000		2 U	220 U	100 U	4.2 U
4,6-Dinitro-2-Methylphenol				62	2 U	220 U	100 U	4.2 U
4-Bromophenyl phenyl ether					0.39 U	43 U	19 U	0.81 U
4-Chloro-3-Methyl-Phenol	110	14000	190000		0.39 U	43 U	19 U	0.81 U
4-Chloroaniline	52	11000	190000	8.6	0.39 U	43 U	19 U	0.81 U
4-Chlorodiphenyl Ether					0.39 U	43 U	19 U	0.81 U
4-Nitroaniline	0.58	160	190000	86	2 U	220 U	100 U	4.2 U
4-Nitrophenol	6	22000	190000		2 U	220 U	100 U	4.2 U
Acenaphthene	4700	170000	190000	33000	0.057 J	11 J	1.3 J	0.13 J
Acenaphthylene	6900	170000	190000	33000	0.39 U	43 U	19 U	0.81 U
Anthracene	350	190000	190000	170000	0.02 J	4.4 J	0.55 J	0.094 J
Benzo (A) Anthracene	320	110	190000	2.1	0.037 J	3.7 J	2 J	0.19 J
Benzo (a) Pyrene	46	11	190000	0.21	0.026 J	3 J	1.4 J	0.19 J
Benzo (b) Fluoranthene	170	110	190000	2.1	0.049 J	3.6 J	2.9 J	0.34 J
Benzo (g,h,i) Perylene	180	170000	190000		0.39 U	43 U	1 J	0.15 J
Benzo (k) Fluoranthene	610	1100	190000	21	0.39 U	43 U	19 U	0.81 U
Bis(2-Chloroethoxy) Methane				1800	0.39 U	43 U	19 U	0.81 U
Bis(2-Chloroethyl) Ether	0.055	5	5.7	0.9	0.39 U	43 U	19 U	0.81 U
Bis(2-Chloroisopropyl) Ether	30	160	190	17	0.39 U	43 U	19 U	0.81 U
Bis(2-Ethylhexyl) Phthalate	130	5700	10000	120	0.095 J	43 U	19 U	0.21 J
Butylbenzylphthalate	10000	10000	10000	910	0.39 U	43 U	19 U	0.81 U
Carbazole	83	4000	190000		0.39 U	43 U	19 U	0.81 U
Chrysene	230	11000	190000	210	0.062 J	6.4 J	1.8 J	0.2 J
Dibenzo (a,h) Anthracene	160	11	190000	0.21	0.39 U	43 U	19 U	0.81 U
Dibenzofuran					0.39 U	5.5 J	19 U	0.81 U
Diethylphthalate	500	10000	10000	490000	0.39 U	43 U	19 U	0.81 U
Dimethylphthalate					0.39 U	43 U	19 U	0.81 U
Di-n-Butylphthalate	4100	10000	10000	62000	0.39 U	43 U	19 U	0.81 U
Di-n-octylphthalate	10000	10000	10000		0.39 U	43 U	19 U	0.81 U
Fluoranthene	3200	110000	190000	22000	0.097 J	17 J	3.2 J	0.55 J
Fluorene	3800	110000	190000	22000	0.043 J	7.8 J	0.59 J	0.12 J
Hexachlorobenzene	0.96	50	190000	1.1	0.39 U	43 U	19 U	0.81 U
Hexachlorobutadiene	1.2	560	10000	22	0.39 U	43 U	19 U	0.81 U
Hexachlorocyclopentadiene	91	10000	10000	3700	1.9 U	210 U	94 U	3.9 U
Hexachloroethane	0.56	2800	190000	120	0.39 U	43 U	19 U	0.81 U
Indeno (1,2,3-cd) Pyrene	28000	110	190000	2.1	0.025 J	43 U	19 U	0.1 J
Isophorone	10	10000	10000	1800	0.39 U	43 U	19 U	0.81 U
Naphthalene	25	56000	190000	20	0.024 J	2.4 J	1.4 J	0.079 J
Nitrobenzene	5.1	1400	10000	22	0.39 U	43 U	19 U	0.81 U
N-Nitrosodi-N-Propylamine	0.037	11	10000	0.25	0.39 U	43 U	19 U	0.81 U
N-Nitrosodiphenylamine	83	16000	190000	350	0.39 U	43 U	19 U	0.81 U
Pentachlorophenol	5	660	190000	9	1.9 U	210 U	94 U	3.9 U
Phenanthrene	10000	190000	190000		0.088 J	19 J	1.2 J	0.81
Phenol	400	190000	190000	180000	0.39 U	43 U	19 U	0.81 U
Pyrene	2200	84000	190000	17000	0.14 J	25 J	9.8 J	0.75 J

Blank results = analyte not analyzed. U = Not detected. J = Organics; estimated. Inorganics; blank contamination. B = Organics; blank contamination. Inorganics; estimated. E = Inorganics: matrix interference. \* = excavated location.

**Table 2.**  
**Soils Data Summary - Metal Chip Bin Area Soil Borings**  
**Former York Naval Ordnance Plant - York, PA**

Location/ID Depth (ft.) Sample Date Parameter	MSC Soil to GW Used Aquifer (mg/kg)	MSC Direct Contact 0 - 2 ft (mg/kg)	MSC Direct Contact 2 - 15 ft (mg/kg)	EPA RSL Industrial Soil (mg/kg)	NPA-SB-015 3 - 4 7/16/2010	NPA-SB-016 3 - 4 7/16/2010	NPA-SB-017 1.5 - 2.5 7/16/2010	NPA-SB-018 1.5 - 2.5 7/16/2010
<b><i>Volatile Organic Compound</i></b>								
1,1,1,2-Tetrachloroethane	18	3100	190000	9.8	0.0051 U	0.49 U	0.49 U	0.27 U
1,1,1-Trichloroethane	20	10000	10000	39000	0.0051 U	0.49 U	0.49 U	0.27 U
1,1,2,2-Tetrachloroethane	0.03	28	33	2.9	0.0051 U	0.49 U	0.49 U	0.27 U
1,1,2-Trichloroethane	0.5	100	120	5.5	0.0051 U	0.49 U	0.49 U	0.27 U
1,1-Dichloroethane	11	1000	1200	17	0.0051 U	0.49 U	0.49 U	0.27 U
1,1-Dichloroethene	0.7	33	38	1100	0.0051 U	0.49 U	0.49 U	0.27 U
1,2-Dibromoethane	0.005	0.93	8.6	0.17	0.0051 U	0.49 U	0.49 U	0.27 U
1,2-Dichloroethane	0.5	63	73	2.2	0.0051 U	0.49 U	0.49 U	0.27 U
1,2-Dichloropropane	0.5	160	180	4.7	0.0051 U	0.49 U	0.49 U	0.27 U
1,4-Dioxane	2.4	210	240	160	1 U	98 U	99 U	55 U
2-Butanone	580	10000	10000	190000	0.02 U	2 U	2 U	1.1 U
2-Hexanone					0.02 U	2 U	2 U	1.1 U
4-Methyl-2-Pentanone	41	4300	4900	52000	0.02 U	2 U	2 U	1.1 U
Acetone	1000	10000	10000	610000	0.02 U	2 U	2 U	1.1 U
Acrylonitrile	0.27	24	28	1.2	0.1 U	9.8 U	9.9 U	5.5 U
Benzene	0.5	210	240	5.6	0.0051 U	0.49 U	0.49 U	0.27 U
Bromochloromethane	9	10000	10000		0.0051 U	0.49 U	0.49 U	0.27 U
Bromodichloromethane	10	45	51	1.4	0.0051 U	0.49 U	0.49 U	0.27 U
Bromoform	10	1500	1700	220	0.0051 U	0.49 U	0.49 U	0.27 U
Bromomethane	1	270	300	35	0.0051 U	0.49 U	0.49 U	0.27 U
Carbon Disulfide	410	10000	10000	3000	0.0051 U	0.49 U	0.49 U	0.27 U
Carbon Tetrachloride	0.5	110	120	1.3	0.0051 U	0.49 U	0.49 U	0.27 U
Chlorobenzene	10	10000	10000	1500	0.0051 U	0.13 J	0.49 U	0.27 U
Chlorodibromomethane	10	61	70	3.4	0.0051 U	0.49 U	0.49 U	0.27 U
Chloroethane	90	10000	10000	62000	0.0051 U	0.49 U	0.49 U	0.27 U
Chloroform	10	17	19	1.5	0.0051 U	0.49 U	0.49 U	0.27 U
Chloromethane	0.3	920	1000	510	0.0051 U	0.49 U	0.49 U	0.27 U
cis-1,2-Dichloroethene	7	1900	2100	10000	0.0051 U	0.15 J	0.33 J	0.063 J
cis-1,3-Dichloropropene	2.6	410	470	8.4	0.0051 U	0.49 U	0.49 U	0.27 U
Ethylbenzene	70	10000	10000	29	0.0051 U	0.33 J	0.23 J	0.24 J
Methyl tert-butyl ether	2	3200	3700	190	0.0051 U	0.49 U	0.49 U	0.27 U
Methylene chloride	0.5	3500	4000	54	0.0051 U	0.49 U	0.49 U	0.27 U
Styrene	24	10000	10000	38000	0.0051 U	0.49 U	0.49 U	0.27 U
Tetrachloroethene	0.5	1500	3300	2.7	0.0051 U	0.49 U	0.49 U	0.27 U
Toluene	100	10000	10000	46000	0.0051 U	0.13 J	0.17 J	0.12 J
trans-1,2-Dichloroethene	10	3700	4300	500	0.0051 U	0.49 U	0.49 U	0.27 U
trans-1,3-Dichloropropene	2.6	410	470	8.4	0.0051 U	0.49 U	0.49 U	0.27 U
Trichloroethene	0.5	970	1100	14	0.0051 U	0.49 U	0.49 U	0.27 U
Vinyl Chloride	0.2	53	220	1.7	0.0051 U	0.49 U	0.49 U	0.27 U
Xylenes (Total)	1000	10000	10000	2600	0.015 U	1.1 J	0.83 J	0.81 J

Blank results = analyte not analyzed. U = Not detected. J = Organics; estimated. Inorganics; blank contamination. B = Organics; blank contamination. Inorganics; estimated. E = Inorganics: matrix interference. \* = excavated location.

Table 3. Waste Shipment and Disposal Summary  
Metal Chip Bin Area  
Former York Naval Ordnance Plant

Remediation Area	Volume	Container type	Transporter	Box	Date	Date	contents	Destination	Manifest Ref.	BOL Ref.	Net Wt. (Tons)
				Ref. No.	arrived	shipped					
MCB	20 CY	Roll-off	Envirite	130	07/27/10	08/09/10	non-haz soil	Modern LF	09-03024		14.6
MCB	20 CY	Roll-off	Envirite	66244	07/27/10	08/09/10	non-haz soil	Modern LF	09-03025		11.43
MCB	20 CY	Roll-off	Envirite	6201Y03	07/27/10	08/09/10	non-haz soil	Modern LF	09-03026		16.99
MCB	20 CY	Roll-off	Envirite	274233	07/27/10	08/10/10	non-haz soil	Modern LF	09-03027		12.16
MCB	20 CY	Roll-off	Envirite	20029	07/27/10	08/10/10	non-haz soil	Modern LF	09-03028		14.47
MCB	20 CY	Roll-off	Envirite	6072	07/27/10	08/10/10	non-haz soil	Modern LF	09-03031		13.59
MCB	20 CY	Roll-off	Envirite	6204Y03	07/27/10	08/10/10	non-haz soil	Modern LF	09-03032		14.16
MCB	20 CY	Roll-off	Envirite	6007Y0	07/28/10	08/09/10	non-haz soil	Modern LF	09-03023		12.19
MCB	20 CY	Roll-off	Envirite	6006Y0	07/28/10	08/10/10	non-haz soil	Modern LF	09-03029		10.23
MCB	20 CY	Roll-off	Envirite	W57592	07/28/10	08/10/10	non-haz soil	Modern LF	09-03030		15.33
MCB	30 CY	Semi-Dump	Envirite		08/03/10	08/03/10	non-haz soil	Modern LF	07 42431		20.38
MCB	30 CY	Semi-Dump	Envirite		08/03/10	08/03/10	non-haz soil	Modern LF	07 42432	65208	22.1
MCB	30 CY	Semi-Dump	Envirite		08/03/10	08/03/10	non-haz soil	Modern LF	07 42433	59876	21.34
MCB	30 CY	Semi-Dump	Envirite		08/04/10	08/04/10	non-haz soil	Modern LF	07 42434		21.66
MCB	30 CY	Semi-Dump	Envirite		08/04/10	08/04/10	non-haz soil	Modern LF	07 42437	59875	19.79
MCB	30 CY	Semi-Dump	Envirite		08/04/10	08/04/10	non-haz soil	Modern LF	07 42438	68897	18.58
MCB	30 CY	Semi-Dump	Envirite		08/04/10	08/04/10	non-haz soil	Modern LF	07 42439	68898	20.92
MCB	30 CY	Semi-Dump	Envirite		08/04/10	08/04/10	non-haz soil	Modern LF	07 42440	68899	20.84
MCB	30 CY	Semi-Dump	Envirite		08/05/10	08/05/10	non-haz soil	Modern LF	07 42442	65248/65243	18.94
MCB	30 CY	Semi-Dump	Envirite		08/05/10	08/05/10	non-haz soil	Modern LF	09-03003	65245	18.38
MCB	30 CY	Semi-Dump	Envirite		08/05/10	08/05/10	non-haz soil	Modern LF	09-03005	65249	17.61
MCB	30 CY	Semi-Dump	Envirite		08/05/10	08/05/10	non-haz soil	Modern LF	09-03006	65246	18.48
MCB	30 CY	Semi-Dump	Envirite		08/05/10	08/05/10	non-haz soil	Modern LF	09-03007	65250	20.57
MCB	30 CY	Semi-Dump	Envirite		08/05/10	08/05/10	non-haz soil	Modern LF	09-03009	65223	22.15
MCB	30 CY	Semi-Dump	Envirite		08/05/10	08/05/10	non-haz soil	Modern LF	09-03010	65227	20.14
MCB	30 CY	Semi-Dump	Envirite		08/05/10	08/05/10	non-haz soil	Modern LF	09-03011	65247	22.01
MCB	30 CY	Semi-Dump	Envirite		05/06/10	05/06/10	non-haz soil	Modern LF	09-03013	65222	21.66
MCB	30 CY	Semi-Dump	Envirite		08/06/10	08/06/10	non-haz soil	Modern LF	09-03014	65256	23.5
MCB	30 CY	Semi-Dump	Envirite		08/06/10	08/06/10	non-haz soil	Modern LF	09-03016	65218	24.37
MCB	30 CY	Semi-Dump	Envirite		08/06/10	08/06/10	non-haz soil	Modern LF	09-03017	65257	20.5
MCB	30 CY	Semi-Dump	Envirite		08/06/10	08/06/10	non-haz soil	Modern LF	09-03018	65252	20.72
MCB	30 CY	Semi-Dump	Envirite		08/06/10	08/06/10	non-haz soil	Modern LF	09-03019	65258	22.45
MCB	30 CY	Semi-Dump	Envirite		08/06/10	08/06/10	non-haz soil	Modern LF	09-03020	65215	21.81
MCB	30 CY	Semi-Dump	Envirite		08/06/10	08/06/10	non-haz soil	Modern LF	09-03021	65255	21.39
MCB	30 CY	Semi-Dump	Envirite		08/06/10	08/06/10	non-haz soil	Modern LF	09-03022	65253	22.34

657.78



**Table 4.**  
**Soils Data Summary - Metal Chip Bin Area Confirmation Sampling**  
**Former York Naval Ordnance Plant - York, PA**

Location/ID Depth (ft.) Sample Date	MSC Soil to GW Used Aquifer (mg/kg)	MSC Direct Contact 0 - 2 ft (mg/kg)	MSC Direct Contact 2 - 15 ft (mg/kg)	EPA RSL Industrial Soil (mg/kg)	NPA-CS-001 1 - 2 8/4/2010	NPA-CS-002 2.5 - 3 8/4/2010	NPA-CS-003 2.5 - 3 8/4/2010	NPA-CS-004 2 - 3 8/4/2010	NPA-CS-005 2.5 - 3 8/4/2010	NPA-CS-006 2 - 2.5 8/4/2010	NPA-CS-007 3.5 - 4 8/4/2010
<b>Cyanide, Total</b>											
Cyanide, Total	200	56000	190000	20000	1.2	0.12 B	0.62 U	0.58 U	0.6 U	0.6 U	0.61 U
<b>Hexavalent Chromium</b>											
Hexavalent Chromium	190	420	190000	200	3.1	0.62	0.77	0.92	0.62	0.24 B	2
<b>Mercury</b>											
Mercury	10	840	190000	24	0.15	0.037 B	0.035 B	0.071	0.046	0.035 B	0.068
<b>Metal</b>											
Antimony	27	1100	190000	410	0.38 B	1.2 U	1.2 U	0.22 B	1.2 U	1.2 U	1.2 U
Arsenic	150	53	190000	1.6	6.1	1.8	4.2	2.1	2.4	4.5	3.6
Beryllium	320	5600	190000	2000	0.25 B	0.58	0.85	0.28 B	0.59	0.53	1.1
Cadmium	38	210	190000	800	0.83	0.6 U	0.62 U	0.24 B	0.6 U	0.6 U	0.61 U
Chromium				1400	61.3	8.4	16.3	13	10.3	11.7	12.6
Copper	36000	100000	190000	41000	65.5	3.3	6.5	27.4	5.5	7.1	4.4
Lead	450	1000	190000	800	40.7	8.9	10.7	14.1	9.8	11.1	10.5
Nickel	650	56000	190000	20000	44.5 E	2.2 B	4.2 B	7.3	2 B	3.6 B	3.1 B
Selenium	26	14000	190000	5100	0.39 B	0.6 U	0.35 B	0.58 U	0.78	0.44 B	0.36 B
Silver	84	14000	190000	5100	0.12 B	0.6 U	0.62 U	0.58 U	0.6 U	0.6 U	0.61 U
Thallium	14	200	190000	66	1.2 U	1.2 U	1.2 U	1.2 U	0.49 B	0.29 B	0.37 B
Zinc	12000	190000	190000	310000	106	5.2	11.4	36.7	6.7	9.1	10.5
<b>Polychlorinated Biphenols</b>											
Arochlor-1016	200	200	10000	21	0.4 U	0.019 U	0.02 U	0.019 U	0.02 U	0.02 U	0.02 U
Arochlor-1221	2.5	160	10000	0.62	0.4 U	0.019 U	0.02 U	0.019 U	0.02 U	0.02 U	0.02 U
Arochlor-1232	2	160	10000	0.62	0.4 U	0.019 U	0.02 U	0.019 U	0.02 U	0.02 U	0.02 U
Arochlor-1242	62	160	10000	0.74	0.4 U	0.019 U	0.02 U	0.019 U	0.02 U	0.02 U	0.02 U
Arochlor-1248	67	44	10000	0.74	0.4 U	0.019 U	0.02 U	0.019 U	0.02 U	0.02 U	0.02 U
Arochlor-1254	280	44	10000	0.74	1.9	0.019 U	0.02 U	0.019 U	0.02 U	0.074	0.02 U
Arochlor-1260	1900	130	190000	0.74	1.6	0.019 U	0.02 U	0.019 U	0.02 U	0.053	0.02 U

Blank results = analyte not analyzed. U = Not detected. J = Organics; estimated. Inorganics; blank contamination. B = Organics; blank contamination. Inorganics; estimated. E = Inorganics; matrix interference. \* = excavated location.

**Table 4.**  
**Soils Data Summary - Metal Chip Bin Area Confirmation Sampling**  
**Former York Naval Ordnance Plant - York, PA**

Location/ID Depth (ft.) Sample Date	MSC Soil to GW Used Aquifer (mg/kg)	MSC Direct Contact 0 - 2 ft (mg/kg)	MSC Direct Contact 2 - 15 ft (mg/kg)	EPA RSL Industrial Soil (mg/kg)	NPA-CS-001 1 - 2 8/4/2010	NPA-CS-002 2.5 - 3 8/4/2010	NPA-CS-003 2.5 - 3 8/4/2010	NPA-CS-004 2 - 3 8/4/2010	NPA-CS-005 2.5 - 3 8/4/2010	NPA-CS-006 2 - 2.5 8/4/2010	NPA-CS-007 3.5 - 4 8/4/2010
<b>Semi Volatile Organic Compound</b>											
1,2,4-Trichlorobenzene	27	10000	10000	400	3.9 U	0.39 U	0.4 U	3.8 U	0.4 U	0.38 U	0.4 U
1,2-Dichlorobenzene	60	10000	10000	10000	3.9 U	0.39 U	0.4 U	3.8 U	0.4 U	0.38 U	0.4 U
1,3-Dichlorobenzene	61	10000	10000		3.9 U	0.39 U	0.4 U	3.8 U	0.4 U	0.38 U	0.4 U
1,4-Dichlorobenzene	10	3300	190000	13	3.9 U	0.39 U	0.4 U	3.8 U	0.4 U	0.38 U	0.4 U
2,4,5-Trichlorophenol	6100	190000	190000	62000	3.9 U	0.39 U	0.4 U	3.8 U	0.4 U	0.38 U	0.4 U
2,4,6-Trichlorophenol	8.9	840	190000	160	3.9 U	0.39 U	0.4 U	3.8 U	0.4 U	0.38 U	0.4 U
2,4-Dichlorophenol	2	8400	190000	1800	3.9 U	0.39 U	0.4 U	3.8 U	0.4 U	0.38 U	0.4 U
2,4-Dimethylphenol	200	10000	10000	12000	3.9 U	0.39 U	0.4 U	3.8 U	0.4 U	0.38 U	0.4 U
2,4-Dinitrophenol	4.1	5600	190000	1200	20 U	2 U	2.1 U	19 U	2.1 U	2 U	2.1 U
2,4-Dinitrotoluene	0.84	260	190000	5.5	3.9 U	0.39 U	0.4 U	3.8 U	0.4 U	0.38 U	0.4 U
2,6-Dinitrotoluene	10	2800	190000	620	3.9 U	0.39 U	0.4 U	3.8 U	0.4 U	0.38 U	0.4 U
2-Chloronaphthalene	18000	190000	190000	82000	3.9 U	0.39 U	0.4 U	3.8 U	0.4 U	0.38 U	0.4 U
2-Chlorophenol	4.4	920	1100	5100	3.9 U	0.39 U	0.4 U	3.8 U	0.4 U	0.38 U	0.4 U
2-Methylnaphthalene	8000	10000	10000	4100	3.9 U	0.39 U	0.4 U	3.8 U	0.4 U	0.019 J	0.4 U
2-Methylphenol	510	10000	10000	31000	3.9 U	0.39 U	0.4 U	3.8 U	0.4 U	0.38 U	0.4 U
2-Nitroaniline	0.58	160	190000	1800	20 U	2 U	2.1 U	19 U	2.1 U	2 U	2.1 U
2-Nitrophenol	82	22000	190000		3.9 U	0.39 U	0.4 U	3.8 U	0.4 U	0.38 U	0.4 U
3,3'-Dichlorobenzidine	32	180	190000	3.8	19 U	1.9 U	2 U	18 U	1.9 U	1.8 U	2 U
3/4-Methylphenol				5100	3.9 U	0.39 U	0.4 U	3.8 U	0.4 U	0.38 U	0.4 U
3-Nitroaniline	0.58	160	190000		20 U	2 U	2.1 U	19 U	2.1 U	2 U	2.1 U
4,6-Dinitro-2-Methylphenol				62	20 U	2 U	2.1 U	19 U	2.1 U	2 U	2.1 U
4-Bromophenyl phenyl ether					3.9 U	0.39 U	0.4 U	3.8 U	0.4 U	0.38 U	0.4 U
4-Chloro-3-Methyl-Phenol	110	14000	190000		3.9 U	0.39 U	0.4 U	3.8 U	0.4 U	0.38 U	0.4 U
4-Chloroaniline	52	11000	190000	8.6	3.9 U	0.39 U	0.4 U	3.8 U	0.4 U	0.38 U	0.4 U
4-Chlorodiphenyl Ether					3.9 U	0.39 U	0.4 U	3.8 U	0.4 U	0.38 U	0.4 U
4-Nitroaniline	0.58	160	190000	86	20 U	2 U	2.1 U	19 U	2.1 U	2 U	2.1 U
4-Nitrophenol	6	22000	190000		20 U	2 U	2.1 U	19 U	2.1 U	2 U	2.1 U
Acenaphthene	4700	170000	190000	33000	3.9 U	0.39 U	0.4 U	3.8 U	0.4 U	0.11 J	0.4 U
Acenaphthylene	6900	170000	190000	33000	0.48 J	0.39 U	0.4 U	3.8 U	0.4 U	0.38 U	0.4 U
Anthracene	350	190000	190000	170000	0.18 J	0.39 U	0.4 U	3.8 U	0.4 U	0.046 J	0.4 U
Benzo (A) Anthracene	320	110	190000	2.1	0.42 J	0.39 U	0.4 U	3.8 U	0.4 U	0.066 J	0.4 U
Benzo (a) Pyrene	46	11	190000	0.21	0.89 J	0.39 U	0.4 U	0.14 J	0.4 U	0.036 J	0.4 U
Benzo (b) Fluoranthene	170	110	190000	2.1	1.2 J	0.39 U	0.4 U	0.13 J	0.4 U	0.045 J	0.4 U
Benzo (g,h,i) Perylene	180	170000	190000		0.81 J	0.39 U	0.4 U	0.23 J	0.4 U	0.027 J	0.4 U
Benzo (k) Fluoranthene	610	1100	190000	21	3.9 U	0.39 U	0.4 U	3.8 U	0.4 U	0.021 J	0.4 U
Bis(2-Chloroethoxy) Methane				1800	3.9 U	0.39 U	0.4 U	3.8 U	0.4 U	0.38 U	0.4 U
Bis(2-Chloroethyl) Ether	0.055	5	5.7	0.9	3.9 U	0.39 U	0.4 U	3.8 U	0.4 U	0.38 U	0.4 U
Bis(2-Chloroisopropyl) Ether	30	160	190	17	3.9 U	0.39 U	0.4 U	3.8 U	0.4 U	0.38 U	0.4 U
Bis(2-Ethylhexyl) Phthalate	130	5700	10000	120	3.9 U	0.11 J	0.4 U	3.8 U	0.4 U	0.38 U	0.25 J
Butylbenzylphthalate	10000	10000	10000	910	3.9 U	0.39 U	0.4 U	3.8 U	0.4 U	0.38 U	0.4 U
Carbazole	83	4000	190000		0.15 J	0.39 U	0.4 U	3.8 U	0.4 U	0.38 U	0.4 U
Chrysene	230	11000	190000	210	0.82 J	0.39 U	0.4 U	3.8 U	0.4 U	0.073 J	0.4 U
Dibenzo (a,h) Anthracene	160	11	190000	0.21	3.9 U	0.39 U	0.4 U	3.8 U	0.4 U	0.38 U	0.4 U
Dibenzofuran					3.9 U	0.39 U	0.4 U	3.8 U	0.4 U	0.064 J	0.4 U
Diethylphthalate	500	10000	10000	490000	3.9 U	0.39 U	0.4 U	3.8 U	0.4 U	0.38 U	0.4 U
Dimethylphthalate					3.9 U	0.39 U	0.4 U	3.8 U	0.4 U	0.38 U	0.4 U
Di-n-Butylphthalate	4100	10000	10000	62000	3.9 U	0.39 U	0.4 U	3.8 U	0.4 U	0.38 U	0.4 U
Di-n-octylphthalate	10000	10000	10000		3.9 U	0.39 U	0.4 U	3.8 U	0.4 U	0.38 U	0.4 U
Fluoranthene	3200	110000	190000	22000	1.2 J	0.39 U	0.4 U	0.23 J	0.4 U	0.25 J	0.4 U
Fluorene	3800	110000	190000	22000	3.9 U	0.39 U	0.4 U	3.8 U	0.4 U	0.084 J	0.4 U
Hexachlorobenzene	0.96	50	190000	1.1	3.9 U	0.39 U	0.4 U	3.8 U	0.4 U	0.38 U	0.4 U
Hexachlorobutadiene	1.2	560	10000	22	3.9 U	0.39 U	0.4 U	3.8 U	0.4 U	0.38 U	0.4 U
Hexachlorocyclopentadiene	91	10000	10000	3700	19 U	1.9 U	2 U	18 U	1.9 U	1.8 U	2 U
Hexachloroethane	0.56	2800	190000	120	3.9 U	0.39 U	0.4 U	3.8 U	0.4 U	0.38 U	0.4 U
Indeno (1,2,3-cd) Pyrene	28000	110	190000	2.1	0.55 J	0.39 U	0.4 U	0.11 J	0.4 U	0.022 J	0.4 U
Isophorone	10	10000	10000	1800	3.9 U	0.39 U	0.4 U	3.8 U	0.4 U	0.38 U	0.4 U
Naphthalene	25	56000	190000	20	0.25 J	0.39 U	0.4 U	3.8 U	0.4 U	0.38 U	0.4 U
Nitrobenzene	5.1	1400	10000	22	3.9 U	0.39 U	0.4 U	3.8 U	0.4 U	0.38 U	0.4 U
N-Nitrosodi-N-Propylamine	0.037	11	10000	0.25	3.9 U	0.39 U	0.4 U	3.8 U	0.4 U	0.38 U	0.4 U
N-Nitrosodiphenylamine	83	16000	190000	350	3.9 U	0.39 U	0.4 U	3.8 U	0.4 U	0.38 U	0.4 U
Pentachlorophenol	5	660	190000	9	19 U	1.9 U	2 U	18 U	1.9 U	1.8 U	2 U
Phenanthrene	10000	190000	190000		0.2 J	0.39 U	0.4 U	0.15 J	0.4 U	0.15 J	0.4 U
Phenol	400	190000	190000	180000	3.9 U	0.39 U	0.4 U	3.8 U	0.4 U	0.38 U	0.4 U
Pyrene	2200	84000	190000	17000	3.3 J	0.39 U	0.4 U	0.26 J	0.4 U	0.22 J	0.4 U

Blank results = analyte not analyzed. U = Not detected. J = Organics; estimated. Inorganics; blank contamination. B = Organics; blank contamination. Inorganics; estimated. E = Inorganics; matrix interference. \* = excavated location.

**Table 4.**  
**Soils Data Summary - Metal Chip Bin Area Confirmation Sampling**  
**Former York Naval Ordnance Plant - York, PA**

Location/ID Depth (ft.) Sample Date	MSC Soil to GW Used Aquifer (mg/kg)	MSC Direct Contact 0 - 2 ft (mg/kg)	MSC Direct Contact 2 - 15 ft (mg/kg)	EPA RSL Industrial Soil (mg/kg)	NPA-CS-001 1 - 2 8/4/2010	NPA-CS-002 2.5 - 3 8/4/2010	NPA-CS-003 2.5 - 3 8/4/2010	NPA-CS-004 2 - 3 8/4/2010	NPA-CS-005 2.5 - 3 8/4/2010	NPA-CS-006 2 - 2.5 8/4/2010	NPA-CS-007 3.5 - 4 8/4/2010
<b>Petroleum Hydrocarbons</b>											
N-Hexane Extractable Material					5150	201 U	2400	194 U	201 U	1360	204 U
<b>Volatile Organic Compound</b>											
1,1,1,2-Tetrachloroethane	18	3100	190000	9.8	0.0059 U	0.0051 U	0.0051 U	0.0048 U	0.0052 U	0.0051 U	0.0051 U
1,1,1-Trichloroethane	20	10000	10000	39000	0.0059 U	0.0051 U	0.0051 U	0.0048 U	0.0052 U	0.0051 U	0.0051 U
1,1,2,2-Tetrachloroethane	0.03	28	33	2.9	0.0059 U	0.0051 U	0.0051 U	0.0048 U	0.0052 U	0.0051 U	0.0051 U
1,1,2-Trichloroethane	0.5	100	120	5.5	0.0059 U	0.0051 U	0.0051 U	0.0048 U	0.0052 U	0.0051 U	0.0051 U
1,1-Dichloroethane	11	1000	1200	17	0.0059 U	0.0051 U	0.0051 U	0.0048 U	0.0052 U	0.0051 U	0.0051 U
1,1-Dichloroethene	0.7	33	38	1100	0.0059 U	0.0051 U	0.0051 U	0.0048 U	0.0052 U	0.0051 U	0.0051 U
1,2-Dibromoethane	0.005	0.93	8.6	0.17	0.0059 U	0.0051 U	0.0051 U	0.0048 U	0.0052 U	0.0051 U	0.0051 U
1,2-Dichloroethane	0.5	63	73	2.2	0.0059 U	0.0051 U	0.0051 U	0.0048 U	0.0052 U	0.0051 U	0.0051 U
1,2-Dichloropropane	0.5	160	180	4.7	0.0059 U	0.0051 U	0.0051 U	0.0048 U	0.0052 U	0.0051 U	0.0051 U
1,4-Dioxane	2.4	210	240	160	1.2 U	1 U	1 U	0.96 U	1 U	1 U	1 U
2-Butanone	580	10000	10000	190000	0.023 U	0.02 U	0.02 U	0.019 U	0.021 U	0.02 U	0.02 U
2-Hexanone					0.023 U	0.02 U	0.02 U	0.019 U	0.021 U	0.02 U	0.02 U
4-Methyl-2-Pentanone	41	4300	4900	52000	0.023 U	0.02 U	0.02 U	0.019 U	0.021 U	0.02 U	0.02 U
Acetone	1000	10000	10000	610000	0.023 U	0.02 U	0.0058 J	0.013 J	0.021 U	0.02 U	0.0068 J
Acrylonitrile	0.27	24	28	1.2	0.12 U	0.1 U	0.1 U	0.096 U	0.1 U	0.1 U	0.1 U
Benzene	0.5	210	240	5.6	0.0059 U	0.0051 U	0.0051 U	0.0048 U	0.0052 U	0.0051 U	0.0051 U
Bromochloromethane	9	10000	10000		0.0059 U	0.0051 U	0.0051 U	0.0048 U	0.0052 U	0.0051 U	0.0051 U
Bromodichloromethane	10	45	51	1.4	0.0059 U	0.0051 U	0.0051 U	0.0048 U	0.0052 U	0.0051 U	0.0051 U
Bromoform	10	1500	1700	220	0.0059 U	0.0051 U	0.0051 U	0.0048 U	0.0052 U	0.0051 U	0.0051 U
Bromomethane	1	270	300	35	0.0059 U	0.0051 U	0.0051 U	0.0048 U	0.0052 U	0.0051 U	0.0051 U
Carbon Disulfide	410	10000	10000	3000	0.0059 U	0.0051 U	0.0051 U	0.0048 U	0.0052 U	0.0051 U	0.0051 U
Carbon Tetrachloride	0.5	110	120	1.3	0.0059 U	0.0051 U	0.0051 U	0.0048 U	0.0052 U	0.0051 U	0.0051 U
Chlorobenzene	10	10000	10000	1500	0.0059 U	0.0051 U	0.0051 U	0.0048 U	0.0052 U	0.0051 U	0.0051 U
Chlorodibromomethane	10	61	70	3.4	0.0059 U	0.0051 U	0.0051 U	0.0048 U	0.0052 U	0.0051 U	0.0051 U
Chloroethane	90	10000	10000	62000	0.0059 U	0.0051 U	0.0051 U	0.0048 U	0.0052 U	0.0051 U	0.0051 U
Chloroform	10	17	19	1.5	0.0059 U	0.0051 U	0.0051 U	0.0048 U	0.0052 U	0.0051 U	0.0051 U
Chloromethane	0.3	920	1000	510	0.0059 U	0.0051 U	0.0051 U	0.0048 U	0.0052 U	0.0051 U	0.0051 U
cis-1,2-Dichloroethene	7	1900	2100	10000	0.0059 U	0.0051 U	0.0051 U	0.0048 U	0.0052 U	0.0051 U	0.0051 U
cis-1,3-Dichloropropene	2.6	410	470	8.4	0.0059 U	0.0051 U	0.0051 U	0.0048 U	0.0052 U	0.0051 U	0.0051 U
Ethylbenzene	70	10000	10000	29	0.0059 U	0.0051 U	0.0051 U	0.0048 U	0.0052 U	0.0051 U	0.0051 U
Methyl tert-butyl ether	2	3200	3700	190	0.0059 U	0.0051 U	0.0051 U	0.0048 U	0.0052 U	0.0051 U	0.0051 U
Methylene chloride	0.5	3500	4000	54	0.0034 J B	0.0025 J B	0.0025 J B	0.0025 J B	0.0026 J B	0.0024 J B	0.0023 J B
Styrene	24	10000	10000	38000	0.0059 U	0.0051 U	0.0051 U	0.0048 U	0.0052 U	0.0051 U	0.0051 U
Tetrachloroethene	0.5	1500	3300	2.7	0.0059 U	0.0051 U	0.0051 U	0.0048 U	0.0052 U	0.0051 U	0.0051 U
Toluene	100	10000	10000	46000	0.0059 U	0.0051 U	0.0051 U	0.0048 U	0.0052 U	0.0051 U	0.0051 U
trans-1,2-Dichloroethene	10	3700	4300	500	0.0059 U	0.0051 U	0.0051 U	0.0048 U	0.0052 U	0.0051 U	0.0051 U
trans-1,3-Dichloropropene	2.6	410	470	8.4	0.0059 U	0.0051 U	0.0051 U	0.0048 U	0.0052 U	0.0051 U	0.0051 U
Trichloroethene	0.5	970	1100	14	0.0059 U	0.0051 U	0.0051 U	0.0048 U	0.0052 U	0.0051 U	0.0051 U
Vinyl Chloride	0.2	53	220	1.7	0.0059 U	0.0051 U	0.0051 U	0.0048 U	0.0052 U	0.0051 U	0.0051 U
Xylenes (Total)	1000	10000	10000	2600	0.018 U	0.015 U	0.015 U	0.014 U	0.016 U	0.015 U	0.015 U

Blank results = analyte not analyzed. U = Not detected. J = Organics; estimated. Inorganics; blank contamination. B = Organics; blank contamination. Inorganics; estimated. E = Inorganics; matrix interference. \* = excavated location.

**Table 4.**  
**Soils Data Summary - Metal Chip Bin Area Confirmation Sampling**  
**Former York Naval Ordnance Plant - York, PA**

Location/ID Depth (ft.) Sample Date	MSC Soil to GW Used Aquifer (mg/kg)	MSC Direct Contact 0 - 2 ft (mg/kg)	MSC Direct Contact 2 - 15 ft (mg/kg)	EPA RSL Industrial Soil (mg/kg)	NPA-CS-007 Dup 3.5 - 4 8/4/2010	NPA-CS-008 1.5 - 2 8/4/2010	NPA-CS-009 3 - 3.5 8/4/2010	NPA-CS-010 1.5 - 2 8/4/2010	NPA-CS-011 3.5 - 4 8/4/2010	NPA-CS-012 1.5 - 2 8/4/2010
<b>Cyanide, Total</b>										
Cyanide, Total	200	56000	190000	20000	0.62 U	0.6 U	0.59 U	0.56 U	0.6 U	0.61 U
<b>Hexavalent Chromium</b>										
Hexavalent Chromium	190	420	190000	200	1.8	0.25 B	0.73	0.51	0.61	0.5
<b>Mercury</b>										
Mercury	10	840	190000	24	0.051	0.02 B	0.027 B	0.04	0.029 B	0.033 B
<b>Metal</b>										
Antimony	27	1100	190000	410	1.2 U	1.2 U	1.2 U	1.1 U	1.2 U	1.2 U
Arsenic	150	53	190000	1.6	2.7	1.5	1.8	5	3.3	3.5
Beryllium	320	5600	190000	2000	1.1	0.55	0.69	0.56	0.65	0.73
Cadmium	38	210	190000	800	0.62 U	0.6 U	0.59 U	0.56 U	0.6 U	0.61 U
Chromium				1400	11.4	10.9	11	10.2	10.2	10.2
Copper	36000	100000	190000	41000	3.8	5.6	5.7	6.8	5.6	4.9
Lead	450	1000	190000	800	10.1	10.4	9.4	10.4	9.5	10.8
Nickel	650	56000	190000	20000	3.3 B	2.9 B	2.5 B	3 B	2.3 B	2.8 B
Selenium	26	14000	190000	5100	0.62 U	0.6 U	0.59 U	0.56 U	0.36 B	0.61 U
Silver	84	14000	190000	5100	0.62 U	0.6 U	0.59 U	0.56 U	0.6 U	0.61 U
Thallium	14	200	190000	66	0.6 B	1.2 U	1.2 U	0.3 B	0.39 B	1.2 U
Zinc	12000	190000	190000	310000	9.6	7.9	7.5	8.2	7.2	7.9
<b>Polychlorinated Biphenols</b>										
Arochlor-1016	200	200	10000	21	0.02 U	0.02 U	0.02 U	0.019 U	0.02 U	0.02 U
Arochlor-1221	2.5	160	10000	0.62	0.02 U	0.02 U	0.02 U	0.019 U	0.02 U	0.02 U
Arochlor-1232	2	160	10000	0.62	0.02 U	0.02 U	0.02 U	0.019 U	0.02 U	0.02 U
Arochlor-1242	62	160	10000	0.74	0.02 U	0.02 U	0.02 U	0.019 U	0.02 U	0.02 U
Arochlor-1248	67	44	10000	0.74	0.02 U	0.02 U	0.02 U	0.019 U	0.02 U	0.02 U
Arochlor-1254	280	44	10000	0.74	0.02 U	0.067	0.02 U	0.019 U	0.02 U	0.02 U
Arochlor-1260	1900	130	190000	0.74	0.02 U	0.078	0.02 U	0.019 U	0.02 U	0.6

Blank results = analyte not analyzed. U = Not detected. J = Organics; estimated. Inorganics; blank contamination. B = Organics; blank contamination. Inorganics; estimated. E = Inorganics; matrix interference. \* = excavated location.

**Table 4.**  
**Soils Data Summary - Metal Chip Bin Area Confirmation Sampling**  
**Former York Naval Ordnance Plant - York, PA**

Location/ID Depth (ft.) Sample Date	MSC Soil to GW Used Aquifer (mg/kg)	MSC Direct Contact 0 - 2 ft (mg/kg)	MSC Direct Contact 2 - 15 ft (mg/kg)	EPA RSL Industrial Soil (mg/kg)	NPA-CS-007 Dup 3.5 - 4 8/4/2010	NPA-CS-008 1.5 - 2 8/4/2010	NPA-CS-009 3 - 3.5 8/4/2010	NPA-CS-010 1.5 - 2 8/4/2010	NPA-CS-011 3.5 - 4 8/4/2010	NPA-CS-012 1.5 - 2 8/4/2010
<b>Semi Volatile Organic Compound</b>										
1,2,4-Trichlorobenzene	27	10000	10000	400	0.4 U	0.39 U	0.39 U	0.37 U	0.39 U	0.027 J
1,2-Dichlorobenzene	60	10000	10000	10000	0.4 U	0.39 U	0.39 U	0.37 U	0.39 U	0.4 U
1,3-Dichlorobenzene	61	10000	10000		0.4 U	0.39 U	0.39 U	0.37 U	0.39 U	0.4 U
1,4-Dichlorobenzene	10	3300	190000	13	0.4 U	0.39 U	0.39 U	0.37 U	0.39 U	0.4 U
2,4,5-Trichlorophenol	6100	190000	190000	62000	0.4 U	0.39 U	0.39 U	0.37 U	0.39 U	0.4 U
2,4,6-Trichlorophenol	8.9	840	190000	160	0.4 U	0.39 U	0.39 U	0.37 U	0.39 U	0.4 U
2,4-Dichlorophenol	2	8400	190000	1800	0.4 U	0.39 U	0.39 U	0.37 U	0.39 U	0.4 U
2,4-Dimethylphenol	200	10000	10000	12000	0.4 U	0.39 U	0.39 U	0.37 U	0.39 U	0.4 U
2,4-Dinitrophenol	4.1	5600	190000	1200	2.1 U	2 U	2 U	1.9 U	2 U	2.1 U
2,4-Dinitrotoluene	0.84	260	190000	5.5	0.4 U	0.39 U	0.39 U	0.37 U	0.39 U	0.4 U
2,6-Dinitrotoluene	10	2800	190000	620	0.4 U	0.39 U	0.39 U	0.37 U	0.39 U	0.4 U
2-Chloronaphthalene	18000	190000	190000	82000	0.4 U	0.39 U	0.39 U	0.37 U	0.39 U	0.4 U
2-Chlorophenol	4.4	920	1100	5100	0.4 U	0.39 U	0.39 U	0.37 U	0.39 U	0.4 U
2-Methylnaphthalene	8000	10000	10000	4100	0.4 U	0.39 U	0.39 U	0.37 U	0.39 U	0.065 J
2-Methylphenol	510	10000	10000	31000	0.4 U	0.39 U	0.39 U	0.37 U	0.39 U	0.4 U
2-Nitroaniline	0.58	160	190000	1800	2.1 U	2 U	2 U	1.9 U	2 U	2.1 U
2-Nitrophenol	82	22000	190000		0.4 U	0.39 U	0.39 U	0.37 U	0.39 U	0.4 U
3,3'-Dichlorobenzidine	32	180	190000	3.8	1.9 U	1.9 U	1.9 U	1.8 U	1.9 U	2 U
3/4-Methylphenol				5100	0.4 U	0.39 U	0.39 U	0.37 U	0.39 U	0.4 U
3-Nitroaniline	0.58	160	190000		2.1 U	2 U	2 U	1.9 U	2 U	2.1 U
4,6-Dinitro-2-Methylphenol				62	2.1 U	2 U	2 U	1.9 U	2 U	2.1 U
4-Bromophenyl phenyl ether					0.4 U	0.39 U	0.39 U	0.37 U	0.39 U	0.4 U
4-Chloro-3-Methyl-Phenol	110	14000	190000		0.4 U	0.39 U	0.39 U	0.37 U	0.39 U	0.4 U
4-Chloroaniline	52	11000	190000	8.6	0.4 U	0.39 U	0.39 U	0.37 U	0.39 U	0.4 U
4-Chlorodiphenyl Ether					0.4 U	0.39 U	0.39 U	0.37 U	0.39 U	0.4 U
4-Nitroaniline	0.58	160	190000	86	2.1 U	2 U	2 U	1.9 U	2 U	2.1 U
4-Nitrophenol	6	22000	190000		2.1 U	2 U	2 U	1.9 U	2 U	2.1 U
Acenaphthene	4700	170000	190000	33000	0.4 U	0.035 J	0.39 U	0.37 U	0.39 U	0.47
Acenaphthylene	6900	170000	190000	33000	0.4 U	0.39 U	0.39 U	0.37 U	0.39 U	0.16 J
Anthracene	350	190000	190000	170000	0.4 U	0.02 J	0.078 J	0.37 U	0.39 U	6.1
Benzo (A) Anthracene	320	110	190000	2.1	0.4 U	0.033 J	0.39 U	0.37 U	0.39 U	3
Benzo (a) Pyrene	46	11	190000	0.21	0.4 U	0.018 J	0.39 U	0.37 U	0.39 U	0.84
Benzo (b) Fluoranthene	170	110	190000	2.1	0.4 U	0.026 J	0.39 U	0.37 U	0.39 U	1.6
Benzo (g,h,i) Perylene	180	170000	190000		0.4 U	0.39 U	0.39 U	0.37 U	0.39 U	0.25 J
Benzo (k) Fluoranthene	610	1100	190000	21	0.4 U	0.39 U	0.39 U	0.37 U	0.39 U	0.4 U
Bis(2-Chloroethoxy) Methane				1800	0.4 U	0.39 U	0.39 U	0.37 U	0.39 U	0.4 U
Bis(2-Chloroethyl) Ether	0.055	5	5.7	0.9	0.4 U	0.39 U	0.39 U	0.37 U	0.39 U	0.4 U
Bis(2-Chloroisopropyl) Ether	30	160	190	17	0.4 U	0.39 U	0.39 U	0.37 U	0.39 U	0.4 U
Bis(2-Ethylhexyl) Phthalate	130	5700	10000	120	0.4 U	0.39 U	0.39 U	0.37 U	0.39 U	0.4 U
Butylbenzylphthalate	10000	10000	10000	910	0.4 U	0.39 U	0.39 U	0.37 U	0.39 U	0.4 U
Carbazole	83	4000	190000		0.4 U	0.39 U	0.39 U	0.37 U	0.39 U	0.21 J
Chrysene	230	11000	190000	210	0.4 U	0.032 J	0.39 U	0.37 U	0.39 U	2.9
Dibenzo (a,h) Anthracene	160	11	190000	0.21	0.4 U	0.39 U	0.39 U	0.37 U	0.39 U	0.15 J
Dibenzofuran					0.4 U	0.39 U	0.39 U	0.37 U	0.39 U	0.49
Diethylphthalate	500	10000	10000	490000	0.049 J	0.39 U	0.39 U	0.37 U	0.39 U	0.4 U
Dimethylphthalate					0.4 U	0.39 U	0.39 U	0.37 U	0.39 U	0.4 U
Di-n-Butylphthalate	4100	10000	10000	62000	0.4 U	0.39 U	0.39 U	0.37 U	0.39 U	0.4 U
Di-n-octylphthalate	10000	10000	10000		0.4 U	0.39 U	0.39 U	0.37 U	0.39 U	0.4 U
Fluoranthene	3200	110000	190000	22000	0.4 U	0.11 J	0.45	0.37 U	0.39 U	14
Fluorene	3800	110000	190000	22000	0.4 U	0.031 J	0.39 U	0.37 U	0.39 U	1.6
Hexachlorobenzene	0.96	50	190000	1.1	0.4 U	0.39 U	0.39 U	0.37 U	0.39 U	0.4 U
Hexachlorobutadiene	1.2	560	10000	22	0.4 U	0.39 U	0.39 U	0.37 U	0.39 U	0.4 U
Hexachlorocyclopentadiene	91	10000	10000	3700	1.9 U	1.9 U	1.9 U	1.8 U	1.9 U	2 U
Hexachloroethane	0.56	2800	190000	120	0.4 U	0.39 U	0.39 U	0.37 U	0.39 U	0.4 U
Indeno (1,2,3-cd) Pyrene	28000	110	190000	2.1	0.4 U	0.39 U	0.39 U	0.37 U	0.39 U	0.28 J
Isophorone	10	10000	10000	1800	0.4 U	0.39 U	0.39 U	0.37 U	0.39 U	0.4 U
Naphthalene	25	56000	190000	20	0.4 U	0.39 U	0.39 U	0.37 U	0.39 U	0.027 J
Nitrobenzene	5.1	1400	10000	22	0.4 U	0.39 U	0.39 U	0.37 U	0.39 U	0.4 U
N-Nitrosodi-N-Propylamine	0.037	11	10000	0.25	0.4 U	0.39 U	0.39 U	0.37 U	0.39 U	0.4 U
N-Nitrosodiphenylamine	83	16000	190000	350	0.4 U	0.39 U	0.39 U	0.37 U	0.39 U	0.4 U
Pentachlorophenol	5	660	190000	9	1.9 U	1.9 U	1.9 U	1.8 U	1.9 U	2 U
Phenanthrene	10000	190000	190000		0.4 U	0.071 J	0.55	0.37 U	0.39 U	15
Phenol	400	190000	190000	180000	0.4 U	0.39 U	0.39 U	0.37 U	0.39 U	0.4 U
Pyrene	2200	84000	190000	17000	0.4 U	0.089 J	0.18 J	0.37 U	0.39 U	8.3

Blank results = analyte not analyzed. U = Not detected. J = Organics; estimated. Inorganics; blank contamination. B = Organics; blank contamination. Inorganics; estimated. E = Inorganics; matrix interference. \* = excavated location.

**Table 4.**  
**Soils Data Summary - Metal Chip Bin Area Confirmation Sampling**  
**Former York Naval Ordnance Plant - York, PA**

Location/ID Depth (ft.) Sample Date	MSC Soil to GW Used Aquifer (mg/kg)	MSC Direct Contact 0 - 2 ft (mg/kg)	MSC Direct Contact 2 - 15 ft (mg/kg)	EPA RSL Industrial Soil (mg/kg)	NPA-CS-007 Dup 3.5 - 4 8/4/2010	NPA-CS-008 1.5 - 2 8/4/2010	NPA-CS-009 3 - 3.5 8/4/2010	NPA-CS-010 1.5 - 2 8/4/2010	NPA-CS-011 3.5 - 4 8/4/2010	NPA-CS-012 1.5 - 2 8/4/2010
<b>Petroleum Hydrocarbons</b>										
N-Hexane Extractable Material					205 U	422	197 U	186 U	199 U	497
<b>Volatile Organic Compound</b>										
1,1,1,2-Tetrachloroethane	18	3100	190000	9.8	0.005 U	0.0048 U	0.0049 U	0.005 U	0.0051 U	0.0055 U
1,1,1-Trichloroethane	20	10000	10000	39000	0.005 U	0.0048 U	0.0049 U	0.005 U	0.0051 U	0.0055 U
1,1,2,2-Tetrachloroethane	0.03	28	33	2.9	0.005 U	0.0048 U	0.0049 U	0.005 U	0.0051 U	0.0055 U
1,1,2-Trichloroethane	0.5	100	120	5.5	0.005 U	0.0048 U	0.0049 U	0.005 U	0.0051 U	0.0055 U
1,1-Dichloroethane	11	1000	1200	17	0.005 U	0.0048 U	0.0049 U	0.005 U	0.0051 U	0.0055 U
1,1-Dichloroethene	0.7	33	38	1100	0.005 U	0.0048 U	0.0049 U	0.005 U	0.0051 U	0.0055 U
1,2-Dibromoethane	0.005	0.93	8.6	0.17	0.005 U	0.0048 U	0.0049 U	0.005 U	0.0051 U	0.0055 U
1,2-Dichloroethane	0.5	63	73	2.2	0.005 U	0.0048 U	0.0049 U	0.005 U	0.0051 U	0.0055 U
1,2-Dichloropropane	0.5	160	180	4.7	0.005 U	0.0048 U	0.0049 U	0.005 U	0.0051 U	0.0055 U
1,4-Dioxane	2.4	210	240	160	1 U	0.96 U	0.98 U	1 U	1 U	1.1 U
2-Butanone	580	10000	10000	190000	0.02 U	0.019 U	0.02 U	0.02 U	0.02 U	0.022 U
2-Hexanone					0.02 U	0.019 U	0.02 U	0.02 U	0.02 U	0.022 U
4-Methyl-2-Pentanone	41	4300	4900	52000	0.02 U	0.019 U	0.02 U	0.02 U	0.02 U	0.022 U
Acetone	1000	10000	10000	610000	0.0051 J	0.019 U	0.02 U	0.0087 J	0.02 U	0.015 J
Acrylonitrile	0.27	24	28	1.2	0.1 U	0.096 U	0.098 U	0.1 U	0.1 U	0.11 U
Benzene	0.5	210	240	5.6	0.005 U	0.0048 U	0.0049 U	0.005 U	0.0051 U	0.0055 U
Bromochloromethane	9	10000	10000		0.005 U	0.0048 U	0.0049 U	0.005 U	0.0051 U	0.0055 U
Bromodichloromethane	10	45	51	1.4	0.005 U	0.0048 U	0.0049 U	0.005 U	0.0051 U	0.0055 U
Bromoform	10	1500	1700	220	0.005 U	0.0048 U	0.0049 U	0.005 U	0.0051 U	0.0055 U
Bromomethane	1	270	300	35	0.005 U	0.0048 U	0.0049 U	0.005 U	0.0051 U	0.0055 U
Carbon Disulfide	410	10000	10000	3000	0.005 U	0.0048 U	0.0049 U	0.005 U	0.0051 U	0.0055 U
Carbon Tetrachloride	0.5	110	120	1.3	0.005 U	0.0048 U	0.0049 U	0.005 U	0.0051 U	0.0055 U
Chlorobenzene	10	10000	10000	1500	0.005 U	0.0048 U	0.0049 U	0.005 U	0.0051 U	0.0055 U
Chlorodibromomethane	10	61	70	3.4	0.005 U	0.0048 U	0.0049 U	0.005 U	0.0051 U	0.0055 U
Chloroethane	90	10000	10000	62000	0.005 U	0.0048 U	0.0049 U	0.005 U	0.0051 U	0.0055 U
Chloroform	10	17	19	1.5	0.005 U	0.0048 U	0.0049 U	0.005 U	0.0051 U	0.0055 U
Chloromethane	0.3	920	1000	510	0.005 U	0.0048 U	0.0049 U	0.005 U	0.0051 U	0.0055 U
cis-1,2-Dichloroethene	7	1900	2100	10000	0.005 U	0.0048 U	0.0049 U	0.005 U	0.0051 U	0.0055 U
cis-1,3-Dichloropropene	2.6	410	470	8.4	0.005 U	0.0048 U	0.0049 U	0.005 U	0.0051 U	0.0055 U
Ethylbenzene	70	10000	10000	29	0.005 U	0.0048 U	0.0049 U	0.005 U	0.0051 U	0.0055 U
Methyl tert-butyl ether	2	3200	3700	190	0.005 U	0.0048 U	0.0049 U	0.005 U	0.0051 U	0.0055 U
Methylene chloride	0.5	3500	4000	54	0.0029 J B	0.0029 J B	0.0029 J B	0.0028 J B	0.0027 J B	0.005 J B
Styrene	24	10000	10000	38000	0.005 U	0.0048 U	0.0049 U	0.005 U	0.0051 U	0.0055 U
Tetrachloroethene	0.5	1500	3300	2.7	0.005 U	0.0048 U	0.0049 U	0.005 U	0.0051 U	0.0055 U
Toluene	100	10000	10000	46000	0.005 U	0.0048 U	0.0049 U	0.005 U	0.0051 U	0.0055 U
trans-1,2-Dichloroethene	10	3700	4300	500	0.005 U	0.0048 U	0.0049 U	0.005 U	0.0051 U	0.0055 U
trans-1,3-Dichloropropene	2.6	410	470	8.4	0.005 U	0.0048 U	0.0049 U	0.005 U	0.0051 U	0.0055 U
Trichloroethene	0.5	970	1100	14	0.005 U	0.0048 U	0.0049 U	0.005 U	0.0051 U	0.0055 U
Vinyl Chloride	0.2	53	220	1.7	0.005 U	0.0048 U	0.0049 U	0.005 U	0.0051 U	0.0055 U
Xylenes (Total)	1000	10000	10000	2600	0.015 U	0.014 U	0.015 U	0.015 U	0.015 U	0.017 U

Blank results = analyte not analyzed. U = Not detected. J = Organics; estimated. Inorganics; blank contamination. B = Organics; blank contamination. Inorganics; estimated. E = Inorganics; matrix interference. \* = excavated location.

## **APPENDIX A**

### **Monitoring Well MW-52 and MW-53 Abandonment Records**

## WATER WELL COMPLETION REPORT

Well Driller: **EICHELBERGERS  
INC.**

Driller Well ID: **DS10035-  
MW52**

Driller License: **0198**

Local Permit #:

Type of Activity: **Well Abandonment** Original Well By: **Current Driller**

Reason for Abandonment: **Well was unused**

Date Drilled: **5/14/2010**

Drilling Method: **OTHER**

Owner: **Harley Davidson**

Address of Well: **1425 Eden road**

Zipcode: **17406**

County: **YORK**

Municipality:

Municipality Type:

Coordinate Method: **Commercial Street Atlas Program**

Quadrangle:

Latitude: **39.99267**

Longitude: **-76.71277**

Well Depth (ft): **30**

Well Finish:

Depth to Bedrock (ft):

Did Not Encounter Bedrock:

Well Yield (gpm):

Yield Measure Method:

Static Water Level:  
(ft below land surface)

Water level after yield test:  
(ft below land surface)

Length of Yield Test:  
(minutes)

Saltwater Zone (ft):

Use of Well: **MONITORING**

Use of Water: **UNUSED**

Description of Well Location and Other Notes:

**MATERIALS USED TO ABANDON 2" WELL: 282 LBS CEMENT; 25 LBS-BENSEAL; 18 GALLONS WATER; 40 LBS SAKRETE. METHOD OF ABANDONMENT; PUMPING THROUGH TREMIE PIPE FROM WELL BOTTOM.**

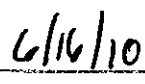

I hereby certify that the above information is true and complete to the best of my knowledge and belief.

---

Driller's Signature (required) Date

## WATER WELL COMPLETION REPORT

Well Driller: **EICHELBERGERS  
INC.**

Driller Well ID: **DS10035-  
MW53**

Driller License: **0198**

Local Permit #:

Type of Activity: **Well Abandonment** Original Well By: **Current Driller**

Reason for Abandonment: **Well was unused**

Date Drilled: **5/14/2010**

Drilling Method: **OTHER**

Owner: **Harley Davidson**

Address of Well: **1425 Eden Road**

Zipcode: **17406**

County: **YORK**

Municipality:

Municipality Type:

Coordinate Method: **Commercial Street Atlas Program**

Quadrangle:

Latitude: **39.99257**

Longitude: **-76.71255**

Well Depth (ft): **33**

Well Finish:

Depth to Bedrock (ft):

Did Not Encounter Bedrock:

Well Yield (gpm):

Yield Measure Method:

Static Water Level:  
(ft below land surface)

Water level after yield test:  
(ft below land surface)

Length of Yield Test:  
(minutes)

Saltwater Zone (ft):



Use of Well: **MONITORING**

Use of Water: **UNUSED**

Description of Well Location and Other Notes:

**MATERIALS USED TO ABANDON 2" WELL: 376 LBS-CEMENT; 25 LBS-BENSEAL;  
24 GALLONS WATER; 40 LBS SAKRETE. METHOD OF ABANDONMENT: PUMPING  
THROUGH TREMIE PIPE FROM WELL BOTTOM.**

I hereby certify that the above information is true and complete to the best of my knowledge and belief.

---

Driller's Signature (required) Date

## **APPENDIX B**

# **Demolition and Soil Removal Photographs**



View looking west at demolition areas for Bldgs 12, 43, 44, & 67 (Bldgs 42, 57 & 51 in background). Trackhoe is sitting on former Bldg 67.



View looking south at former metal chip bin area (partially demolished). Note concrete wall next to former railroad.





Views looking west from east side of new sedimentation pond (#3). Note pre-excitation conditions – Concrete walls, bins and platform have been removed from MCB. Dark area is former railroad – ties and rails removed.



View of oily liquid and black soil found during initial removed from former Metal Chip Bin area.





View looking south from railroad bed area just north of the former Metal Chip Bin area. Beginning of excavation – note oil on the water (see close-up below).







Views looking north toward railroad bed area just north of the former Metal Chip Bin area.



Views looking west along former railroad bed and metal chip bin area – excavation and stockpiling of contaminated soil.





View looking southwest at area of soil removal in MCB area.



View looking west along former railroad tracks, west of MCB (beneath former Bldg 44). Note N-S oriented exploratory test pits along RR bed path.





Looking west at test pits A, B, C, & D. Note location of former railroad tracks.



View of soil scanning and PID used during removal of impacted soil.





View looking southeast at excavation along hillside of former MCB area. Soil above contaminated zone was removed, stockpiled near Bldg 15 (below) and tested.



View of stockpile of suspect soil removed from the hillside of the metal chip bin area.





View looking west (above) and south (below) of final excavation limits at the MCB area.







View looking west of backfilling near former MCB area and construction of new stormwater detention pond.



View looking west at finish grades for new stormwater detention pond.

**APPENDIX C**

**Waste Disposal Manifests**



07 42431

### NON-HAZARDOUS WASTE MANIFEST

#### GENERATOR INFORMATION

Generator Name: Harley-Davidson Motor Co. Inc., Inc.

Address: 1425 Eden Road

City: York County: York

State: PA Zip: 17401

Site Location (if different): \_\_\_\_\_

#### CUSTOMER/BILLING INFORMATION

Billing Name: EC of Pennsylvania, Inc.

Address: 730 Vogelsons Road

City: York County: York

State: PA Zip: 17404

Republic Services Approval Number	Description of Waste	Volume/Weight	Expiration Date	Container Type
10 10670	Contaminated Soil-oilbris	30 Yd		DT
	(Please provide weight to generator)			
	York Remediation Trust Fund			

\*Attach Additional Sheet if necessary.

I hereby certify that the above described materials are non-hazardous wastes as defined by 40 CFR 261 or any applicable state law. Further, that the above named materials are properly classified, described, packaged, marked and labeled, and are in proper condition for transportation according to the applicable regulations of the Department of Transportation.

William R Fisher  
Generator/Authorized Agent Name

X [Signature]  
Signature

08-03-10  
Date Shipped

#### TRANSPORTER INFORMATION

Transporter Name: Enviroite of PA, Inc. DOT Number: PAD01G154045

Address: 730 Vogelsons Road Truck Number: 8075 TR 4297

York, PA 17404 Phone Number: 717-846-1900

I certify no hazardous waste or other regulated substance was knowingly introduced to the waste while in my custody. The waste transported in this vehicle is the waste identified above, to the best of my knowledge.

Allen Stolt  
Name of Authorized Agent

X [Signature]  
Signature

08-03-10  
Date Delivered

#### DISPOSAL SITE INFORMATION

Site Name: Modern Landfill Phone Number: 717-246-2686

Address: 4400 Mt. Pisgah Road, York, PA 17406

I hereby acknowledge receipt of the above described materials.

\_\_\_\_\_  
Name (Print or Type)

X [Signature]  
Signature

\_\_\_\_\_  
Date Received



07 42432

NON-HAZARDOUS WASTE MANIFEST

GENERATOR INFORMATION

Generator Name: Harley-Davidson Motor Co. Ops., Inc.

Address: 1425 Eden Road

City: York County: York

State: PA Zip: 17402

Site Location (if different):

CUSTOMER/BILLING INFORMATION

Billing Name: EQ of Pennsylvania, Inc.

Address: 730 Vogelsons Road

City: York County: York

State: PA Zip: 17402

Table with 5 columns: Republic Services Approval Number, Description of Waste, Volume/Weight, Expiration Date, Container Type. Row 1: 10 10670, Contaminated Soil-Debris, 324, 07. Row 2: (Please provide weight to generator). Row 3: York Remediation Trust Fund, 22.16.

\*Attach Additional Sheet if necessary.

I hereby certify that the above described materials are non-hazardous wastes as defined by 40 CFR 261 or any applicable state law. Further, that the above named materials are properly classified, described, packaged, marked and labeled, and are in proper condition for transportation according to the applicable regulations of the Department of Transportation.

Shaun R Fisher Generator/Authorized Agent Name, X Shaun R Fisher Signature, 08-03-10 Date Shipped

TRANSPORTER INFORMATION

Transporter Name: Envirite of PA, Inc. DOT Number: PAD010154045

Address: 730 Vogelsons Road York, PA 17404 Truck Number: 8015 TRC 1697

Phone Number: 717-446-1900

I certify no hazardous waste or other regulated substance was knowingly introduced to the waste while in my custody. The waste transported in this vehicle is the waste identified above, to the best of my knowledge.

Allen Short Name of Authorized Agent, X Allen Short Signature, 08-03-10 Date Delivered

DISPOSAL SITE INFORMATION

Site Name: Modern Landfill Phone Number: 717-246-2686

Address: 4400 Mt. Pisgah Road, York, PA 17406

I hereby acknowledge receipt of the above described materials.

Name (Print or Type), X Signature, Date Received



9/7/10



07 42433

### NON-HAZARDOUS WASTE MANIFEST

#### GENERATOR INFORMATION

Generator Name: Harley-Davidson Motor Co. Ops., Inc.  
 Address: 1425 Eden Road  
 City: York County: York  
 State: PA Zip: 17402

#### CUSTOMER/BILLING INFORMATION

Billing Name: EC of Pennsylvania, Inc.  
 Address: 730 Vogelsong Road Road  
 City: York County: York  
 State: PA Zip: 17404

Site Location (if different): \_\_\_\_\_

Republic Services Approval Number	Description of Waste	Volume/Weight	Expiration Date	Container Type
10 10670	Contaminated Soil-Debris (please provide weight to generator)	30 Y		DT
	York Remediation Trust Fund	21.34		

\*Attach Additional Sheet if necessary.

I hereby certify that the above described materials are non-hazardous wastes as defined by 40 CFR 261 or any applicable state law. Further, that the above named materials are properly classified, described, packaged, marked and labeled, and are in proper condition for transportation according to the applicable regulations of the Department of Transportation.

Sharon R Fisher Generator/Authorized Agent Name  
X [Signature] Signature  
08-03-10 Date Shipped

#### TRANSPORTER INFORMATION

Transporter Name: Enviroite of PA, Inc. DOT Number: PAD010154045  
 Address: 730 Vogelsong Road Truck Number: 8075 TRC 4037  
York, PA 17404 Phone Number: 717-846-1900

I certify no hazardous waste or other regulated substance was knowingly introduced to the waste while in my custody. The waste transported in this vehicle is the waste identified above, to the best of my knowledge.

Allen Short Name of Authorized Agent  
X [Signature] Signature  
08-03-10 Date Delivered

#### DISPOSAL SITE INFORMATION

Site Name: Modern Landfill Phone Number: 717-246-2686  
 Address: 4400 Mt. Pisgah Road, York, PA 17406

I hereby acknowledge receipt of the above described materials.

[Signature] Name (Print or Type)  
X [Signature] Signature  
2310 Date Received

Received 9/7/10



07 42434

### NON-HAZARDOUS WASTE MANIFEST

#### GENERATOR INFORMATION

Generator Name: Harley-Davidson Motor Co., Inc.  
 Address: 1425 Loen Road  
 City: York County: York  
 State: PA Zip: 17401  
 Site Location (if different): \_\_\_\_\_

#### CUSTOMER/BILLING INFORMATION

Billing Name: EC of Pennsylvania, Inc.  
 Address: 730 Vogelsony Road  
 City: York County: York  
 State: PA Zip: 17404

Republic Services Approval Number	Description of Waste	Volume/Weight	Expiration Date	Container Type
10-10670	Contaminated Soil-Debris (Please provide weight to generator)	7100		
	York Remediation Trust Fund			

\*Attach Additional Sheet if necessary.

I hereby certify that the above described materials are non-hazardous wastes as defined by 40 CFR 261 or any applicable state law. Further, that the above named materials are properly classified, described, packaged, marked and labeled, and are in proper condition for transportation according to the applicable regulations of the Department of Transportation.

Sharon R Fisher  Sharon R Fisher 08-04-10  
 Generator/Authorized Agent Name Signature Date Shipped

#### TRANSPORTER INFORMATION

Transporter Name: Envicite of PA, Inc. DOT Number: PAD010154045  
 Address: 730 Vogelsony Road Truck Number: 805 TRV 4097  
York, PA 17404 Phone Number: 717-846-1900

I certify no hazardous waste or other regulated substance was knowingly introduced to the waste while in my custody. The waste transported in this vehicle is the waste identified above, to the best of my knowledge.

Allen Short  Allen Short 08-04-10  
 Name of Authorized Agent Signature Date Delivered

#### DISPOSAL SITE INFORMATION

Site Name: Modern Landfill Phone Number: 717-246-2686  
 Address: 4400 Mt. Pisgah Road, York, PA 17406

I hereby acknowledge receipt of the above described materials.

\_\_\_\_\_  
 Name (Print or Type) Signature Date Received



**REPUBLIC**  
SERVICES, INC.

07 42437

**NON-HAZARDOUS WASTE MANIFEST**

**GENERATOR INFORMATION**

Generator Name: Harley-Davidson Motor Co. Cns., Inc.

Address: 1425 Eöen Road

City: York County: York

State: PA Zip: 17402

Site Location (if different): \_\_\_\_\_

**CUSTOMER/BILLING INFORMATION**

Billing Name: St. of Pennsylvania, Inc.

Address: 730 Vogelsons Road

City: York County: York

State: PA Zip: 17404

Republic Services Approval Number	Description of Waste	Volume/Weight	Expiration Date	Container Type
10 10670	Contaminated Soil-Debris	30 Y		DT
	(Please provide weight to Generator)			
		11 11		
	York Remediation Trust Fund			

\*Attach Additional Sheet if necessary.

I hereby certify that the above described materials are non-hazardous wastes as defined by 40 CFR 261 or any applicable state law. Further, that the above named materials are properly classified, described, packaged, marked and labeled, and are in proper condition for transportation according to the applicable regulations of the Department of Transportation.

Sharon R Fisher  
Generator/Authorized Agent Name

X Sharon R Fisher  
Signature

08-09-10  
Date Shipped

**TRANSPORTER INFORMATION**

Transporter Name: Envirite of PA, Inc. DOT Number: PAD010154045

Address: 730 Vogelsons Road Truck Number: 8075 TRK 41097

York, PA 17404 Phone Number: 717-846-1906

I certify no hazardous waste or other regulated substance was knowingly introduced to the waste while in my custody. The waste transported in this vehicle is the waste identified above, to the best of my knowledge.

Allen Short  
Name of Authorized Agent

X Allen Short  
Signature

08-09-10  
Date Delivered

**DISPOSAL SITE INFORMATION**

Site Name: Modern Landfill Phone Number: 717-246-2686

Address: 4400 Mt. Pisgah Road, York, PA 17406

I hereby acknowledge receipt of the above described materials.

\_\_\_\_\_  
Name (Print or Type)

X [Signature]  
Signature

\_\_\_\_\_  
Date Received

Received 9/7/10



07 42438

### NON-HAZARDOUS WASTE MANIFEST

#### GENERATOR INFORMATION

Generator Name: Harley-Davidson Motor Co. Const., Inc.  
 Address: 1425 Boen Road  
 City: York County: York  
 State: PA Zip: 17406

#### CUSTOMER/BILLING INFORMATION

Billing Name: EO of Pennsylvania, Inc.  
 Address: 730 Vogelsons Road  
 City: York County: York  
 State: PA Zip: 17404

Site Location (if different): \_\_\_\_\_

Republic Services Approval Number	Description of Waste	Volume/Weight	Expiration Date	Container Type
10 10670	Contaminated Soil-Debris	20 Y		DT
	(Please provide weight to generator)			
	York Remediation Trust Fund	18.3E		

\*Attach Additional Sheet if necessary.

I hereby certify that the above described materials are non-hazardous wastes as defined by 40 CFR 261 or any applicable state law. Further, that the above named materials are properly classified, described, packaged, marked and labeled, and are in proper condition for transportation according to the applicable regulations of the Department of Transportation.

Sharon R Fisher  Sharon R Fisher 08-09-10  
 Generator/Authorized Agent Name Signature Date Shipped

#### TRANSPORTER INFORMATION

Transporter Name: Enviroite of PA, Inc. DOT Number: PA0010152025  
 Address: 730 Vogelsons Road Truck Number: 8075 TR 4097  
York, PA 17404 Phone Number: 717-246-1400

I certify no hazardous waste or other regulated substance was knowingly introduced to the waste while in my custody. The waste transported in this vehicle is the waste identified above, to the best of my knowledge.

Allen Short  Allen Short 08-09-10  
 Name of Authorized Agent Signature Date Delivered

#### DISPOSAL SITE INFORMATION

Site Name: Modern Landfill Phone Number: 717-246-2686  
 Address: 4400 Mt. Pisgah Road, York, PA 17406

I hereby acknowledge receipt of the above described materials.

\_\_\_\_\_  
 Name (Print or Type) Signature Date Received



07 42439

### NON-HAZARDOUS WASTE MANIFEST

#### GENERATOR INFORMATION

Generator Name: Harley-Davidson Motor Co. Gms., Inc.

Address: 1425 Eden Road

City: York County: York

State: PA Zip: 17402

Site Location (if different): \_\_\_\_\_

#### CUSTOMER/BILLING INFORMATION

Billing Name: EO of Pennsylvania, Inc.

Address: 730 Vogelson Road

City: York County: York

State: PA Zip: 17404

Republic Services Approval Number	Description of Waste	Volume/Weight	Expiration Date	Container Type
10 10570	Contaminated Soil-Debris	20Y		DT
	(Please provide weight to generator)	(360)		
	York Remediation Trust Fund			

\*Attach Additional Sheet if necessary.

I hereby certify that the above described materials are non-hazardous wastes as defined by 40 CFR 261 or any applicable state law. Further, that the above named materials are properly classified, described, packaged, marked and labeled, and are in proper condition for transportation according to the applicable regulations of the Department of Transportation.

Sharon R Fisher  
Generator/Authorized Agent Name

X Sharon R Fisher  
Signature

08-04-10  
Date Shipped

#### TRANSPORTER INFORMATION

Transporter Name: Enviroite of PA, Inc. DOT Number: PA0010154045

Address: 730 Vogelson Road Truck Number: 9075 TRK 1/5971

York, PA 17404 Phone Number: 717-846-1900

I certify no hazardous waste or other regulated substance was knowingly introduced to the waste while in my custody. The waste transported in this vehicle is the waste identified above, to the best of my knowledge.

Allen Slett  
Name of Authorized Agent

X Allen Slett  
Signature

08-04-10  
Date Delivered

#### DISPOSAL SITE INFORMATION

Site Name: Modern Landfill Phone Number: 717-246-2686

Address: 4400 Mt. Pisgah Road, York, PA 17406

I hereby acknowledge receipt of the above described materials.

\_\_\_\_\_  
Name (Print or Type)

X  
Signature

1/14  
Date Received



07 42440

### NON-HAZARDOUS WASTE MANIFEST

#### GENERATOR INFORMATION

Generator Name: Harley-Davidson Motor Co. Ops., Inc.  
 Address: 1425 Eden Road  
 City: York County: York  
 State: PA Zip: 17402

#### CUSTOMER/BILLING INFORMATION

Billing Name: EL of Pennsylvania, Inc.  
 Address: 730 Vogelsong Road  
 City: York County: York  
 State: PA Zip: 17404

Site Location (if different): \_\_\_\_\_  
 \_\_\_\_\_

Republic Services Approval Number	Description of Waste	Volume/Weight	Expiration Date	Container Type
10 10670	Contaminated Soil-Debris	304		DT
	(Please provide weight to generator)	200		
	York Remediation Trust Fund			

\*Attach Additional Sheet if necessary.

I hereby certify that the above described materials are non-hazardous wastes as defined by 40 CFR 261 or any applicable state law. Further, that the above named materials are properly classified, described, packaged, marked and labeled, and are in proper condition for transportation according to the applicable regulations of the Department of Transportation.

Sharon R. Fisher Generator/Authorized Agent Name  
X Sharon R. Fisher Signature  
08-04-10 Date Shipped

#### TRANSPORTER INFORMATION

Transporter Name: Enviroite of PA, Inc. DOT Number: PA1010154045  
 Address: 730 Vogelsong Road Truck Number: 2075 TPL 4097  
York, PA 17404 Phone Number: 717-846-1300

I certify no hazardous waste or other regulated substance was knowingly introduced to the waste while in my custody. The waste transported in this vehicle is the waste identified above, to the best of my knowledge.

Allen Skolt Name of Authorized Agent  
X Allen Skolt Signature  
08-04-10 Date Delivered

#### DISPOSAL SITE INFORMATION

Site Name: Modern Landfill Phone Number: 717-246-2686  
 Address: 4400 Mt. Pisgah Road, York, PA 17406

I hereby acknowledge receipt of the above described materials.

X Signature  
 \_\_\_\_\_ Date Received



07 42442

### NON-HAZARDOUS WASTE MANIFEST

#### GENERATOR INFORMATION

Generator Name: Harley-Davidson Motor Co. Ops., Inc.  
 Address: 1421 Green Road  
 City: York County: York  
 State: PA Zip: 17402  
 Site Location (if different): \_\_\_\_\_

#### CUSTOMER/BILLING INFORMATION

Billing Name: EQ of Pennsylvania, Inc.  
 Address: 730 Vogelons Road  
 City: York County: York  
 State: PA Zip: 17404

Republic Services Approval Number	Description of Waste	Volume/Weight	Expiration Date	Container Type
10 10692	Contaminated Soil-Debris			
	(Please provide weight to generator)	1811		
	York Remediation Trust Fund			

\*Attach Additional Sheet if necessary.

I hereby certify that the above described materials are non-hazardous wastes as defined by 40 CFR 261 or any applicable state law. Further, that the above named materials are properly classified, described, packaged, marked and labeled, and are in proper condition for transportation according to the applicable regulations of the Department of Transportation.

[Signature] Generator/Authorized Agent Name      X [Signature] Signature      08-10-10 Date Shipped

#### TRANSPORTER INFORMATION

Transporter Name: Enviroite of PA, Inc. DOT Number: PAD01G154045  
 Address: 730 Vogelons Road Truck Number: 8077-4002  
York, PA 17404 Phone Number: 717-846-1900

I certify no hazardous waste or other regulated substance was knowingly introduced to the waste while in my custody. The waste transported in this vehicle is the waste identified above, to the best of my knowledge.

[Signature] Name of Authorized Agent      X [Signature] Signature      8-5-10 Date Delivered

#### DISPOSAL SITE INFORMATION

Site Name: Modern Landfill Phone Number: 717-246-2686  
 Address: 4400 Mt. Pisgah Road, York, PA 17406

I hereby acknowledge receipt of the above described materials.

[Signature] Name (Print or Type)      X [Signature] Signature      \_\_\_\_\_ Date Received



# NON-HAZARDOUS SPECIAL WASTE & ASBESTOS MANIFEST

7/1/10

Modern Landfill  
4400 Mt. Pisgah Rd.  
York, PA 17406  
717-246-2686

If waste is asbestos waste, complete Sections I, II, III and IV  
If waste is **NOT** asbestos waste, complete Sections I, II and III

09-03003

## I. GENERATOR (Generator completes Ia-r)

a. Generator's US EPA ID Number PAD001643691		b. Manifest Document Number 09-03003		c. Page 1 of 1		
d. Generator's Name and Location: Harley-Davidson Motor Co. Ops., Inc. 1425 Eden Road York, PA 17402 f. Phone: 717-848-1177			e. Generator's Mailing Address:  Same			
g. Phone:			g. Phone:			
If owner of the generating facility differs from the generator, provide:			i. Owner's Phone No.:			
h. Owner's Name:			i. Owner's Phone No.:			
j. Waste Profile #	k. Exp. Date	l. Waste Shipping Name and Description	m. Containers No.	m. Containers Type	n. Total Quantity	o. Unit Wt/Vol
10 10670	7/13/2011	Contaminated Soil-Debris	1	DR	1 30Y 1E3E	
GENERATOR'S CERTIFICATION: I hereby certify that the above named material is not a hazardous waste as defined by 40 CFR 261 or any applicable state law, has been properly described, classified and packaged, and is in proper condition for transportation according to applicable regulations; AND, if this waste is a treatment residue of a previously restricted hazardous waste subject to the Land Disposal Restrictions. I certify and warrant that the waste has been treated in accordance with the requirements of 40 CFR 268 and is no longer a hazardous waste as defined by 40 CFR 261.						
p. Generator Authorized Agent Name (Print) Sharon R Fisher		q. Signature <i>Sharon R Fisher</i>		r. Date 08-05-10		

## II. TRANSPORTER (Generator completes IIa-b and Transporter completes IIc-e)

a. Transporter's Name and Address: Envirite of Pennsylvania, Inc. 730 Vogelsong Road York, PA 17404 b. Phone: 717-846-1900		
c. Driver Name (Print) <i>Ronald H. Hunsaker</i>	d. Signature <i>Ronald H. Hunsaker</i>	e. Date 08-05-10

## III. DESTINATION (Generator complete IIIa-c and Destination Site completes IIId-g)

a. Disposal Facility and Site Address: Modern Landfill 4400 Mt. Pisgah Road, York, PA 17406 b. Phone: 717-246-2686		c. US EPA Number PAD 987395803	d. Discrepancy Indication Space:
I hereby certify that the above named material has been accepted and to the best of my knowledge the foregoing is true and accurate.			
e. Name of Authorized Agent (Print)	f. Signature <i>(Signature)</i>	g. Date 8/5/10	

## IV. ASBESTOS (Generator completes IVa-f and Operator complete IVg-i)

a. Operator's Name and Address:		c. Responsible Agency Name and Address:	
b. Phone:		d. Phone:	
e. Special Handling Instructions and Additional Information:			
f. <input type="checkbox"/> Friable <input type="checkbox"/> Non-Friable <input type="checkbox"/> Both % Friable % Non-Friable			
OPERATOR'S CERTIFICATION: I hereby declare that the contents of this consignment are fully and accurately described above by proper shipping name and are classified, packed, marked and labeled and are in all respects in proper condition for transport by highway according to applicable international and national governmental regulations.			
g. Operator's Name and Title (Print)		i. Date	
h. Signature		i. Date	
*Operator refers to the company which owns, leases, operates, controls, or supervises the facility being demolished or renovated, or the demolition or renovation operation or both			





# NON-HAZARDOUS SPECIAL WASTE & ASBESTOS MANIFEST

7/1/10

Modern Landfill  
4400 Mt. Pisgah Rd.  
York, PA 17406  
717-246-2686

If waste is asbestos waste, complete Sections I, II, III and IV  
If waste is NOT asbestos waste, complete Sections I, II and III

09-03005

### I. GENERATOR (Generator completes Ia-r)

a. Generator's US EPA ID Number PAD001643691		b. Manifest Document Number 09-03005		c. Page 1 of 1	
d. Generator's Name and Location: Harley-Davidson Motor Co. Ops., Inc. 1425 Eden Road York, PA 17402			e. Generator's Mailing Address: Same		
f. Phone: 717-848-1177			g. Phone:		
If owner of the generating facility differs from the generator, provide:					
h. Owner's Name:			i. Owner's Phone No.:		
j. Waste Profile #	k. Exp. Date	l. Waste Shipping Name and Description		m. Containers No.	n. Total Quantity
				Type	o. Unit Wt/Vol
10 10670	7/13/2011	Contaminated Soil-Debris		30CY	1741
GENERATOR'S CERTIFICATION: I hereby certify that the above named material is not a hazardous waste as defined by 40 CFR 261 or any applicable state law, has been properly described, classified and packaged, and is in proper condition for transportation according to applicable regulations; AND, if this waste is a treatment residue of a previously restricted hazardous waste subject to the Land Disposal Restrictions. I certify and warrant that the waste has been treated in accordance with the requirements of 40 CFR 268 and is no longer a hazardous waste as defined by 40 CFR 261.					
p. Generator Authorized Agent Name (Print) Sharon R. Fichter		q. Signature <i>Sharon R. Fichter</i>		r. Date 08-5-10	

### II. TRANSPORTER (Generator completes IIa-b and Transporter completes IIc-e)

a. Transporter's Name and Address: Enviroite of Pennsylvania, Inc. 730 Vogelsong Road York, PA 17404			8077 4002		
b. Phone: <del>717-848</del> 717-846-1900					
c. Driver Name (Print) Corder Hughes		d. Signature <i>Corder Hughes</i>		e. Date 8-5-10	

### III. DESTINATION (Generator complete IIIa-c and Destination Site completes III d-g)

a. Disposal Facility and Site Address: Modern Landfill 4400 Mt. Pisgah Road York, PA 17406		c. US EPA Number PAD 987395803	d. Discrepancy Indication Space:
b. Phone: 717-246-2686			
I hereby certify that the above named material has been accepted and to the best of my knowledge the foregoing is true and accurate.			
e. Name of Authorized Agent (Print)		f. Signature <i>[Signature]</i>	g. Date 8-5-10

### IV. ASBESTOS (Generator completes IVa-f and Operator complete IVg-i)

a. Operator's Name and Address:		c. Responsible Agency Name and Address:	
b. Phone:		d. Phone:	
e. Special Handling Instructions and Additional Information:			
f. <input type="checkbox"/> Friable <input type="checkbox"/> Non-Friable <input type="checkbox"/> Both % Friable % Non-Friable			
OPERATOR'S CERTIFICATION: I hereby declare that the contents of this consignment are fully and accurately described above by proper shipping name and are classified, packed, marked and labeled and are in all respects in proper condition for transport by highway according to applicable international and national governmental regulations.			
g. Operator's Name and Title (Print)		h. Signature	
		i. Date	
*Operator refers to the company which owns, leases, operates, controls, or supervises the facility being demolished or renovated, or the demolition or renovation operation or both			



# NON-HAZARDOUS SPECIAL WASTE & ASBESTOS MANIFEST

711710

Modern Landfill  
4400 Mt. Pisgah Rd.  
York, PA 17406  
717-246-2686

If waste is asbestos waste, complete Sections I, II, III and IV  
If waste is NOT asbestos waste, complete Sections I, II and III

09-03006

## I. GENERATOR (Generator completes Ia-r)

a. Generator's US EPA ID Number PAD001643691		b. Manifest Document Number 09-03006		c. Page 1 of 1	
d. Generator's Name and Location: Harley-Davidson Motor Co. Ops., Inc. 1425 Eden Road York, PA 17402			e. Generator's Mailing Address:  Same		
f. Phone: 717-848-1177			g. Phone:		
If owner of the generating facility differs from the generator, provide:					
h. Owner's Name:			i. Owner's Phone No.:		
j. Waste Profile #	k. Exp. Date	l. Waste Shipping Name and Description	m. Containers No.	m. Containers Type	n. Total Quantity
10 10670	7/13/2011	Contaminated Soil-Debris		30CY	
GENERATOR'S CERTIFICATION: I hereby certify that the above named material is not a hazardous waste as defined by 40 CFR 261 or any applicable state law, has been properly described, classified and packaged, and is in proper condition for transportation according to applicable regulations; AND, if this waste is a treatment residue of a previously restricted hazardous waste subject to the Land Disposal Restrictions. I certify and warrant that the waste has been treated in accordance with the requirements of 40 CFR 268 and is no longer a hazardous waste as defined by 40 CFR 261.					
p. Generator Authorized Agent Name (Print) Sharon R Fisher			q. Signature <i>Sharon R Fisher</i>		r. Date 08-05-10

## II. TRANSPORTER (Generator completes IIa-b and Transporter completes IIc-e)

a. Transporter's Name and Address: Envirite of Pennsylvania, Inc. 730 Vogelsong Road York, PA 17404		
b. Phone: 717-846-1900		
c. Driver Name (Print) KORSAUS HOLLAND	d. Signature <i>Sharon R Fisher</i>	e. Date 8-05-10

## III. DESTINATION (Generator complete IIIa-c and Destination Site completes III d-g)

a. Disposal Facility and Site Address: Modern Landfill 4400 Mt. Pisgah Road, York, PA 17406		b. Phone: 717-246-2686	c. US EPA Number 99 PA 6 PAD#7395803 PAD#7395803	d. Discrepancy Indication Space:  C1 8510
I hereby certify that the above named material has been accepted and to the best of my knowledge the foregoing is true and accurate.				
e. Name of Authorized Agent (Print)		f. Signature		g. Date

## IV. ASBESTOS (Generator completes IVa-f and Operator complete IVg-i)

a. Operator's Name and Address:		c. Responsible Agency Name and Address:		
b. Phone:		d. Phone:		
e. Special Handling Instructions and Additional Information:				
f. <input type="checkbox"/> Friable <input type="checkbox"/> Non-Friable <input type="checkbox"/> Both % Friable % Non-Friable				
OPERATOR'S CERTIFICATION: I hereby declare that the contents of this consignment are fully and accurately described above by proper shipping name and are classified, packed, marked and labeled and are in all respects in proper condition for transport by highway according to applicable international and national governmental regulations.				
g. Operator's Name and Title (Print)		h. Signature		i. Date
*Operator refers to the company which owns, leases, operates, controls, or supervises the facility being demolished or renovated, or the demolition or renovation operation or both				



# NON-HAZARDOUS SPECIAL WASTE & ASBESTOS MANIFEST

717/10

Modern Landfill  
4400 Mt. Pisgah Rd.  
York, PA 17406  
717-246-2686

If waste is asbestos waste, complete Sections I, II, III and IV  
If waste is **NOT** asbestos waste, complete Sections I, II and III

09-03007

### I. GENERATOR (Generator completes Ia-r)

a. Generator's US EPA ID Number PAD001643691		b. Manifest Document Number 09-03007		c. Page 1 of 1	
d. Generator's Name and Location: Harley-Davidson Motor Co. Ops., Inc. 1425 Eden Road York, PA 17402			e. Generator's Mailing Address:  Same		
f. Phone: 717-848-1177			g. Phone:		
If owner of the generating facility differs from the generator, provide:					
h. Owner's Name:			i. Owner's Phone No.:		
j. Waste Profile #	k. Exp. Date	l. Waste Shipping Name and Description	m. Containers No.	m. Containers Type	n. Total Quantity
10 10670	7/13/2011	Contaminated Soil-Debris		30CY	2052

GENERATOR'S CERTIFICATION: I hereby certify that the above named material is not a hazardous waste as defined by 40 CFR 261 or any applicable state law, has been properly described, classified and packaged, and is in proper condition for transportation according to applicable regulations; AND, if this waste is a treatment residue of a previously restricted hazardous waste subject to the Land Disposal Restrictions. I certify and warrant that the waste has been treated in accordance with the requirements of 40 CFR 268 and is no longer a hazardous waste as defined by 40 CFR 261.

p. Generator Authorized Agent Name (Print) Shearon R Fisher	q. Signature <i>Shearon R Fisher</i>	r. Date 08-5-10
--	---	--------------------

### II. TRANSPORTER (Generator completes IIa-b and Transporter completes IIc-e)

a. Transporter's Name and Address: Envirite of Pennsylvania, Inc. 730 Vogelsong Road York, PA 17404			8077 4002
b. Phone: 717-845-1900			
c. Driver Name (Print) Gordon Hughes	d. Signature <i>Gordon Hughes</i>	e. Date 8-5-10	

### III. DESTINATION (Generator complete IIIa-c and Destination Site completes IIId-g)

a. Disposal Facility and Site Address: Modern Landfill 4400 Mt. Pisgah York, PA 17406		c. US EPA Number PAD987395803	d. Discrepancy Indication Space:
b. Phone: <del>717-845-1900</del> 717-246-2686			
I hereby certify that the above named material has been accepted and to the best of my knowledge the foregoing is true and accurate.			
e. Name of Authorized Agent (Print)	f. Signature <i>[Signature]</i>	g. Date 8/5/10	

### IV. ASBESTOS (Generator completes IVa-f and Operator complete IVg-i)

a. Operator's Name and Address:		c. Responsible Agency Name and Address:	
b. Phone:		d. Phone:	
e. Special Handling Instructions and Additional Information:			
f. <input type="checkbox"/> Friable <input type="checkbox"/> Non-Friable <input type="checkbox"/> Both      % Friable      % Non-Friable			
OPERATOR'S CERTIFICATION: I hereby declare that the contents of this consignment are fully and accurately described above by proper shipping name and are classified, packed, marked and labeled and are in all respects in proper condition for transport by highway according to applicable international and national governmental regulations.			
g. Operator's Name and Title (Print)		i. Date	
h. Signature			

\*Operator refers to the company which owns, leases, operates, controls, or supervises the facility being demolished or renovated, or the demolition or renovation operation or both



Modern Landfill  
4400 Mt. Pisgah Rd.  
York, PA 17406  
717-246-2686

**NON-HAZARDOUS SPECIAL WASTE & ASBESTOS MANIFEST**

7/110

If waste is asbestos waste, complete Sections I, II, III and IV  
If waste is NOT asbestos waste, complete Sections I, II and III

527

09-03009

**I. GENERATOR (Generator completes Ia-r)**

a. Generator's US EPA ID Number PAD061643691		b. Manifest Document Number 09-03009		c. Page 1 of 1		
d. Generator's Name and Location: Harley-Davidson Motor Co. Ops., Inc. 1425 Eden Road York, PA 17402			e. Generator's Mailing Address: Same			
f. Phone: 717-548-1177			g. Phone:			
If owner of the generating facility differs from the generator, provide:						
h. Owner's Name:			i. Owner's Phone No.:			
j. Waste Profile #	k. Exp. Date	l. Waste Shipping Name and Description	m. Containers No.	m. Containers Type	n. Total Quantity	o. Unit Wt/Vol
10 10670	7/13/2011	Contaminated Soil-Debris		30CY	225	
GENERATOR'S CERTIFICATION: I hereby certify that the above named material is not a hazardous waste as defined by 40 CFR 261 or any applicable state law, has been properly described, classified and packaged, and is in proper condition for transportation according to applicable regulations; AND, if this waste is a treatment residue of a previously restricted hazardous waste subject to the Land Disposal Restrictions. I certify and warrant that the waste has been treated in accordance with the requirements of 40 CFR 268 and is no longer a hazardous waste as defined by 40 CFR 261.						
p. Generator Authorized Agent Name (Print) Sharon R Fisher			q. Signature <i>Sharon R Fisher</i>		r. Date 08-25-10	

**II. TRANSPORTER (Generator completes IIa-b and Transporter completes IIc-e)**

a. Transporter's Name and Address: Envirite of Pennsylvania, Inc. 730 Vogelsong Road York, PA 17404		
b. Phone: 717-846-1900		
c. Driver Name (Print) HOWARD HOLLAND	d. Signature <i>Howard Holland</i>	e. Date 8-05-10

**III. DESTINATION (Generator complete IIIa-c and Destination Site completes IIId-g)**

a. Disposal Facility and Site Address: Modern Landfill 4400 Mt. Pisgah Road York, PA 17406		c. US EPA Number PAD987395803	d. Discrepancy Indication Space:
b. Phone: 717-246-2686			
I hereby certify that the above named material has been accepted and to the best of my knowledge the foregoing is true and accurate.			
e. Name of Authorized Agent (Print)		f. Signature <i>[Signature]</i>	g. Date 8/5/10

**IV. ASBESTOS (Generator completes IVa-f and Operator complete IVg-i)**

a. Operator's Name and Address:		c. Responsible Agency Name and Address:	
b. Phone:		d. Phone:	
e. Special Handling Instructions and Additional Information:			
f. <input type="checkbox"/> Friable <input type="checkbox"/> Non-Friable <input type="checkbox"/> Both % Friable % Non-Friable			
OPERATOR'S CERTIFICATION: I hereby declare that the contents of this consignment are fully and accurately described above by proper shipping name and are classified, packed, marked and labeled and are in all respects in proper condition for transport by highway according to applicable international and national governmental regulations.			
g. Operator's Name and Title (Print)		h. Signature	
		i. Date	
*Operator refers to the company which owns, leases, operates, controls, or supervises the facility being demolished or renovated, or the demolition or renovation operation or both			



**NON-HAZARDOUS SPECIAL WASTE & ASBESTOS MANIFEST**

11/11/10

Modern Landfill  
4400 Mt. Pisgah Rd.  
York, PA 17406  
717-246-2686

If waste is asbestos waste, complete Sections I, II, III and IV  
If waste is NOT asbestos waste, complete Sections I, II and III

09-03010

**I. GENERATOR (Generator completes Ia-r)**

a. Generator's US EPA ID Number PAD001643691		b. Manifest Document Number 09-03010		c. Page 1 of 1		
d. Generator's Name and Location: Harley-Davidson Motor Co. Ops., Inc. 1425 Eden Road York, PA 17402			e. Generator's Mailing Address: Same			
f. Phone: 717-848-1177			g. Phone:			
If owner of the generating facility differs from the generator, provide:						
h. Owner's Name:			i. Owner's Phone No.:			
j. Waste Profile #	k. Exp. Date	l. Waste Shipping Name and Description	m. Containers No.	m. Containers Type	n. Total Quantity	o. Unit Wt/Vol
10 10670	7/13/2011	Contaminated Soil-Debris		30CY		
Field # 84407	20.14	ton				
GENERATOR'S CERTIFICATION: I hereby certify that the above named material is not a hazardous waste as defined by 40 CFR 261 or any applicable state law, has been properly described, classified and packaged, and is in proper condition for transportation according to applicable regulations; AND, if this waste is a treatment residue of a previously restricted hazardous waste subject to the Land Disposal Restrictions. I certify and warrant that the waste has been treated in accordance with the requirements of 40 CFR 268 and is no longer a hazardous waste as defined by 40 CFR 261.						
p. Generator Authorized Agent Name (Print) Sharon R Fisher		q. Signature <i>Sharon R Fisher</i>		r. Date 08-05-10		

**II. TRANSPORTER (Generator completes IIa-b and Transporter completes IIc-e)**

a. Transporter's Name and Address: Envirite of Pennsylvania, Inc. 730 Vogelsong Road York, PA 17404			8077 400L		
b. Phone: 717-846-1900					
c. Driver Name (Print) Gordon Hughes		d. Signature <i>Gordon Hughes</i>		e. Date 8-5-10	

**III. DESTINATION (Generator complete IIIa-c and Destination Site completes IIId-g)**

a. Disposal Facility and Site Address: Modern Landfill 4400 Mt. Pisgah Road York, PA 17406		c. US EPA Number PAD987395803	d. Discrepancy Indication Space:
b. Phone: 717-246-2686			
I hereby certify that the above named material has been accepted and to the best of my knowledge the foregoing is true and accurate.			
e. Name of Authorized Agent (Print)		f. Signature <i>[Signature]</i>	g. Date 8/5/10

**IV. ASBESTOS (Generator completes IVa-f and Operator complete IVg-i)**

a. Operator's Name and Address:		c. Responsible Agency Name and Address:	
b. Phone:		d. Phone:	
e. Special Handling Instructions and Additional Information:			
f. <input type="checkbox"/> Friable <input type="checkbox"/> Non-Friable <input type="checkbox"/> Both % Friable % Non-Friable			
OPERATOR'S CERTIFICATION: I hereby declare that the contents of this consignment are fully and accurately described above by proper shipping name and are classified, packed, marked and labeled and are in all respects in proper condition for transport by highway according to applicable international and national governmental regulations.			
g. Operator's Name and Title (Print)		h. Signature	
		i. Date	
*Operator refers to the company which owns, leases, operates, controls, or supervises the facility being demolished or renovated, or the demolition or renovation operation or both			

Modern Landfill  
4400 Mt. Pisgah Rd.  
York, PA 17406  
717-246-2686

If waste is asbestos waste, complete Sections I, II, III and IV  
If waste is **NOT** asbestos waste, complete Sections I, II and III

09-03011

**I. GENERATOR (Generator completes Ia-r)**

a. Generator's US EPA ID Number PAD001643691		b. Manifest Document Number 09-03011		c. Page 1 of 1		
d. Generator's Name and Location: Harley-Davidson Motor Co. Ops., Inc. 1425 Eden Road York, PA 17402			e. Generator's Mailing Address: Same			
f. Phone: 717-648-1177			g. Phone:			
If owner of the generating facility differs from the generator, provide:						
h. Owner's Name:			i. Owner's Phone No.:			
j. Waste Profile #	k. Exp. Date	l. Waste Shipping Name and Description	m. Containers No.	m. Containers Type	n. Total Quantity	o. Unit Wt/Vol
10 10570	7/13/2011	Contaminated Soil-Debris		30CY		
Field # 84416	22.01	107				
GENERATOR'S CERTIFICATION: I hereby certify that the above named material is not a hazardous waste as defined by 40 CFR 261 or any applicable state law, has been properly described, classified and packaged, and is in proper condition for transportation according to applicable regulations; AND, if this waste is a treatment residue of a previously restricted hazardous waste subject to the Land Disposal Restrictions. I certify and warrant that the waste has been treated in accordance with the requirements of 40 CFR 268 and is no longer a hazardous waste as defined by 40 CFR 261.						
p. Generator Authorized Agent Name (Print) Sharon R Fisher		q. Signature <i>Sharon R Fisher</i>		r. Date 08-05-10		

**II. TRANSPORTER (Generator completes IIa-b and Transporter completes IIc-e)**

a. Transporter's Name and Address: Enviroite of Pennsylvania, Inc. 730 Vogel song Road York, PA 17404		
b. Phone: 717-946-1900		
c. Driver Name (Print) KONRAD HOLLAND	d. Signature <i>Konrad Holland</i>	e. Date 8-05-10

**III. DESTINATION (Generator complete IIIa-c and Destination Site completes III d-g)**

a. Disposal Facility and Site Address: Modern Landfill 4400 Mt. Pisgah Road York, PA 17406		b. Phone: 717-246-2686	c. US EPA Number PAD987395803	d. Discrepancy Indication Space:
I hereby certify that the above named material has been accepted and to the best of my knowledge, the foregoing is true and accurate.				
e. Name of Authorized Agent (Print)		f. Signature <i>(Signature)</i>		g. Date 8510

**IV. ASBESTOS (Generator completes IVa-f and Operator complete IVg-i)**

a. Operator's Name and Address:		c. Responsible Agency Name and Address:	
b. Phone:		d. Phone:	
e. Special Handling Instructions and Additional Information:			
f. <input type="checkbox"/> Friable <input type="checkbox"/> Non-Friable <input type="checkbox"/> Both % Friable % Non-Friable			
OPERATOR'S CERTIFICATION: I hereby declare that the contents of this consignment are fully and accurately described above by proper shipping name and are classified, packed, marked and labeled and are in all respects in proper condition for transport by highway according to applicable international and national governmental regulations.			
g. Operator's Name and Title (Print)		h. Signature	
		i. Date	
*Operator refers to the company which owns, leases, operates, controls, or supervises the facility being demolished or renovated, or the demolition or renovation operation or both			





# NON-HAZARDOUS SPECIAL WASTE & ASBESTOS MANIFEST

Modern Landfill  
4400 Mt. Pisgah Rd.  
York, PA 17406  
717-246-2686

If waste is asbestos waste, complete Sections I, II, III and IV  
If waste is NOT asbestos waste, complete Sections I, II and III

09-03013

## I. GENERATOR (Generator completes Ia-r)

a. Generator's US EPA ID Number PAD001643691		b. Manifest Document Number 09-03013		c. Page 1 of 1		
d. Generator's Name and Location: Harley-Davidson Motor Co. Ops., Inc. 1425 Eden Road York, PA 17402			e. Generator's Mailing Address: Same			
f. Phone: 717-848-1177			g. Phone:			
If owner of the generating facility differs from the generator, provide:						
h. Owner's Name:			i. Owner's Phone No.:			
j. Waste Profile #	k. Exp. Date	l. Waste Shipping Name and Description	m. Containers No.	Type	n. Total Quantity	o. Unit Wt/Vol
10 10670	7/2/13/2011 <i>Recd</i>	Contaminated Soil-Debris		30CY	2164	
GENERATOR'S CERTIFICATION: I hereby certify that the above named material is not a hazardous waste as defined by 40 CFR 261 or any applicable state law, has been properly described, classified and packaged, and is in proper condition for transportation according to applicable regulations; AND, if this waste is a treatment residue of a previously restricted hazardous waste subject to the Land Disposal Restrictions. I certify and warrant that the waste has been treated in accordance with the requirements of 40 CFR 268 and is no longer a hazardous waste as defined by 40 CFR 261.						
p. Generator Authorized Agent Name (Print) Sharon R Fisher			q. Signature <i>Sharon R Fisher</i>		r. Date 08-06-10	

## II. TRANSPORTER (Generator completes IIa-b and Transporter completes IIc-e)

a. Transporter's Name and Address: Envirote of Pennsylvania, Inc. 730 Vogelsong Road York, PA 17404			(537)		
b. PPhone: 717-846-1900					
c. Driver Name (Print) RONALD HOLLAND		d. Signature <i>Ronald Holland</i>		e. Date 8-06-07	

## III. DESTINATION (Generator complete IIIa-c and Destination Site completes IIId-g)

a. Disposal Facility and Site Address: Modern Landfill 4400 Mt. Pisgah Rd. York, PA 17406		c. US EPA Number PAD987395803	d. Discrepancy Indication Space:
b. Phone: 717-245-2686			
I hereby certify that the above named material has been accepted and to the best of my knowledge the foregoing is true and accurate.			
e. Name of Authorized Agent (Print)		f. Signature <i>CIS</i>	g. Date 8/6/10

## IV. ASBESTOS (Generator completes IVa-f and Operator complete IVg-i)

a. Operator's Name and Address:		c. Responsible Agency Name and Address:	
b. Phone:		d. Phone:	
e. Special Handling Instructions and Additional Information:			
f. <input type="checkbox"/> Friable <input type="checkbox"/> Non-Friable <input type="checkbox"/> Both      % Friable      % Non-Friable			
OPERATOR'S CERTIFICATION: I hereby declare that the contents of this consignment are fully and accurately described above by proper shipping name and are classified, packed, marked and labeled and are in all respects in proper condition for transport by highway according to applicable international and national governmental regulations.			
g. Operator's Name and Title (Print)		h. Signature	
		i. Date	
*Operator refers to the company which owns, leases, operates, controls, or supervises the facility being demolished or renovated, or the demolition or renovation operation or both			



**NON-HAZARDOUS SPECIAL WASTE & ASBESTOS MANIFEST**

11/110

Modern Landfill  
4400 Mt. Pisgah Rd.  
York, PA 17406  
717-246-2686

If waste is asbestos waste, complete Sections I, II, III and IV  
If waste is **NOT** asbestos waste, complete Sections I, II and III

09-03014

**I. GENERATOR (Generator completes Ia-r)**

a. Generator's US EPA ID Number PAD001643691		b. Manifest Document Number 09-03014		c. Page 1 of 1	
d. Generator's Name and Location: Harley-Davidson Motor Co. Ops., Inc. 1425 Eden Road York, PA 17402			e. Generator's Mailing Address: Same		
f. Phone: 717-848-1177			g. Phone:		
If owner of the generating facility differs from the generator, provide:					
h. Owner's Name:			i. Owner's Phone No.:		
j. Waste Profile #	k. Exp. Date	l. Waste Shipping Name and Description	m. Containers No. Type		n. Total Quantity
10 10670	7/13/2011 <i>NS</i>	Contaminated Soil-Debris	3001		
GENERATOR'S CERTIFICATION: I hereby certify that the above named material is not a hazardous waste as defined by 40 CFR 261 or any applicable state law, has been properly described, classified and packaged, and is in proper condition for transportation according to applicable regulations; AND, if this waste is a treatment residue of a previously restricted hazardous waste subject to the Land Disposal Restrictions. I certify and warrant that the waste has been treated in accordance with the requirements of 40 CFR 268 and is no longer a hazardous waste as defined by 40 CFR 261.					
p. Generator Authorized Agent Name (Print) Sharon R Fisher		q. Signature <i>Sharon R Fisher</i>		r. Date 08-06-10	

**II. TRANSPORTER (Generator completes IIa-b and Transporter completes IIc-e)**

a. Transporter's Name and Address: Envirite of Pennsylvania, Inc. 730 Vogelsong Road York, PA 17404			430057 / CT-50		
b. Phone: 717-846-1900					
c. Driver Name (Print) Ken Smith		d. Signature <i>Ken Smith</i>		e. Date 08/06/10	

**III. DESTINATION (Generator complete IIIa-c and Destination Site completes III d-g)**

a. Disposal Facility and Site Address: Modern Landfill 4400 Mt. Pisgah Rd. York, PA 17406		b. Phone: 717-246-2686	c. US EPA Number PAD987395803	d. Discrepancy Indication Space:	
I hereby certify that the above named material has been accepted and to the best of my knowledge the foregoing is true and accurate.					
e. Name of Authorized Agent (Print)		f. Signature <i>CS</i>		g. Date 8/10	

**IV. ASBESTOS (Generator completes IVa-f and Operator complete IVg-i)**

a. Operator's Name and Address:			c. Responsible Agency Name and Address:		
b. Phone:			d. Phone:		
e. Special Handling Instructions and Additional Information:					
f. <input type="checkbox"/> Friable <input type="checkbox"/> Non-Friable <input type="checkbox"/> Both      % Friable      % Non-Friable					
OPERATOR'S CERTIFICATION: I hereby declare that the contents of this consignment are fully and accurately described above by proper shipping name and are classified, packed, marked and labeled and are in all respects in proper condition for transport by highway according to applicable international and national governmental regulations.					
g. Operator's Name and Title (Print)			h. Signature		i. Date
*Operator refers to the company which owns, leases, operates, controls, or supervises the facility being demolished or renovated, or the demolition or renovation operation or both					



NON-HAZARDOUS SPECIAL WASTE & ASBESTOS MANIFEST

9/7/10

Modern Landfill
4400 Mt. Pisgah Rd.
York, PA 17406
717-246-2686

If waste is asbestos waste, complete Sections I, II, III and IV
If waste is NOT asbestos waste, complete Sections I, II and III

09-03016

I. GENERATOR (Generator completes Ia-r)

Form I: Generator information including EPA ID Number (PAD001643691), Manifest Document Number (09-03016), Generator Name (Harley-Davidson Motor Co. Ops., Inc.), and Waste Profile # (10 10670).

II. TRANSPORTER (Generator completes IIa-b and Transporter completes IIc-e)

Form II: Transporter information including Name (Envirite of Pennsylvania, Inc.), Driver Name (KONRAD HOLLER), and Date (08-06-10).

III. DESTINATION (Generator complete IIIa-c and Destination Site completes III d-g)

Form III: Destination information including Disposal Facility (Modern Landfill), US EPA Number (PAD987395803), and Date (8-6-10).

IV. ASBESTOS (Generator completes IVa-f and Operator complete IVg-i)

Form IV: Asbestos information including Operator Name, Agency Name, and Operator's Certification regarding the contents of the consignment.



Modern Landfill  
4400 Mt. Pisgah Rd.  
York, PA 17406  
717-246-2686

**NON-HAZARDOUS SPECIAL WASTE & ASBESTOS MANIFEST**

If waste is asbestos waste, complete Sections I, II, III and IV  
If waste is NOT asbestos waste, complete Sections I, II and III

09-03017

**I. GENERATOR (Generator completes Ia-r)**

a. Generator's US EPA ID Number PAD001643691		b. Manifest Document Number 09-03017		c. Page 1 of 1		
d. Generator's Name and Location: Harley-Davidson Motor Co. Ops., Inc. 1425 Eden Road York, PA 17402			e. Generator's Mailing Address: Same			
f. Phone: 717-848-1177			g. Phone:			
h. Owner's Name:			i. Owner's Phone No.:			
If owner of the generating facility differs from the generator, provide:						
j. Waste Profile #	k. Exp. Date	l. Waste Shipping Name and Description	m. Containers No.	m. Containers Type	n. Total Quantity	o. Unit Wt/Vol
10 10670	<del>2/10/11</del> 7/13/2011	Contaminated Soil-Debris		30CY	(903)	
GENERATOR'S CERTIFICATION: I hereby certify that the above named material is not a hazardous waste as defined by 40 CFR 261 or any applicable state law, has been properly described, classified and packaged, and is in proper condition for transportation according to applicable regulations; AND, if this waste is a treatment residue of a previously restricted hazardous waste subject to the Land Disposal Restrictions. I certify and warrant that the waste has been treated in accordance with the requirements of 40 CFR 268 and is no longer a hazardous waste as defined by 40 CFR 261.						
p. Generator Authorized Agent Name (Print) Sharon R Fisher		q. Signature <i>Sharon R Fisher</i>		r. Date 08-06-10		

**II. TRANSPORTER (Generator completes IIa-b and Transporter completes IIc-e)**

a. Transporter's Name and Address: Envirite of Pennsylvania, Inc. 730 Vogelsong Road York, PA 17406			43057 / CT-50		
b. Phone: 717-846-1900					
c. Driver Name (Print) <i>Ken C. Swartz</i>		d. Signature <i>Ken C. Swartz</i>		e. Date 08/06/10	

**III. DESTINATION (Generator complete IIIa-c and Destination Site completes III d-g)**

a. Disposal Facility and Site Address: Modern Landfill 4400 Mt. Pisgah Rd. York, PA 17406		c. US EPA Number PAD987395803	d. Discrepancy Indication Space:
b. Phone: 717-246-2686			
I hereby certify that the above named material has been accepted and to the best of my knowledge the foregoing is true and accurate.			
e. Name of Authorized Agent (Print)		f. Signature <i>(Signature)</i>	g. Date 8/6/10

**IV. ASBESTOS (Generator completes IVa-f and Operator complete IVg-i)**

a. Operator's Name and Address:		c. Responsible Agency Name and Address:	
b. Phone:		d. Phone:	
e. Special Handling Instructions and Additional Information:			
f. <input type="checkbox"/> Friable <input type="checkbox"/> Non-Friable <input type="checkbox"/> Both % Friable % Non-Friable			
OPERATOR'S CERTIFICATION: I hereby declare that the contents of this consignment are fully and accurately described above by proper shipping name and are classified, packed, marked and labeled and are in all respects in proper condition for transport by highway according to applicable international and national governmental regulations.			
g. Operator's Name and Title (Print)		h. Signature	
		i. Date	
*Operator refers to the company which owns, leases, operates, controls, or supervises the facility being demolished or renovated, or the demolition or renovation operation or both			





# NON-HAZARDOUS SPECIAL WASTE & ASBESTOS MANIFEST

9/7/10

Modern Landfill  
4400 Mt. Pisgah Rd.  
York, PA 17406  
717-246-2686

If waste is asbestos waste, complete Sections I, II, III and IV  
If waste is NOT asbestos waste, complete Sections I, II and III

09-03018

## I. GENERATOR (Generator completes Ia-r)

a. Generator's US EPA ID Number PAD001643691		b. Manifest Document Number 09-03018		c. Page 1 of 1		
d. Generator's Name and Location: Harley-Davidson Motor Co. Ops., Inc. 1425 Eden Road York, PA 17402			e. Generator's Mailing Address: Same			
f. Phone: 717-848-1177			g. Phone:			
If owner of the generating facility differs from the generator, provide:						
h. Owner's Name:			i. Owner's Phone No.:			
j. Waste Profile #	k. Exp. Date	l. Waste Shipping Name and Description	m. Containers No.	m. Containers Type	n. Total Quantity	o. Unit Wt/Vol
10 10670	7/13/2011	Contaminated Soil Debris		30 CY		
field # 84623 20.72 ton						
GENERATOR'S CERTIFICATION: I hereby certify that the above named material is not a hazardous waste as defined by 40 CFR 261 or any applicable state law, has been properly described, classified and packaged, and is in proper condition for transportation according to applicable regulations; AND, if this waste is a treatment residue of a previously restricted hazardous waste subject to the Land Disposal Restrictions. I certify and warrant that the waste has been treated in accordance with the requirements of 40 CFR 268 and is no longer a hazardous waste as defined by 40 CFR 261.						
p. Generator Authorized Agent Name (Print) Sharon R Fisher			q. Signature <i>Sharon R Fisher</i>		r. Date 08-06-10	

## II. TRANSPORTER (Generator completes IIa-b and Transporter completes IIc-e)

a. Transporter's Name and Address: Envirite of Pennsylvania, Inc. 730 Vogelsohn Road York, PA 17404		
b. Phone: 717-846-1900		
c. Driver Name (Print) <i>Kenneth H. H. H.</i>	d. Signature <i>Kenneth H. H. H.</i>	e. Date 8-06-10

## III. DESTINATION (Generator complete IIIa-c and Destination Site completes III d-g)

a. Disposal Facility and Site Address: Modern Landfill 4400 Mt. Pisgah Rd. York, PA 17406		c. US EPA Number PAD967395803	d. Discrepancy Indication Space:
b. Phone: 717-246-2686			
I hereby certify that the above named material has been accepted and to the best of my knowledge the foregoing is true and accurate.			
e. Name of Authorized Agent (Print)		f. Signature <i>CTJ</i>	g. Date 8/10/10

## IV. ASBESTOS (Generator completes IVa-f and Operator complete IVg-i)

a. Operator's Name and Address:		c. Responsible Agency Name and Address:	
b. Phone:		d. Phone:	
e. Special Handling Instructions and Additional Information:			
f. <input type="checkbox"/> Friable <input type="checkbox"/> Non-Friable <input type="checkbox"/> Both      % Friable      % Non-Friable			
OPERATOR'S CERTIFICATION: I hereby declare that the contents of this consignment are fully and accurately described above by proper shipping name and are classified, packed, marked and labeled and are in all respects in proper condition for transport by highway according to applicable international and national governmental regulations.			
g. Operator's Name and Title (Print)		h. Signature	i. Date
*Operator refers to the company which owns, leases, operates, controls, or supervises the facility being demolished or renovated, or the demolition or renovation operation or both			



**NON-HAZARDOUS SPECIAL WASTE & ASBESTOS MANIFEST**

7/7/10

Modern Landfill  
4400 Mt. Pisgah Rd.  
York, PA 17406  
717-246-2686

If waste is asbestos waste, complete Sections I, II, III and IV  
If waste is **NOT** asbestos waste, complete Sections I, II and III

09-03019

**I. GENERATOR** (Generator completes Ia-r)

a. Generator's US EPA ID Number PAD001643691		b. Manifest Document Number 09-03019		c. Page 1 of 1	
d. Generator's Name and Location: Harley-Davidson Motor Co. Ops., Inc. 1425 Eden Road York, PA 17402			e. Generator's Mailing Address:  Same		
f. Phone: 717-848-1177			g. Phone:		
If owner of the generating facility differs from the generator, provide:					
h. Owner's Name:			i. Owner's Phone No.:		
j. Waste Profile #	k. Exp. Date	l. Waste Shipping Name and Description	m. Containers No. Type		n. Total Quantity
10 10670	7/13/2011	Contaminated Soil-Debris	30CY		2215
GENERATOR'S CERTIFICATION: I hereby certify that the above named material is not a hazardous waste as defined by 40 CFR 261 or any applicable state law, has been properly described, classified and packaged, and is in proper condition for transportation according to applicable regulations; AND, if this waste is a treatment residue of a previously restricted hazardous waste subject to the Land Disposal Restrictions. I certify and warrant that the waste has been treated in accordance with the requirements of 40 CFR 268 and is no longer a hazardous waste as defined by 40 CFR 261.					
p. Generator Authorized Agent Name (Print) Sharon R Fisher		q. Signature Sharon R Fisher		r. Date 08-06-10	

**II. TRANSPORTER** (Generator completes IIa-b and Transporter completes IIc-e)

a. Transporter's Name and Address: Envirite of Pennsylvania, Inc. 730 Vogelsong Road York, PA 17406			430057/ CT-50		
b. Phone: 717-846-1900					
c. Driver Name (Print) Ken Smith		d. Signature Ken Smith		e. Date 8/6/10	

**III. DESTINATION** (Generator complete IIIa-c and Destination Site completes III d-g)

a. Disposal Facility and Site Address: Modern Landfill 4400 Mt. Pisgah Rd. York, PA 17406		b. Phone: 717-246-2686	c. US EPA Number PAD967395803	d. Discrepancy Indication Space:	
I hereby certify that the above named material has been accepted and to the best of my knowledge the foregoing is true and accurate.					
e. Name of Authorized Agent (Print)		f. Signature		g. Date	

**IV. ASBESTOS** (Generator completes IVa-f and Operator complete IVg-i)

a. Operator's Name and Address:			c. Responsible Agency Name and Address:		
b. Phone:			d. Phone:		
e. Special Handling Instructions and Additional Information:					
f. <input type="checkbox"/> Friable <input type="checkbox"/> Non-Friable <input type="checkbox"/> Both % Friable % Non-Friable					
OPERATOR'S CERTIFICATION: I hereby declare that the contents of this consignment are fully and accurately described above by proper shipping name and are classified, packed, marked and labeled and are in all respects in proper condition for transport by highway according to applicable international and national governmental regulations.					
g. Operator's Name and Title (Print)		h. Signature		i. Date	
*Operator refers to the company which owns, leases, operates, controls, or supervises the facility being demolished or renovated, or the demolition or renovation operation or both					



# NON-HAZARDOUS SPECIAL WASTE & ASBESTOS MANIFEST

7/7/10

Modern Landfill  
4400 Mt. Pisgah Rd.  
York, PA 17406  
717-246-2686

If waste is asbestos waste, complete Sections I, II, III and IV  
If waste is **NOT** asbestos waste, complete Sections I, II and III

09-03020

### I. GENERATOR (Generator completes Ia-r)

a. Generator's US EPA ID Number PAD001643691		b. Manifest Document Number 09-03020		c. Page 1 of 1	
d. Generator's Name and Location: Harley-Davidson Motor Co. Ops., Inc. 1425 Eden Road York, PA 17402			e. Generator's Mailing Address: Same		
f. Phone: 717-848-1177			g. Phone:		
If owner of the generating facility differs from the generator, provide:					
h. Owner's Name:			i. Owner's Phone No.:		
j. Waste Profile #	k. Exp. Date	l. Waste Shipping Name and Description	m. Containers No.	m. Containers Type	n. Total Quantity
10 10670	7/13/2011	Contaminated Soil-Debris		30CY	
Handwritten: Ticket # 84682      21.81 ton					

GENERATOR'S CERTIFICATION: I hereby certify that the above named material is not a hazardous waste as defined by 40 CFR 261 or any applicable state law, has been properly described, classified and packaged, and is in proper condition for transportation according to applicable regulations; AND, if this waste is a treatment residue of a previously restricted hazardous waste subject to the Land Disposal Restrictions. I certify and warrant that the waste has been treated in accordance with the requirements of 40 CFR 268 and is no longer a hazardous waste as defined by 40 CFR 261.

p. Generator Authorized Agent Name (Print) Sharon R Fisher		q. Signature <i>Sharon R Fisher</i>	r. Date 08-06-10
---	--	--	---------------------

### II. TRANSPORTER (Generator completes IIa-b and Transporter completes IIc-e)

a. Transporter's Name and Address: Envirite of Pennsylvania, Inc. 730 Vogelsong Road York, PA 17406			b. Phone: 717-846-1900		
c. Driver Name (Print) Kousa... 527		d. Signature <i>[Signature]</i>	e. Date 8-06-10		

### III. DESTINATION (Generator complete IIIa-c and Destination Site completes IIId-g)

a. Disposal Facility and Site Address: Modern Landfill 4400 Mt. Pisgah Rd York, PA 17406		b. Phone: 717-246-2686	c. US EPA Number PAD987395803	d. Discrepancy Indication Space:
--	--	------------------------	----------------------------------	----------------------------------

I hereby certify that the above named material has been accepted and to the best of my knowledge the foregoing is true and accurate.

e. Name of Authorized Agent (Print)	f. Signature <i>[Signature]</i>	g. Date 8/6/10
-------------------------------------	------------------------------------	-------------------

### IV. ASBESTOS (Generator completes IVa-f and Operator complete IVg-i)

a. Operator's Name and Address:		c. Responsible Agency Name and Address:	
b. Phone:		d. Phone:	
e. Special Handling Instructions and Additional Information:			

f.  Friable  Non-Friable  Both      % Friable      % Non-Friable

OPERATOR'S CERTIFICATION: I hereby declare that the contents of this consignment are fully and accurately described above by proper shipping name and are classified, packed, marked and labeled and are in all respects in proper condition for transport by highway according to applicable international and national governmental regulations.

g. Operator's Name and Title (Print)	h. Signature	i. Date
--------------------------------------	--------------	---------

\*Operator refers to the company which owns, leases, operates, controls, or supervises the facility being demolished or renovated, or the demolition or renovation operation or both



# NON-HAZARDOUS SPECIAL WASTE & ASBESTOS MANIFEST

7/11/10

Modern Landfill  
4400 Mt. Pisgah Rd.  
York, PA 17406  
717-246-2686

If waste is asbestos waste, complete Sections I, II, III and IV  
If waste is **NOT** asbestos waste, complete Sections I, II and III

09-03021

### I. GENERATOR (Generator completes Ia-r)

a. Generator's US EPA ID Number PAD001643691		b. Manifest Document Number 09-03021		c. Page 1 of 1	
d. Generator's Name and Location: Harley-Davidson Motor Co. Ops., Inc. 1425 Eden Road York, PA 17402			e. Generator's Mailing Address:  Same		
f. Phone: 717-848-1177			g. Phone:		
If owner of the generating facility differs from the generator, provide:					
h. Owner's Name:			i. Owner's Phone No.:		
j. Waste Profile #	k. Exp. Date	l. Waste Shipping Name and Description	m. Containers No.	Type	n. Total Quantity
10 10670	7/13/2011	Contaminated Soil-Debris		30CY	
GENERATOR'S CERTIFICATION: I hereby certify that the above named material is not a hazardous waste as defined by 40 CFR 261 or any applicable state law, has been properly described, classified and packaged, and is in proper condition for transportation according to applicable regulations; AND, if this waste is a treatment residue of a previously restricted hazardous waste subject to the Land Disposal Restrictions. I certify and warrant that the waste has been treated in accordance with the requirements of 40 CFR 268 and is no longer a hazardous waste as defined by 40 CFR 261.					
p. Generator Authorized Agent Name (Print) Sharon R Fisher			q. Signature <i>Sharon R Fisher</i>		r. Date 08/06/10

### II. TRANSPORTER (Generator completes IIa-b and Transporter completes IIc-e)

a. Transporter's Name and Address: Envirite of Pennsylvania, Inc. 730 Vogelsong Road York, PA 17404			430057 / CT-50		
b. Phone: 717-846-1900					
c. Driver Name (Print) <i>Ken Smith</i>		d. Signature <i>Ken Smith</i>		e. Date 08/06/10	

### III. DESTINATION (Generator complete IIIa-c and Destination Site completes III d-g)

a. Disposal Facility and Site Address: Modern Landfill 4400 Mt. Pisgah Rd York, PA 17406		b. Phone: 717-246-2686	c. US EPA Number PAD987395803	d. Discrepancy Indication Space:	
I hereby certify that the above named material has been accepted and to the best of my knowledge the foregoing is true and accurate.					
e. Name of Authorized Agent (Print)		f. Signature <i>[Signature]</i>		g. Date 8/6/10	

### IV. ASBESTOS (Generator completes IVa-f and Operator complete IVg-i)

a. Operator's Name and Address:			c. Responsible Agency Name and Address:		
b. Phone:			d. Phone:		
e. Special Handling Instructions and Additional Information:					
f. <input type="checkbox"/> Friable <input type="checkbox"/> Non-Friable <input type="checkbox"/> Both      % Friable      % Non-Friable					
OPERATOR'S CERTIFICATION: I hereby declare that the contents of this consignment are fully and accurately described above by proper shipping name and are classified, packed, marked and labeled and are in all respects in proper condition for transport by highway according to applicable international and national governmental regulations.					
g. Operator's Name and Title (Print)			h. Signature		i. Date
*Operator refers to the company which owns, leases, operates, controls, or supervises the facility being demolished or renovated, or the demolition or renovation operation or both					



# NON-HAZARDOUS SPECIAL WASTE & ASBESTOS MANIFEST

Modern Landfill  
4400 Mt. Pisgah Rd.  
York, PA 17406  
717-246-2686

If waste is asbestos waste, complete Sections I, II, III and IV  
If waste is NOT asbestos waste, complete Sections I, II and III

09-03022

## I. GENERATOR (Generator completes Ia-r)

a. Generator's US EPA ID Number PAD001643691		b. Manifest Document Number 09-03022		c. Page 1 of 1	
d. Generator's Name and Location: Harley-Davidson Motor Co. Ops., Inc. 1425 Eden Road York, PA 17402			e. Generator's Mailing Address: Same		
f. Phone: 717-848-1177			g. Phone:		
If owner of the generating facility differs from the generator, provide:			i. Owner's Phone No.:		
h. Owner's Name:			i. Owner's Phone No.:		
j. Waste Profile #	k. Exp. Date	l. Waste Shipping Name and Description	m. Containers No. Type		n. Total Quantity
10 10670	7/13/2011	Contaminated Soil-Debris		30CY	
<p>ticket # 84721 (22.34 ton)</p>					
GENERATOR'S CERTIFICATION: I hereby certify that the above named material is not a hazardous waste as defined by 40 CFR 261 or any applicable state law, has been properly described, classified and packaged, and is in proper condition for transportation according to applicable regulations; AND, if this waste is a treatment residue of a previously restricted hazardous waste subject to the Land Disposal Restrictions. I certify and warrant that the waste has been treated in accordance with the requirements of 40 CFR 268, and is no longer a hazardous waste as defined by 40 CFR 261.					
p. Generator Authorized Agent Name (Print) Sharon R Fisher			q. Signature <i>Sharon R Fisher</i>		r. Date 08-25-10

## II. TRANSPORTER (Generator completes IIa-b and Transporter completes IIc-e)

a. Transporter's Name and Address: Envirite of Pennsylvania, Inc. 730 Vogelsong Road York, PA 17404			(527)		
b. Phone: 717-846-1900					
c. Driver Name (Print) Ronald Howard		d. Signature <i>Ronald Howard</i>		e. Date 8-26-10	

## III. DESTINATION (Generator complete IIIa-c and Destination Site completes III d-g)

a. Disposal Facility and Site Address: Modern Landfill 4400 Mt. Pisgah Rd York, PA 17406		c. US EPA Number PAD987395803	d. Discrepancy Indication Space:
b. Phone: 717-246-2686			
I hereby certify that the above named material has been accepted and to the best of my knowledge the foregoing is true and accurate.			
e. Name of Authorized Agent (Print)		f. Signature <i>MLC</i>	g. Date 8/26/10

## IV. ASBESTOS (Generator completes IVa-f and Operator complete IVg-i)

a. Operator's Name and Address:		c. Responsible Agency Name and Address:	
b. Phone:		d. Phone:	
e. Special Handling Instructions and Additional Information:			
f. <input type="checkbox"/> Friable <input type="checkbox"/> Non-Friable <input type="checkbox"/> Both      % Friable      % Non-Friable			
OPERATOR'S CERTIFICATION: I hereby declare that the contents of this consignment are fully and accurately described above by proper shipping name and are classified, packed, marked and labeled and are in all respects in proper condition for transport by highway according to applicable international and national governmental regulations.			
g. Operator's Name and Title (Print)		h. Signature	
		i. Date	
*Operator refers to the company which owns, leases, operates, controls, or supervises the facility being demolished or renovated, or the demolition or renovation operation or both			





Modern Landfill  
4400 Mt. Pisgah Rd.  
York, PA 17406  
717-246-2686

# NON-HAZARDOUS SPECIAL WASTE & ASBESTOS MANIFEST

If waste is asbestos waste, complete Sections I, II, III and IV  
If waste is **NOT** asbestos waste, complete Sections I, II and III

717110  
09-03023

441533-9589Y

Box # 607740

## I. GENERATOR (Generator completes Ia-r)

a. Generator's US EPA ID Number PAD001643691		b. Manifest Document Number 09-03023		c. Page 1 of 1	
d. Generator's Name and Location: Harley-Davidson Motor Co. Ops., Inc. 1425 Eden Road York, PA 17402			e. Generator's Mailing Address: Same		
f. Phone: 717-848-1177			g. Phone:		
If owner of the generating facility differs from the generator, provide:					
h. Owner's Name:			i. Owner's Phone No.:		
j. Waste Profile #	k. Exp. Date	l. Waste Shipping Name and Description	m. Containers No. Type		n. Total Quantity
10 10670	7/13/2011	Contaminated Soil-Debris	30CY		
ticket # 85151	12.19	ton			
GENERATOR'S CERTIFICATION: I hereby certify that the above named material is not a hazardous waste as defined by 40 CFR 261 or any applicable state law, has been properly described, classified and packaged, and is in proper condition for transportation according to applicable regulations; AND, if this waste is a treatment residue of a previously restricted hazardous waste subject to the Land Disposal Restrictions. I certify and warrant that the waste has been treated in accordance with the requirements of 40 CFR 268 and is no longer a hazardous waste as defined by 40 CFR 261.					
p. Generator Authorized Agent Name (Print) Sharon R Fisher			q. Signature <i>Sharon R Fisher</i>		r. Date 08-1-10

## II. TRANSPORTER (Generator completes IIa-b and Transporter completes IIc-e)

a. Transporter's Name and Address: Envirite of Pennsylvania, Inc. 730 Vogelsong Road York, PA 17404		
b. Phone: 717-845-1900		
c. Driver Name (Print) John Schachtel	d. Signature <i>John Schachtel</i>	e. Date 08-09-2010

## III. -DESTINATION (Generator complete IIIa-c and Destination Site completes IIId-g)

a. Disposal Facility and Site Address: Modern Landfill 4400 Mt. Pisgah Rd York, PA 17406	b. Phone: 717-246-2686	c. US EPA Number PAD987395803	d. Discrepancy Indication Space:
I hereby certify that the above named material has been accepted and to the best of my knowledge the foregoing is true and accurate.			
e. Name of Authorized Agent (Print)	f. Signature <i>JMC</i>	g. Date 8/1/10	

## IV. ASBESTOS (Generator completes IVa-f and Operator complete IVg-i)

a. Operator's Name and Address:		c. Responsible Agency Name and Address:	
b. Phone:		d. Phone:	
e. Special Handling Instructions and Additional Information:			
f. <input type="checkbox"/> Friable <input type="checkbox"/> Non-Friable <input type="checkbox"/> Both % Friable % Non-Friable			
OPERATOR'S CERTIFICATION: I hereby declare that the contents of this consignment are fully and accurately described above by proper shipping name and are classified, packed, marked and labeled and are in all respects in proper condition for transport by highway according to applicable international and national governmental regulations.			
g. Operator's Name and Title (Print)		i. Date	
h. Signature			
*Operator refers to the company which owns, leases, operates, controls, or supervises the facility being demolished or renovated, or the demolition or renovation operation or both			



# NON-HAZARDOUS SPECIAL WASTE & ASBESTOS MANIFEST

-80110-417110  
Both 09-03024  
#130

Modern Landfill  
4400 Mt. Pisgah Rd.  
York, PA 17406  
717-246-2686

If waste is asbestos waste, complete Sections I, II, III and IV  
If waste is NOT asbestos waste, complete Sections I, II and III

## I. GENERATOR (Generator completes Ia-r) *PAK 8016, 7/13/2011*

a. Generator's US EPA ID Number PAD001643691		b. Manifest Document Number 09-03024		c. Page 1 of 1		
d. Generator's Name and Location: Harley-Davidson Motor Co. Ops., Inc. 1425 Eden Road York, PA 17402			e. Generator's Mailing Address: Same			
f. Phone: 717-848-1177			g. Phone:			
h. Owner's Name:			i. Owner's Phone No.:			
If owner of the generating facility differs from the generator, provide:						
j. Waste Profile #	k. Exp. Date	l. Waste Shipping Name and Description	m. Containers No.	m. Containers Type	n. Total Quantity	o. Unit Wt/Vol
10 10670	7/13/2011	Contaminated Soil-Debris	001	30CY		
	14.60					

GENERATOR'S CERTIFICATION: I hereby certify that the above named material is not a hazardous waste as defined by 40 CFR 261 or any applicable state law, has been properly described, classified and packaged, and is in proper condition for transportation according to applicable regulations; AND, if this waste is a treatment residue of a previously restricted hazardous waste subject to the Land Disposal Restrictions. I certify and warrant that the waste has been treated in accordance with the requirements of 40 CFR 268 and is no longer a hazardous waste as defined by 40 CFR 261.

p. Generator Authorized Agent Name (Print) <i>Sharon R Fisher</i>	q. Signature <i>Sharon R Fisher</i>	r. Date 08-9-10
--	--	--------------------

## II. TRANSPORTER (Generator completes IIa-b and Transporter completes IIc-e)

a. Transporter's Name and Address: Envirite of Pennsylvania, Inc. 730 Vogel song Road York, PA 17404		
b. Phone: 717-846-1900		
c. Driver Name (Print) <i>THAMES MILLER JR</i>	d. Signature <i>Thames Miller</i>	e. Date 8/9/10

## III. DESTINATION (Generator complete IIIa-c and Destination Site completes IIId-g)

a. Disposal Facility and Site Address: Modern Landfill 4400 Mt. Pisgah Rd York, PA 17406	b. Phone: 717-246-2686	c. US EPA Number PAD987395803	d. Discrepancy Indication Space:
I hereby certify that the above named material has been accepted and to the best of my knowledge the foregoing is true and accurate.			
e. Name of Authorized Agent (Print)	f. Signature <i>[Signature]</i>	g. Date 8/11/10	

## IV. ASBESTOS (Generator completes IVa-f and Operator complete IVg-i)

a. Operator's Name and Address:		c. Responsible Agency Name and Address:	
b. Phone:		d. Phone:	
e. Special Handling Instructions and Additional Information:			
f. <input type="checkbox"/> Friable <input type="checkbox"/> Non-Friable <input type="checkbox"/> Both      % Friable      % Non-Friable			
OPERATOR'S CERTIFICATION: I hereby declare that the contents of this consignment are fully and accurately described above by proper shipping name and are classified, packed, marked and labeled and are in all respects in proper condition for transport by highway according to applicable international and national governmental regulations.			
g. Operator's Name and Title (Print)		i. Date	
h. Signature			
*Operator refers to the company which owns, leases, operates, controls, or supervises the facility being demolished or renovated, or the demolition or renovation operation or both			



NON-HAZARDOUS SPECIAL WASTE & ASBESTOS MANIFEST

Modern Landfill  
4400 Mt. Pisgah Rd.  
York, PA 17406  
717-246-2686

If waste is asbestos waste, complete Sections I, II, III and IV  
If waste is **NOT** asbestos waste, complete Sections I, II and III

09-03025

TRK 8076/TKL #9003Y BOX #6274

I. GENERATOR (Generator completes Ia-r)

a. Generator's US EPA ID Number PAD001643691	b. Manifest Document Number 09-03025	c. Page 1 of 1
d. Generator's Name and Location: Harley-Davidson Motor Co. Ops., Inc. 1225 Eden Road York, PA 17402		e. Generator's Mailing Address: Same
f. Phone: 717-848-1177		g. Phone:
If owner of the generating facility differs from the generator, provide:		
h. Owner's Name:		i. Owner's Phone No.:

j. Waste Profile #	k. Exp. Date	l. Waste Shipping Name and Description	m. Containers		n. Total Quantity	o. Unit Wt/Vol
			No.	Type		
10 10670	7/13/2011	Contaminated Soil-Debris	001	30CY		
ticw # 85217	11.43 tn.					

GENERATOR'S CERTIFICATION: I hereby certify that the above named material is not a hazardous waste as defined by 40 CFR 261 or any applicable state law, has been properly described, classified and packaged, and is in proper condition for transportation according to applicable regulations; AND, if this waste is a treatment residue of a previously restricted hazardous waste subject to the Land Disposal Restrictions. I certify and warrant that the waste has been treated in accordance with the requirements of 40 CFR 268 and is no longer a hazardous waste as defined by 40 CFR 261.

p. Generator Authorized Agent Name (Print) Shaun R Fisher	q. Signature <i>Shaun R Fisher</i>	r. Date 08-9-10
--	---------------------------------------	--------------------

II. TRANSPORTER (Generator completes IIa-b and Transporter completes IIc-e)

a. Transporter's Name and Address: Envirite of Pennsylvania, Inc. 730 vogelsong Rd York, PA 17404		
b. Phone: 717-846-1900		
c. Driver Name (Print) JAMES E. MILLER, JR	d. Signature <i>James E. Miller, Jr</i>	e. Date 8/19/10

III. DESTINATION (Generator complete IIIa-c and Destination Site completes III d-g)

a. Disposal Facility and Site Address: Modern Landfill 4400 Mt. Pisgah Rd York, PA 17406	b. Phone: 717-2462686	c. US EPA Number PAD987395803	d. Discrepancy Indication Space:
I hereby certify that the above named material has been accepted and to the best of my knowledge the foregoing is true and accurate.			
e. Name of Authorized Agent (Print)	f. Signature <i>CIS</i>	g. Date 8/10	

IV. ASBESTOS (Generator completes IVa-f and Operator complete IVg-i)

a. Operator's Name and Address:		c. Responsible Agency Name and Address:	
b. Phone:		d. Phone:	
e. Special Handling Instructions and Additional Information:			
f. <input type="checkbox"/> Friable <input type="checkbox"/> Non-Friable <input type="checkbox"/> Both % Friable % Non-Friable			
OPERATOR'S CERTIFICATION: I hereby declare that the contents of this consignment are fully and accurately described above by proper shipping name and are classified, packed, marked and labeled and are in all respects in proper condition for transport by highway according to applicable international and national governmental regulations.			
g. Operator's Name and Title (Print)		i. Date	
h. Signature			

\*Operator refers to the company which owns, leases, operates, controls, or supervises the facility being demolished or renovated, or the demolition or renovation operation or both



NON-HAZARDOUS SPECIAL WASTE & ASBESTOS MANIFEST

717110

Modern Landfill
4400 Mt. Pisgah Rd.
York, PA 17406
717-246-2686

If waste is asbestos waste, complete Sections I, II, III and IV
If waste is NOT asbestos waste, complete Sections I, II and III

09-03026

44528 TRL 90334 Box 6201403

I. GENERATOR (Generator completes Ia-r)

Form I: Generator information including US EPA ID Number (PAD001643691), Manifest Document Number (09-03026), Generator Name (Harley-Davidson Motor Co. Ops., Inc.), and Mailing Address (1425 Eden Road, York, PA 17402).

II. TRANSPORTER (Generator completes IIa-b and Transporter completes IIc-e)

Form II: Transporter information including Name and Address (Envirite of Pennsylvania, Inc., 730 Vogelsong Road, York, PA 17404) and Driver Name (Schmidt).

III. DESTINATION (Generator complete IIIa-c and Destination Site completes III d-g)

Form III: Destination information including Disposal Facility and Site Address (Modern Landfill, 4400 Mt. Pisgah Rd, York, PA 17406) and US EPA Number (PAD987395803).

IV. ASBESTOS (Generator completes IVa-f and Operator complete IVg-i)

Form IV: Asbestos information including Operator's Name and Address, Responsible Agency Name and Address, and Operator's Certification statement.



# NON-HAZARDOUS SPECIAL WASTE & ASBESTOS MANIFEST

9/7/10

Modern Landfill  
4400 Mt. Pisgah Rd.  
York, PA 17406  
717-246-2686

If waste is asbestos waste, complete Sections I, II, III and IV  
If waste is NOT asbestos waste, complete Sections I, II and III

09-03027

### I. GENERATOR (Generator completes Ia-r)

a. Generator's US EPA ID Number PAD001643691		b. Manifest Document Number 09-03027		c. Page 1 of 1		
d. Generator's Name and Location: Harley-Davidson Motor Co. Ops., Inc. 1425 Eden Road York, PA 17402			e. Generator's Mailing Address:  Same			
f. Phone: 717-848-1177			g. Phone:			
If owner of the generating facility differs from the generator, provide:						
h. Owner's Name:			i. Owner's Phone No.:			
j. Waste Profile #	k. Exp. Date	l. Waste Shipping Name and Description	m. Containers No.	m. Containers Type	n. Total Quantity	o. Unit Wt/Vol
10 10570	7/13/2011	Contaminated Soil-Debris	001	300Y CM	20	Y
					1210	

GENERATOR'S CERTIFICATION: I hereby certify that the above named material is not a hazardous waste as defined by 40 CFR 261 or any applicable state law, has been properly described, classified and packaged, and is in proper condition for transportation according to applicable regulations; AND, if this waste is a treatment residue of a previously restricted hazardous waste subject to the Land Disposal Restrictions. I certify and warrant that the waste has been treated in accordance with the requirements of 40 CFR 268 and is no longer a hazardous waste as defined by 40 CFR 261.

p. Generator Authorized Agent Name (Print) Sharon R Fisher		q. Signature Sharon R Fisher	r. Date 08-10-10
---	--	---------------------------------	---------------------

### II. TRANSPORTER (Generator completes IIa-b and Transporter completes IIc-e)

a. Transporter's Name and Address: Envirite of Pennsylvania, Inc. 730 Vogelsong Road York, PA 17404			8842
b. Phone: 717-846-1900			Box 274233
c. Driver Name (Print) Harold A Wood	d. Signature Harold A Wood	e. Date 08-10-10	

### III. DESTINATION (Generator complete IIIa-c and Destination Site completes IIId-g)

a. Disposal Facility and Site Address: Modern Landfill 4400 Mt. Pisgah Rd York, PA 17406	b. Phone: 717-246-2686	c. US EPA Number PAD987395803	d. Discrepancy Indication Space:
--	------------------------	----------------------------------	----------------------------------

I hereby certify that the above named material has been accepted and to the best of my knowledge the foregoing is true and accurate.

e. Name of Authorized Agent (Print)	f. Signature U	g. Date 8/10/10
-------------------------------------	-------------------	--------------------

### IV. ASBESTOS (Generator completes IVa-f and Operator complete IVg-i)

a. Operator's Name and Address:	c. Responsible Agency Name and Address:
b. Phone:	d. Phone:
e. Special Handling Instructions and Additional Information:	

f.  Friable  Non-Friable  Both % Friable % Non-Friable

OPERATOR'S CERTIFICATION: I hereby declare that the contents of this consignment are fully and accurately described above by proper shipping name and are classified, packed, marked and labeled and are in all respects in proper condition for transport by highway according to applicable international and national governmental regulations.

g. Operator's Name and Title (Print)	h. Signature	i. Date
--------------------------------------	--------------	---------

\*Operator refers to the company which owns, leases, operates, controls, or supervises the facility being demolished or renovated, or the demolition or renovation operation or both





NON-HAZARDOUS SPECIAL WASTE & ASBESTOS MANIFEST

7/7/10

Modern Landfill
4400 Mt. Pisgah Rd.
York, PA 17406
717-246-2686

If waste is asbestos waste, complete Sections I, II, III and IV
If waste is NOT asbestos waste, complete Sections I, II and III

09-03028

TRK # 8006, TPL # 9003

Box # 20029

I. GENERATOR (Generator completes Ia-r)

Form I: Generator information including EPA ID Number, Manifest Document Number, Generator Name and Location, Mailing Address, Phone, and Waste Profile details.

GENERATOR'S CERTIFICATION: I hereby certify that the above named material is not a hazardous waste as defined by 40 CFR 261 or any applicable state law, has been properly described, classified and packaged, and is in proper condition for transportation according to applicable regulations; AND, if this waste is a treatment residue of a previously restricted hazardous waste subject to the Land Disposal Restrictions. I certify and warrant that the waste has been treated in accordance with the requirements of 40 CFR 268 and is no longer a hazardous waste as defined by 40 CFR 261.

Form I continued: Generator Authorized Agent Name (Print), Signature, and Date.

II. TRANSPORTER (Generator completes IIa-b and Transporter completes IIc-e)

Form II: Transporter information including Name and Address, Phone, Driver Name (Print), Signature, and Date.

III. DESTINATION (Generator complete IIIa-c and Destination Site completes IIId-g)

Form III: Destination information including Disposal Facility and Site Address, US EPA Number, Discrepancy Indication Space, Name of Authorized Agent (Print), Signature, and Date.

IV. ASBESTOS (Generator completes IVa-f and Operator complete IVg-i)

Form IV: Asbestos information including Operator's Name and Address, Responsible Agency Name and Address, Special Handling Instructions, Friable/Non-Friable status, OPERATOR'S CERTIFICATION, and Operator's Name and Title (Print), Signature, and Date.



# NON-HAZARDOUS SPECIAL WASTE & ASBESTOS MANIFEST

4/7/10

Modern Landfill  
4400 Mt. Pisgah Rd.  
York, PA 17406  
717-246-2686

If waste is asbestos waste, complete Sections I, II, III and IV  
If waste is NOT asbestos waste, complete Sections I, II and III

09-03029

TEL 441525 TRC 90444 Cont 606640

## I. GENERATOR (Generator completes Ia-r)

a. Generator's US EPA ID Number PAD001643691		b. Manifest Document Number 09-03039		c. Page 1 of 1		
d. Generator's Name and Location: Harley-Davidson Motor Co. Ops., Inc. 1425 Eden Road York, PA 17402			e. Generator's Mailing Address: Same			
f. Phone: 717-846-1177			g. Phone:			
If owner of the generating facility differs from the generator, provide:			i. Owner's Phone No.:			
h. Owner's Name:			i. Owner's Phone No.:			
j. Waste Profile #	k. Exp. Date	l. Waste Shipping Name and Description	m. Containers No.	m. Containers Type	n. Total Quantity	o. Unit Wt/Vol
10 10670	7/13/2011	Contaminated Soil-Debris	001	30CY	1623	
GENERATOR'S CERTIFICATION: I hereby certify that the above named material is not a hazardous waste as defined by 40 CFR 261 or any applicable state law, has been properly described, classified and packaged, and is in proper condition for transportation according to applicable regulations; AND, if this waste is a treatment residue of a previously restricted hazardous waste subject to the Land Disposal Restrictions. I certify and warrant that the waste has been treated in accordance with the requirements of 40 CFR 268 and is no longer a hazardous waste as defined by 40 CFR 261.						
p. Generator Authorized Agent Name (Print) Sheron R Fisher			q. Signature <i>Sheron R Fisher</i>		r. Date 08-10-10	

## II. TRANSPORTER (Generator completes IIa-b and Transporter completes IIc-e)

a. Transporter's Name and Address: Envirite of Pennsylvania, Inc. 730 Vogelsong Road York, PA 17404		
b. Phone: 717-846-1900		
c. Driver Name (Print) Schachel	d. Signature <i>Schachel</i>	e. Date 8-10-10

## III. DESTINATION (Generator complete IIIa-c and Destination Site completes III d-g)

a. Disposal Facility and Site Address: Modern Landfill 4400 Mt. Pisgah Rd York, PA 17406		c. US EPA Number PAD987395603	d. Discrepancy Indication Space:
b. Phone: 717-246-2686			
I hereby certify that the above named material has been accepted and to the best of my knowledge, the foregoing is true and accurate.			
e. Name of Authorized Agent (Print)	f. Signature <i>JD</i>	g. Date 8/10/10	

## IV. ASBESTOS (Generator completes IVa-f and Operator complete IVg-i)

a. Operator's Name and Address:		c. Responsible Agency Name and Address:	
b. Phone:		d. Phone:	
e. Special Handling Instructions and Additional Information:			
f. <input type="checkbox"/> Friable <input type="checkbox"/> Non-Friable <input type="checkbox"/> Both % Friable % Non-Friable			
OPERATOR'S CERTIFICATION: I hereby declare that the contents of this consignment are fully and accurately described above by proper shipping name and are classified, packed, marked and labeled and are in all respects in proper condition for transport by highway according to applicable international and national governmental regulations.			
g. Operator's Name and Title (Print)		i. Date	
h. Signature			
*Operator refers to the company which owns, leases, operates, controls, or supervises the facility being demolished or renovated, or the demolition or renovation operation or both			



NON-HAZARDOUS SPECIAL WASTE & ASBESTOS MANIFEST

9/17/10

Modern Landfill  
4400 Mt. Pisgah Rd.  
York, PA 17406  
717-246-2686

TRK 441525 TEL 90444  
If waste is asbestos waste, complete Sections I, II, III and IV  
If waste is NOT asbestos waste, complete Sections I, II and III

09-03030

Cont W57592

I. GENERATOR (Generator completes Ia-r)

a. Generator's US EPA ID Number PAD001643691		b. Manifest Document Number 09-03030		c. Page 1 of 1		
d. Generator's Name and Location: Harley-Davidson Motor Co. Ops., Inc. 1425 Eden Road York, PA 17402 f. Phone: 717-848-1177			e. Generator's Mailing Address:  Same g. Phone:			
h. Owner's Name:			i. Owner's Phone No.:			
If owner of the generating facility differs from the generator, provide:						
j. Waste Profile #	k. Exp. Date	l. Waste Shipping Name and Description	m. Containers No.	m. Containers Type	n. Total Quantity	o. Unit Wt/Vol
10 10670	7/13/2011	Contaminated Soil-Debris	001	30CY		
field # 85407		15.33 ton				
GENERATOR'S CERTIFICATION: I hereby certify that the above named material is not a hazardous waste as defined by 40 CFR 261 or any applicable state law, has been properly described, classified and packaged, and is in proper condition for transportation according to applicable regulations; AND, if this waste is a treatment residue of a previously restricted hazardous waste subject to the Land Disposal Restrictions. I certify and warrant that the waste has been treated in accordance with the requirements of 40 CFR 268 and is no longer a hazardous waste as defined by 40 CFR 261.						
p. Generator Authorized Agent Name (Print) Sharon R Fisher		q. Signature Sharon R Fisher		r. Date 09-10-10		

II. TRANSPORTER (Generator completes IIa-b and Transporter completes IIc-e)

a. Transporter's Name and Address: Envirite of Pennsylvania, Inc. 730 Vogelsong Road York, PA 17404 b. Phone: 717-846-1900		
c. Driver Name (Print) Schachtel	d. Signature [Signature]	e. Date 8-10-10

III. DESTINATION (Generator complete IIIa-c and Destination Site completes III d-g)

a. Disposal Facility and Site Address: Modern Landfill 4400 Mt. Pisgah Rd York, PA 17406 b. Phone: 717-246-2686		c. US EPA Number PAD987395803	d. Discrepancy Indication Space:
I hereby certify that the above named material has been accepted and to the best of my knowledge the foregoing is true and accurate.			
e. Name of Authorized Agent (Print)	f. Signature	g. Date	

IV. ASBESTOS (Generator completes IVa-f and Operator complete IVg-i)

a. Operator's Name and Address:		c. Responsible Agency Name and Address:	
b. Phone:		d. Phone:	
e. Special Handling Instructions and Additional Information:			
f. <input type="checkbox"/> Friable <input type="checkbox"/> Non-Friable <input type="checkbox"/> Both % Friable % Non-Friable			
OPERATOR'S CERTIFICATION: I hereby declare that the contents of this consignment are fully and accurately described above by proper shipping name and are classified, packed, marked and labeled and are in all respects in proper condition for transport by highway according to applicable international and national governmental regulations.			
g. Operator's Name and Title (Print)		h. Signature	
		i. Date	
*Operator refers to the company which owns, leases, operates, controls, or supervises the facility being demolished or renovated, or the demolition or renovation operation or both			



NON-HAZARDOUS SPECIAL WASTE & ASBESTOS MANIFEST

9/7/10

8074

Modern Landfill
4400 Mt. Pisgah Rd.
York, PA 17406
717-246-2686

If waste is asbestos waste, complete Sections I, II, III and IV
If waste is NOT asbestos waste, complete Sections I, II and III

09-03031

Box # 6072

I. GENERATOR (Generator completes Ia-r)

Form I: Generator information including EPA ID, manifest number, name, location, and waste profile details.

GENERATOR'S CERTIFICATION: I hereby certify that the above named material is not a hazardous waste as defined by 40 CFR 261...

Form I continued: Authorized agent name, signature, and date.

II. TRANSPORTER (Generator completes IIa-b and Transporter completes IIc-e)

Form II: Transporter information including name, address, driver name, and signature.

III. DESTINATION (Generator complete IIIa-c and Destination Site completes III d-g)

Form III: Destination information including facility address, EPA number, and agent details.

IV. ASBESTOS (Generator completes IVa-f and Operator complete IVg-i)

Form IV: Asbestos handling information including operator name, agency name, and certification.



Modern Landfill  
4400 Mt. Pisgah Rd.  
York, PA 17406  
717-246-2686

# NON-HAZARDOUS SPECIAL WASTE & ASBESTOS MANIFEST

If waste is asbestos waste, complete Sections I, II, III and IV  
If waste is **NOT** asbestos waste, complete Sections I, II and III

09-03032

Condit  
670442

TRK 441525 TEL 90444

## I. GENERATOR (Generator completes Ia-r)

a. Generator's US EPA ID Number PAD001643691		b. Manifest Document Number 09-03032		c. Page 1 of 1	
d. Generator's Name and Location: Harley-Davidson Motor Co. Ops., Inc. 1425 Eden Road York, PA 17402			e. Generator's Mailing Address: Same		
f. Phone: 717-848-1177			g. Phone:		
If owner of the generating facility differs from the generator, provide:					
h. Owner's Name:			i. Owner's Phone No.:		
j. Waste Profile #	k. Exp. Date	l. Waste Shipping Name and Description	m. Containers No. Type		n. Total Quantity
10 10670	7/13/2011	Contaminated Soil-Debris	001	30CY	14/14

GENERATOR'S CERTIFICATION: I hereby certify that the above named material is not a hazardous waste as defined by 40 CFR 261 or any applicable state law, has been properly described, classified and packaged, and is in proper condition for transportation according to applicable regulations; AND, if this waste is a treatment residue of a previously restricted hazardous waste subject to the Land Disposal Restrictions. I certify and warrant that the waste has been treated in accordance with the requirements of 40 CFR 268 and is no longer a hazardous waste as defined by 40 CFR 261.

Sharon R Fisher		Sharon R Fisher		08-10-10	
p. Generator Authorized Agent Name (Print)		q. Signature		r. Date	

## II. TRANSPORTER (Generator completes IIa-b and Transporter completes IIc-e)

a. Transporter's Name and Address: Envirite of Pennsylvania, Inc. 730 Vogelsong Road York, PA 17404		
b. Phone: 717-846-1980		
Schahel		08-10-10
c. Driver Name (Print)		e. Date
d. Signature		

## III. DESTINATION (Generator complete IIIa-c and Destination Site completes III d-g)

a. Disposal Facility and Site Address: Modern Landfill 4400 Mt. Pisgah Rd York, PA 17406		b. Phone: 717-246-2686	c. US EPA Number PAD987395803	d. Discrepancy Indication Space:
I hereby certify that the above named material has been accepted and to the best of my knowledge the foregoing is true and accurate.				
e. Name of Authorized Agent (Print)		f. Signature		g. Date

## IV. ASBESTOS (Generator completes IVa-f and Operator complete IVg-i)

a. Operator's Name and Address:		c. Responsible Agency Name and Address:		
b. Phone:		d. Phone:		
e. Special Handling Instructions and Additional Information:				
f. <input type="checkbox"/> Friable <input type="checkbox"/> Non-Friable <input type="checkbox"/> Both % Friable % Non-Friable				
OPERATOR'S CERTIFICATION: I hereby declare that the contents of this consignment are fully and accurately described above by proper shipping name and are classified, packed, marked and labeled and are in all respects in proper condition for transport by highway according to applicable international and national governmental regulations.				
g. Operator's Name and Title (Print)		h. Signature		i. Date
*Operator refers to the company which owns, leases, operates, controls, or supervises the facility being demolished or renovated, or the demolition or renovation operation or both				